

INSTALLATION INSTRUCTIONS: 2009-2014 F150 RAIL CAPS

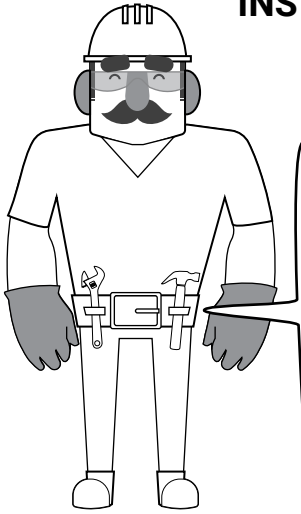

TOOLS NEEDED:

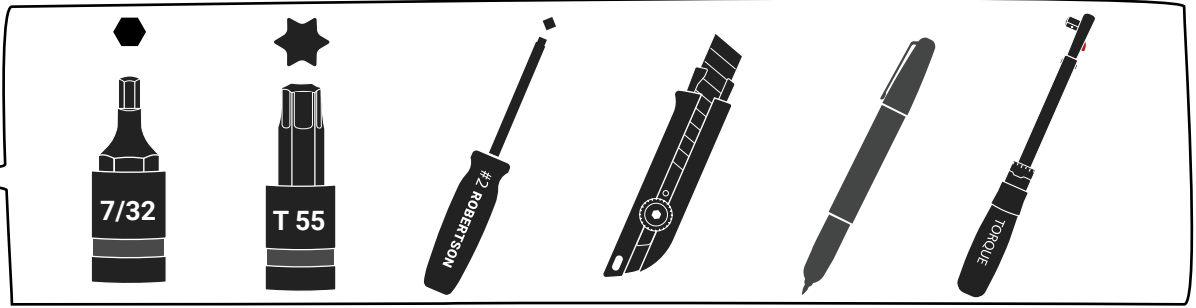

CAUTION:

This equipment is designed to be professionally installed by an approved up-fitter. Always wear ear and eye protection and exercise caution when installing Westcan products.

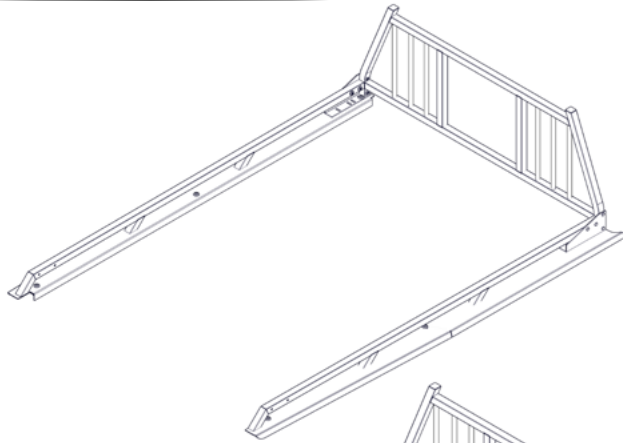

LONG BOX

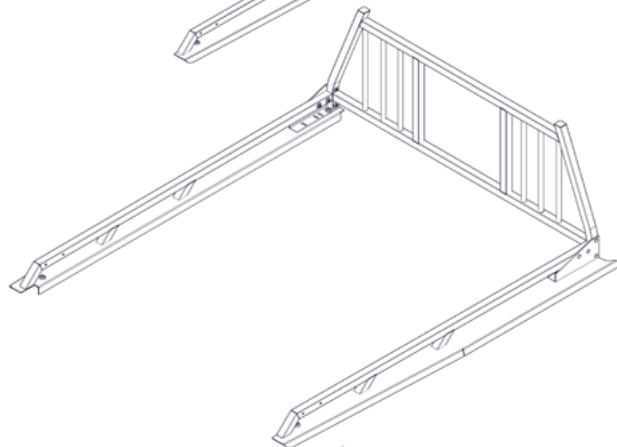

SHORT BOX

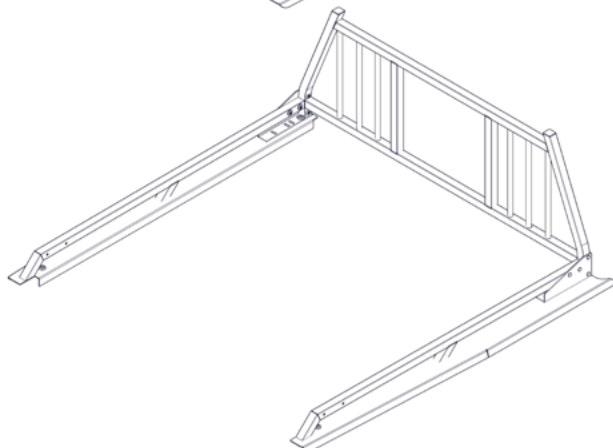

**EXTRA SHORT
BOX**

PREPARATION:

1. Ensure all parts are present and accounted for before installation. **Begin the installation of your cabguard before your rail caps.** Plan the location of your installation ahead of time and make sure your installation location does not impede any other components you are installing or damage the safety and functionality of your vehicle.
2. Exercise extreme diligence when drilling holes into a motor vehicle. Increasing complexity and model year changes can alter the location of fuel, hydraulic and electrical lines. Please visually inspect all locations prior to drilling.
3. Re-Torque the 3/8" x 1-3/4" Stainless Steel Countersink Bolt every 3 month.

BOX CAP PREPARATION:

Some truck box lengths require the plastic truck box caps to be cut to expose the stake pocket cutout. Use the provided cardboard template as a guide for cutting the box cap. Exercise caution when cutting caps to avoid injury.

NOTE:

WHEN THE HOLD ICON IS USED TO TURN A FASTENER, TIGHTEN THEM FINGER TIGHT.

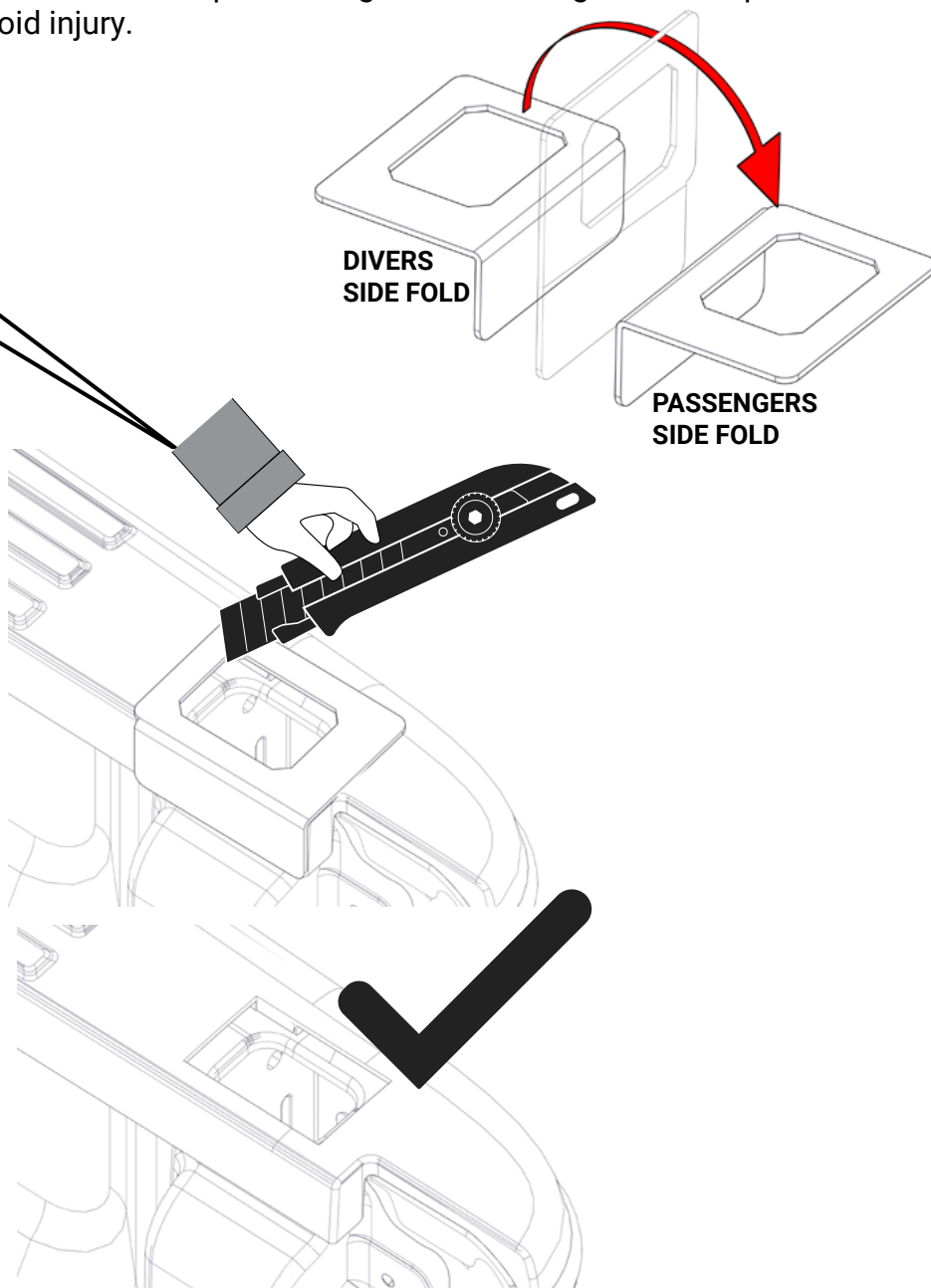

1

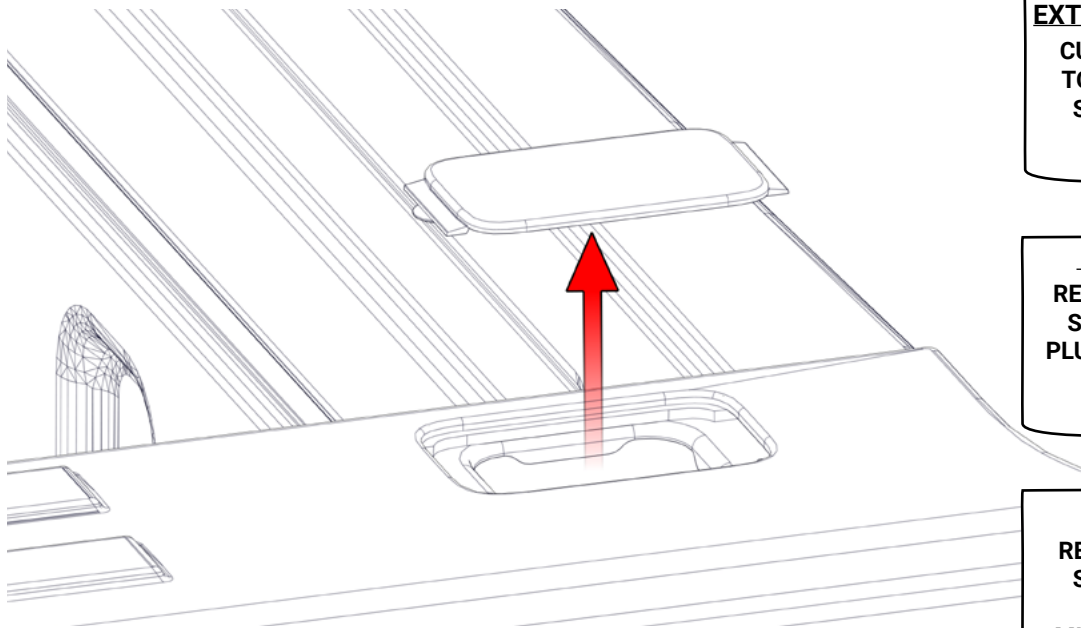

EXTRA SHORT BOX
CUT PLASTIC CAP
TO EXPOSE REAR
STAKE POCKET

SHORT BOX
REMOVE PLASTIC
STAKE POCKET
PLUGS FROM REAR
POSITION.

LONG BOX
REMOVE PLASTIC
STAKE POCKET
PLUGS FROM
MIDDLE AND REAR
POSITION.

2

EXTRA SHORT BOX AND SHORT BOX

3/8 X 1 3/4 Stainless Steel Counter Sink Bolt

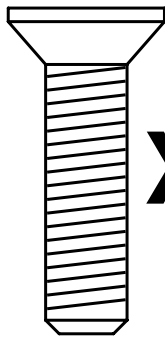

X 2

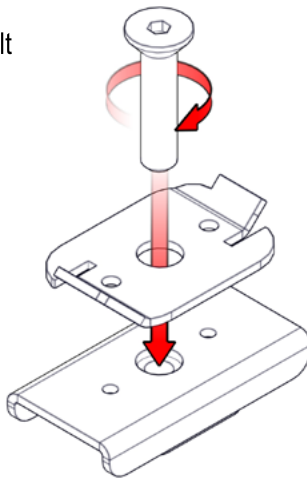

X 2

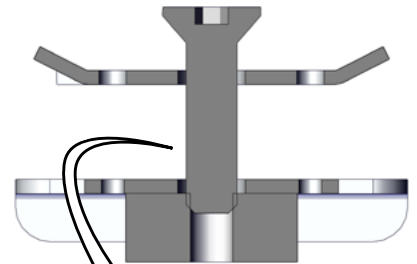

**THIS GAP IS
REQUIRED FOR
INSTALLATION**

LONG BOX

3/8 X 1 3/4 Stainless Steel Counter Sink Bolt

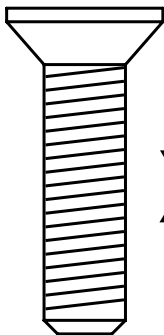

X 4

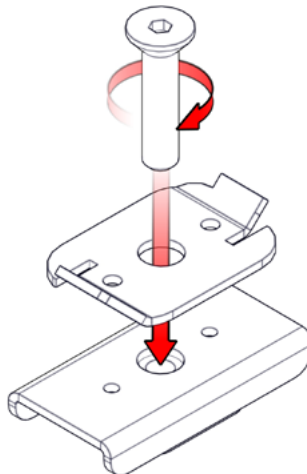

X 4

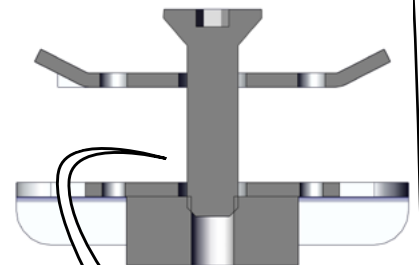

**THIS GAP IS
REQUIRED FOR
INSTALLATION**

3.

**REQUIRED FOR EXTRA SHORT AND
SHORT BOX**

#10 - 1" Plated Zinc Robertson Powerhead Drill Tip Screw

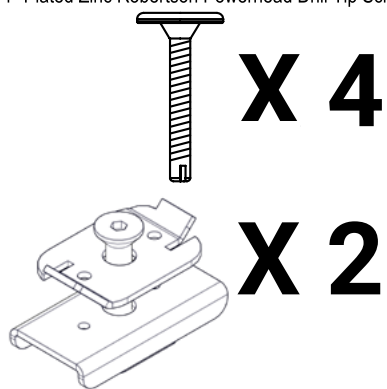

REQUIRED FOR LONG BOX

#10 - 1" Plated Zinc Robertson Powerhead Drill Tip Screw

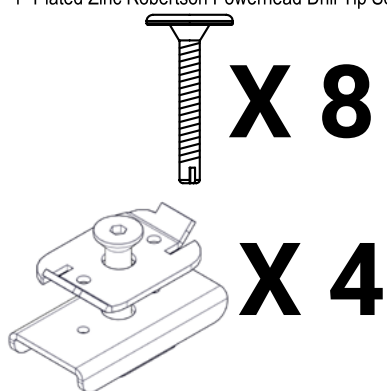

3.1

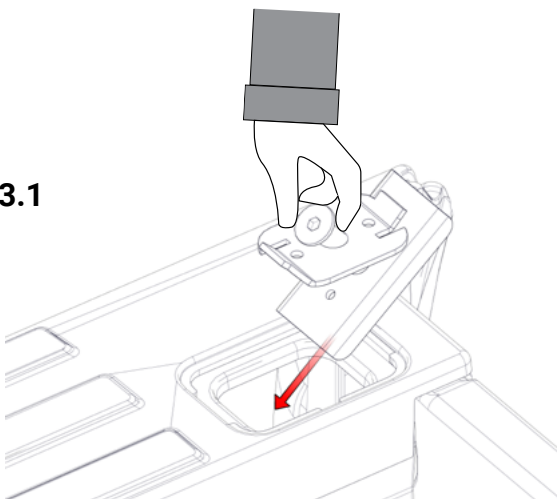

3.2

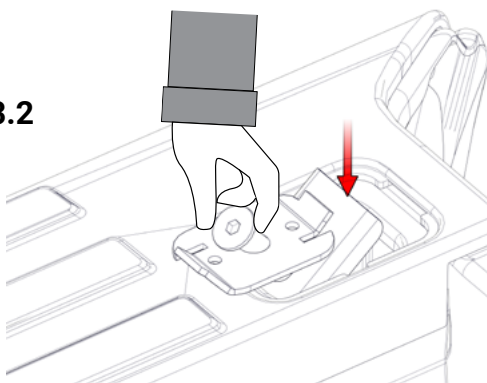

3.3

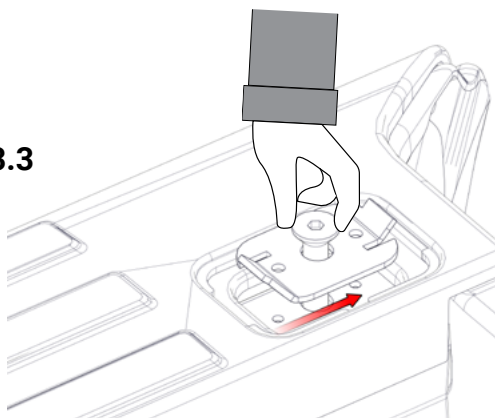

3.4

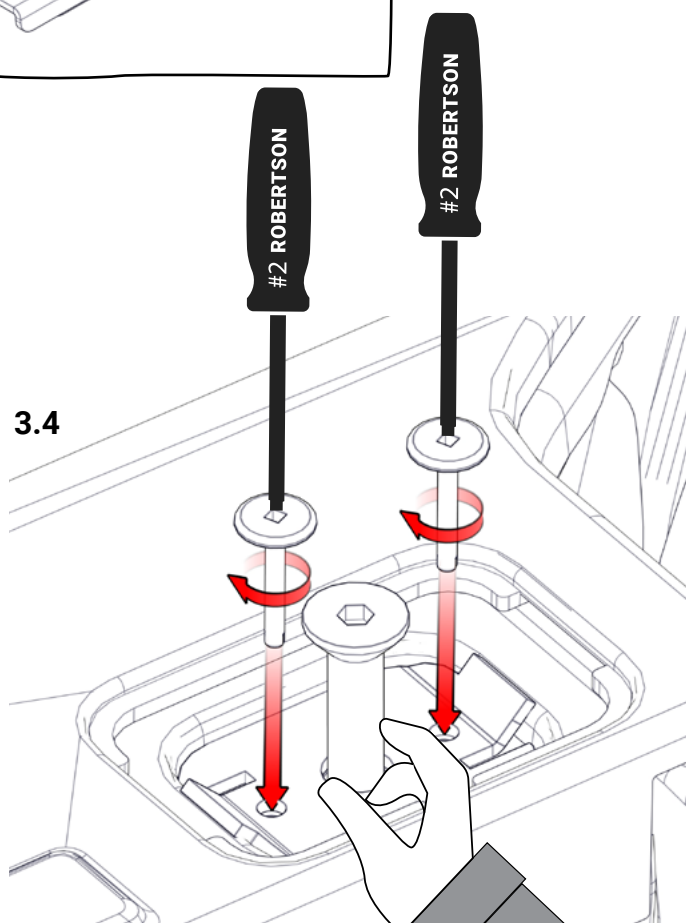

3.5

REMOVE
COUNER SINK
BOLT AND RETAIN
FOR STEP 4-5

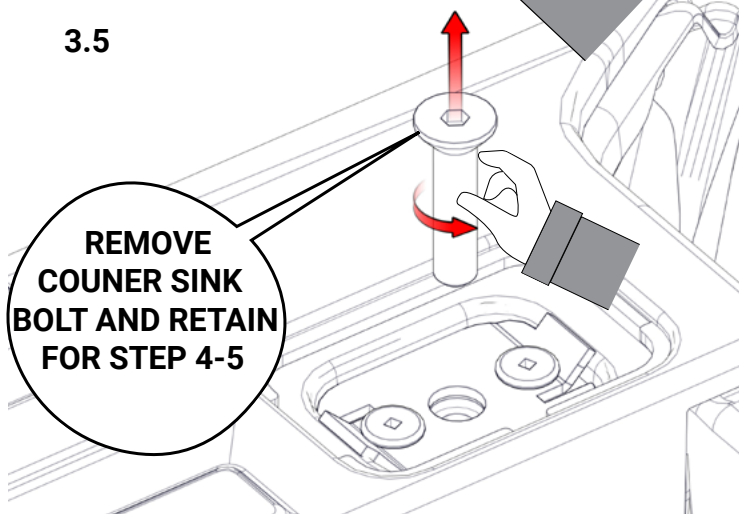

4.

LONG BOX

3/8 X 1 3/4 Stainless Steel Counter Sink Bolt

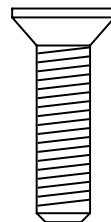

X 4

3/8" Stainless Steel Finishing Washer

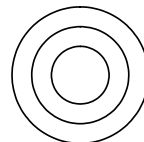

X 4

Anti-Sieze Lubricant

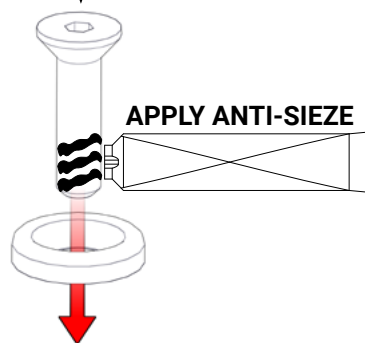
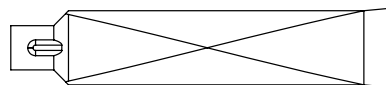

APPLY ANTI-SIEZE

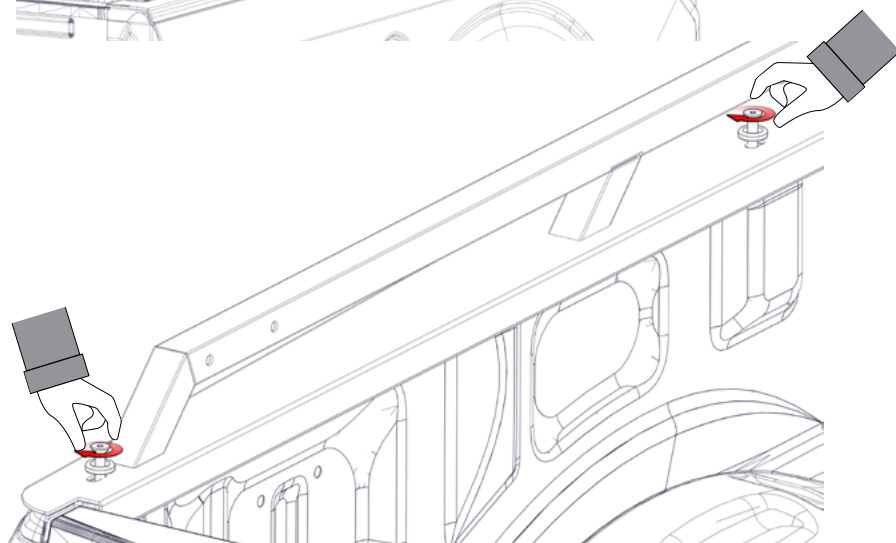
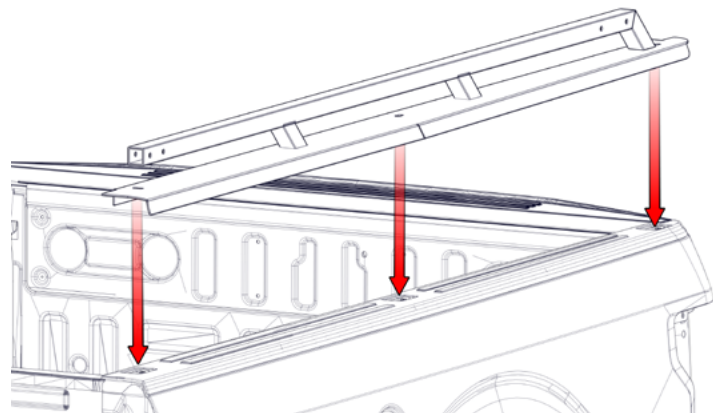

**=90 IN-LBF
=7.5 FT-LBF**

**IF INSTALLING WITH A CABGUARD,
TORQUE DOWN WHEN THE CABGUARD
INSTALL IS COMPLETE.**

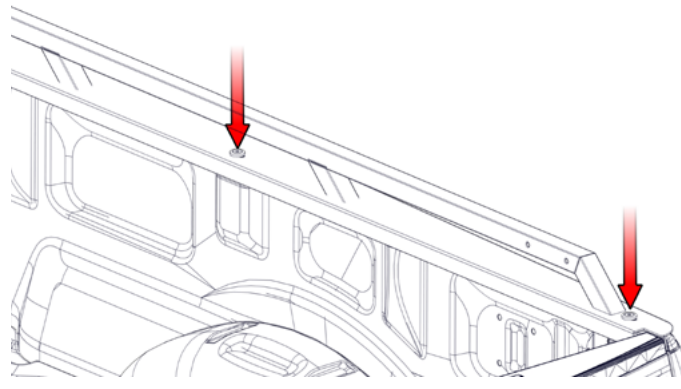
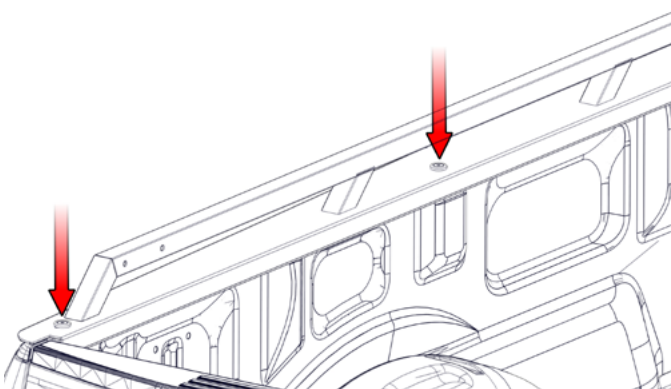

5.

EXTRA SHORT BOX AND SHORT BOX

3/8 X 1 3/4 Stainless Steel Counter Sink Bolt

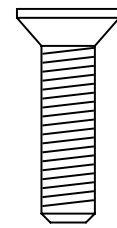
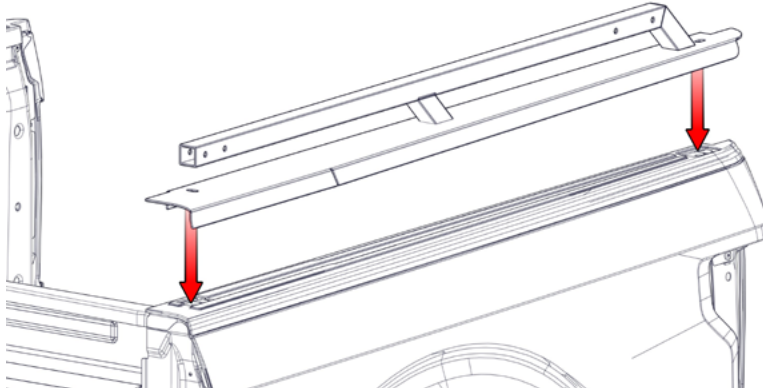

X 2

3/8" Stainless Steel Finishing Washer

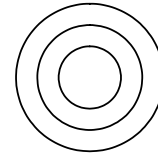

X 2

Anti-Sieze Lubricant

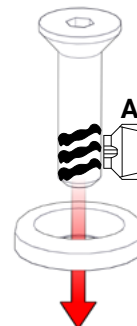
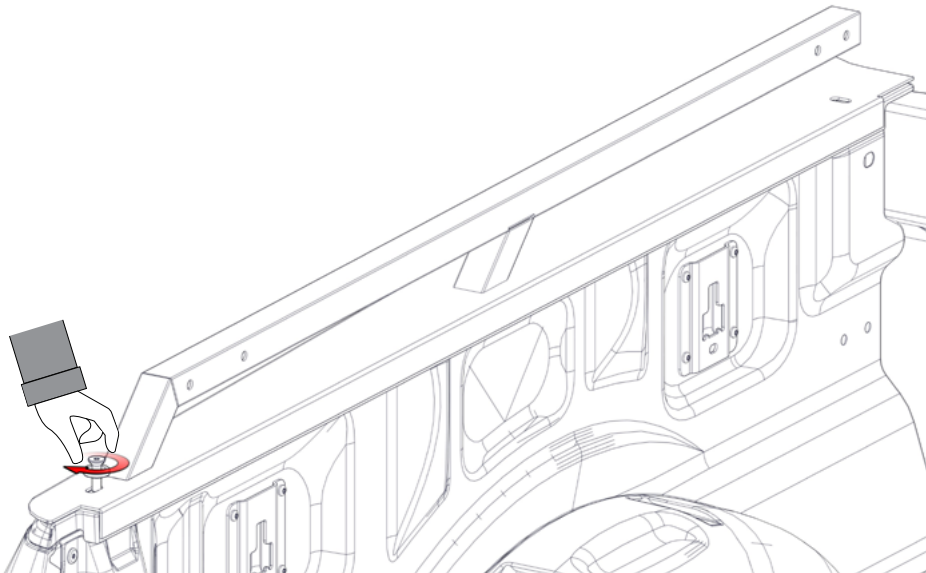
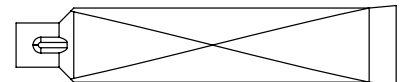

APPLY ANTI-SIEZE

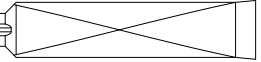

**=90 IN-LBF
=7.5 FT-LBF**

**IF INSTALLING WITH A CABGUARD,
TORQUE DOWN WHEN THE CABGUARD
INSTALL IS COMPLETE.**

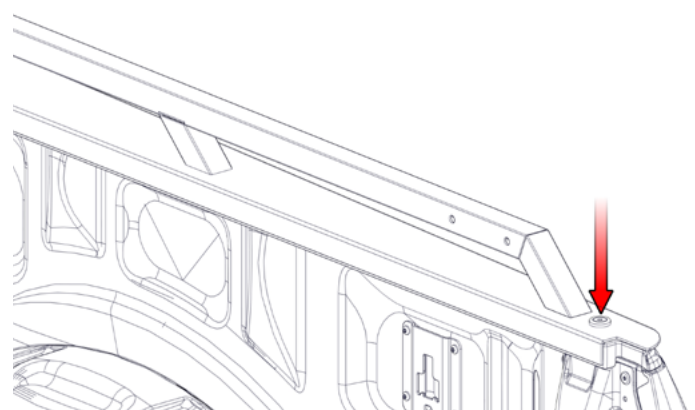
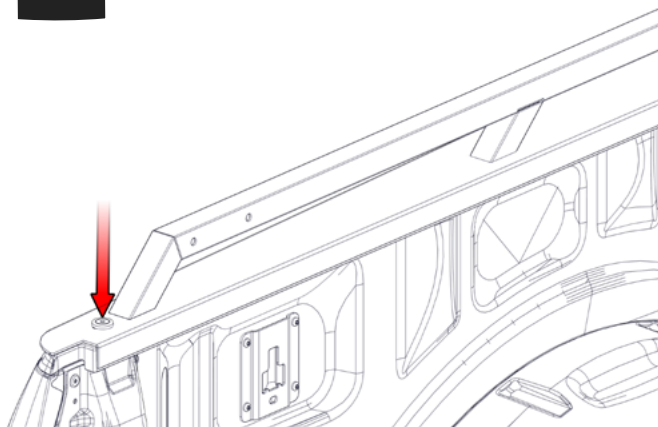

PRINT AT A 1:1 SCALE AND CUT OUT. FOLD ALONG THE DOTTED LINE

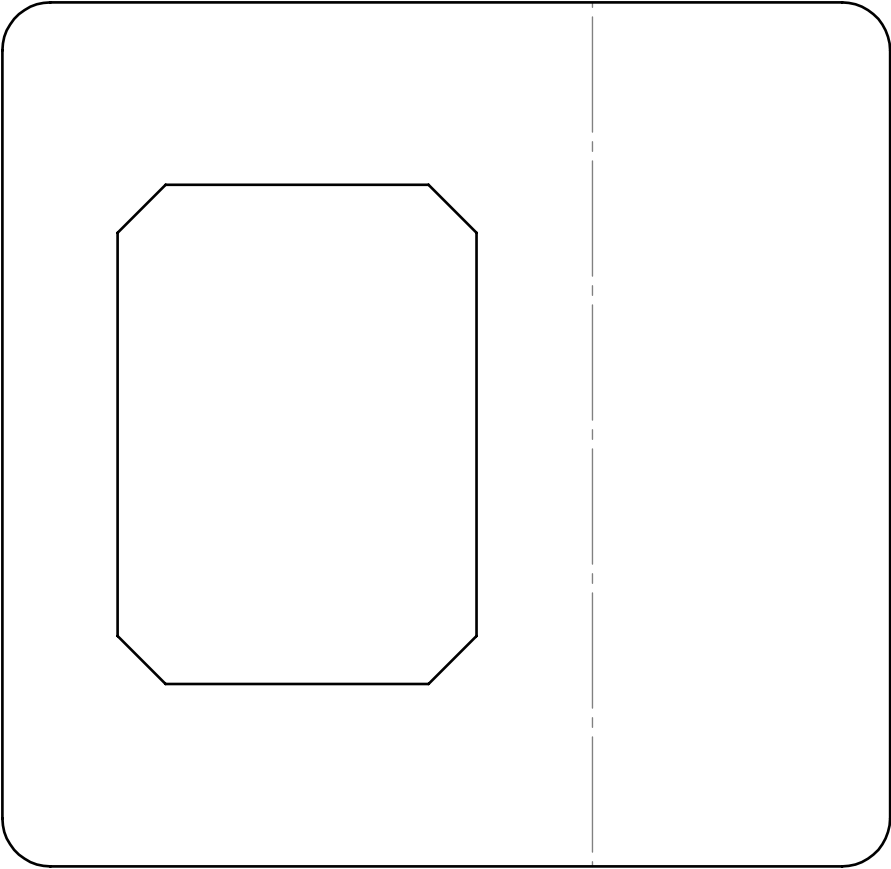

WESTCAN

MANUFACTURING LTD.

DESCRIPTION:F-150 Rear Stake Pocket Cutout Template.

UNLESS OTHERWISE SPECIFIED, DIMENSIONS ARE IN INCHES				Rev:	
TOLERANCE				DRAWN BY: Dtocher	
ANG.	FRAC.	.XX	.XXX	MATERIAL:	
± 0.5"	1/32"	±0.01"	±0.005"	PART NR:	
DATE: 14/05/18				Sheet 1 OF 1	

PROPRIETARY AND CONFIDENTIAL
THE INFORMATION CONTAINED IN THIS DRAWING IS THE SOLE PROPERTY OF WESTCAN MANUFACTURING LTD. ANY REPRODUCTION IN PART OR AS A WHOLE WITHOUT THE WRITTEN PERMISSION OF WESTCAN MANUFACTURING LTD IS PROHIBITED.