

## INSTALLATION INSTRUCTIONS: 2014+ TUNDRA CAB GUARD

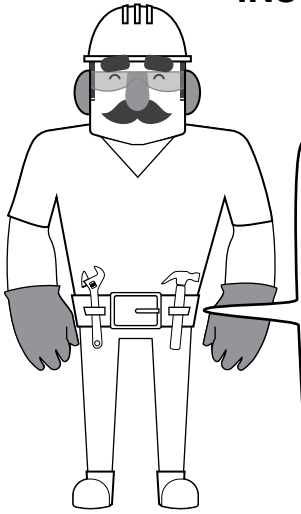

### TOOLS NEEDED:

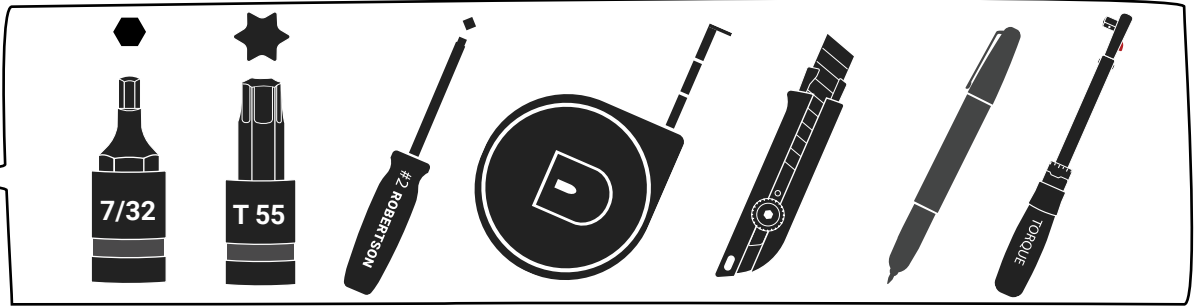

### CAUTION:

This equipment is designed to be professionally installed by an approved up-fitter. Always wear ear and eye protection and exercise caution when installing Westcan products.

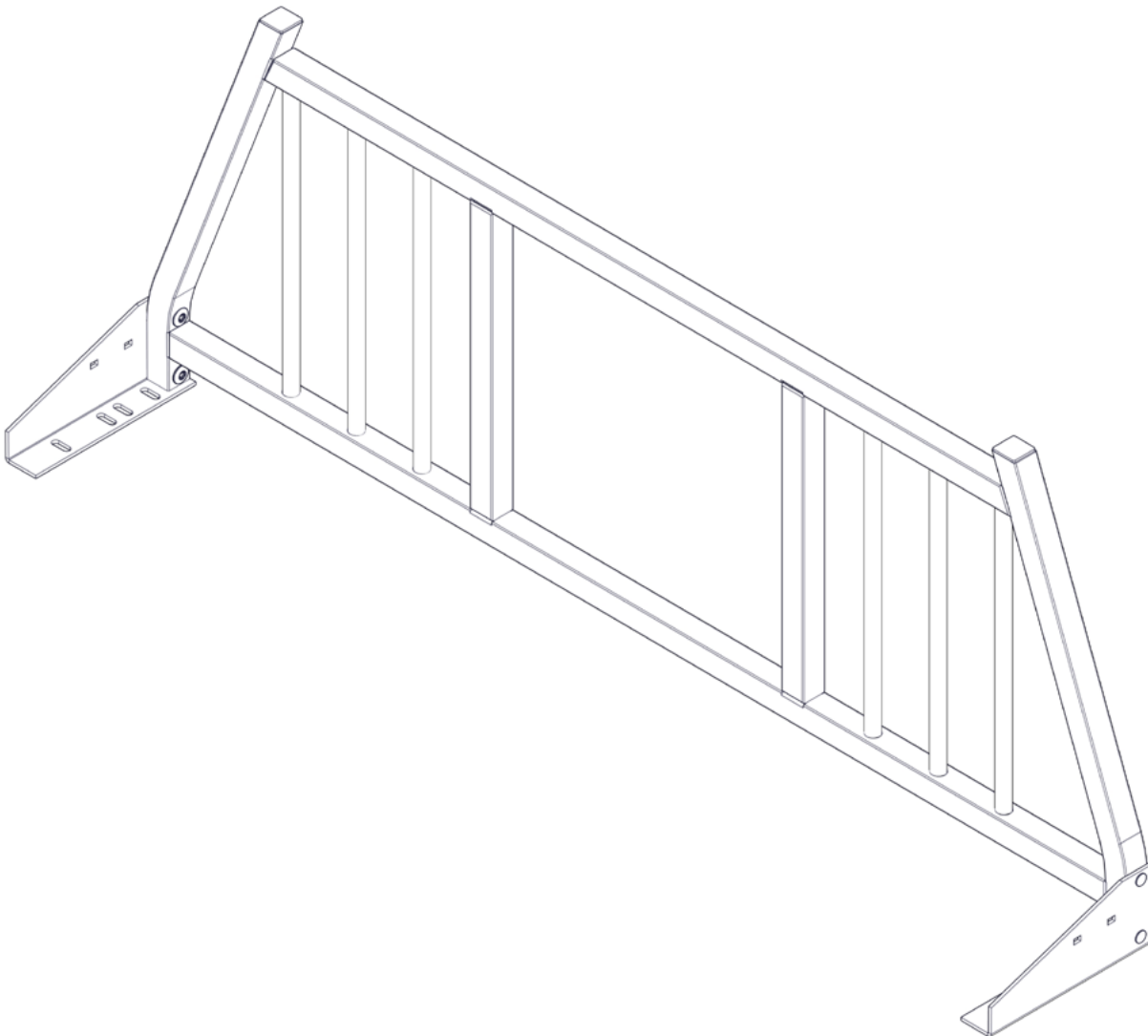

## PREPARATION:

1. Ensure all parts are present and accounted for before installation. **Begin the installation of your cabguard before your rail caps.** Plan the location of your installation ahead of time and make sure your installation location does not impede any other components you are installing or damage the safety and functionality of your vehicle.
2. Exercise extreme diligence when drilling holes into a motor vehicle. Increasing complexity and model year changes can alter the location of fuel, hydraulic and electrical lines. Please visually inspect all locations prior to drilling.
3. Re-Torque the 3/8" x 1-3/4" Stainless Steel Countersink Bolt every 3 month.

## BOX CAP PREPARATION:

Some truck box lengths require the plastic truck box caps to be cut to expose the stake pocket cutout. Use the cutout outline on the box cap as a cutting guide template guide to cut the box cap. Exercise caution when cutting caps to avoid injury.

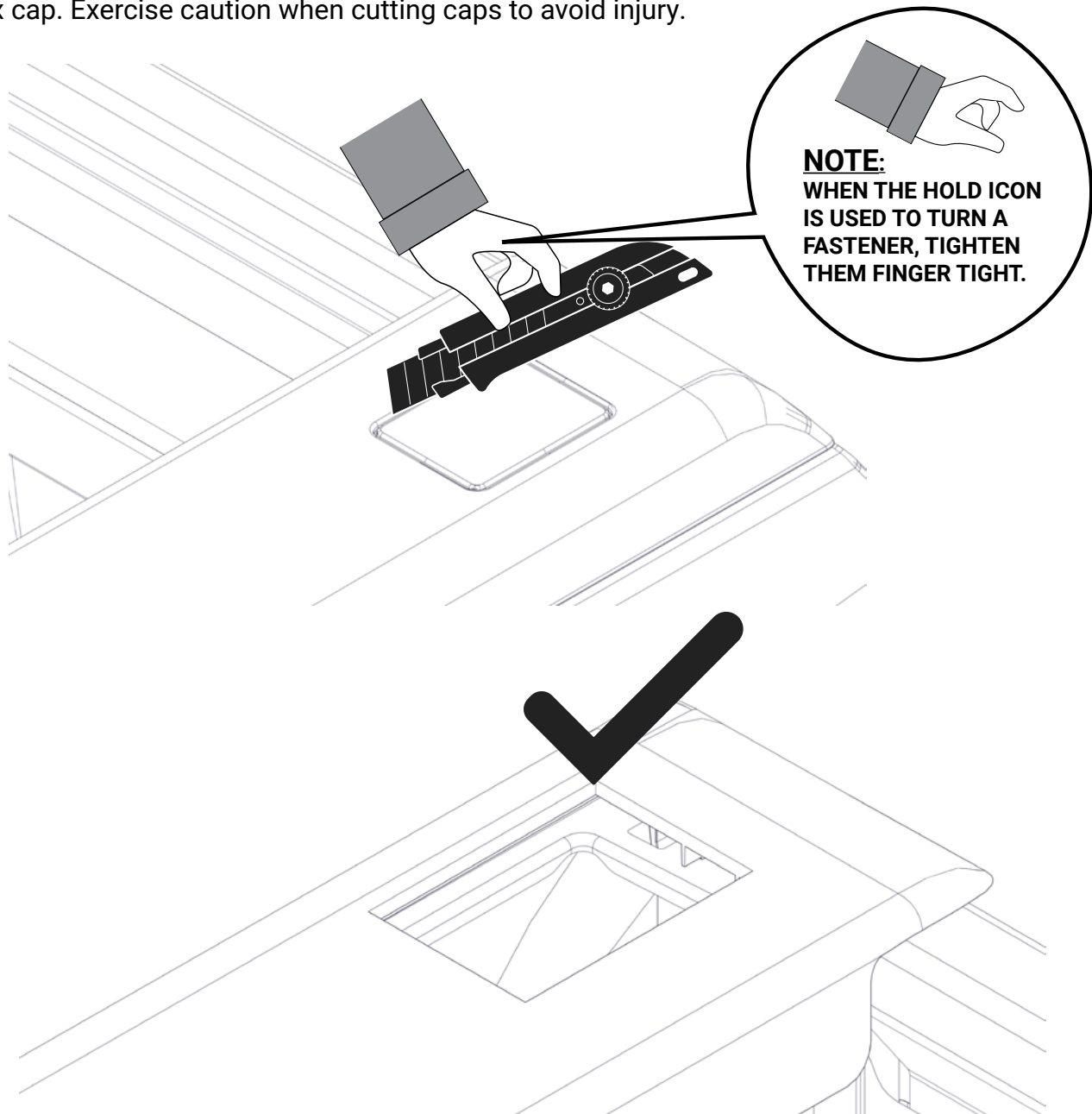

1

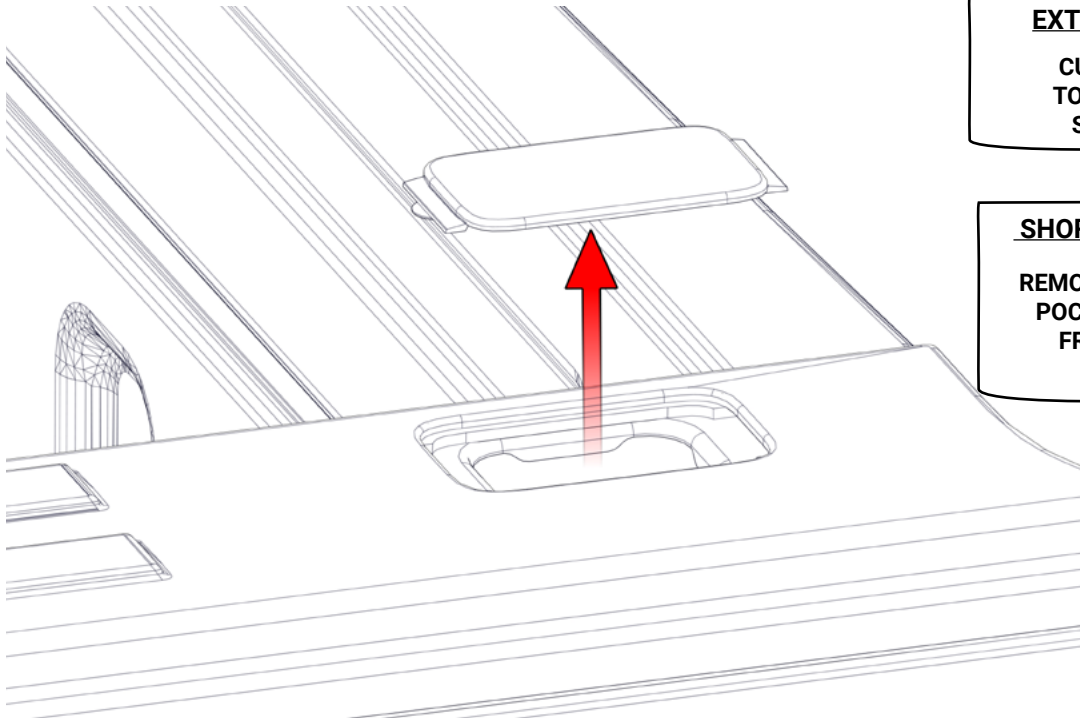

**EXTRA SHORT BOX**

CUT PLASTIC CAP  
TO EXPOSE FRONT  
STAKE POCKET

**SHORT AND LONG BOX**

REMOVE PLASTIC STAKE  
POCKET PLUGS FROM  
FRONT POSITION.

2

3/8 X 1 3/4 Stainless Steel Counter Sink Bolt

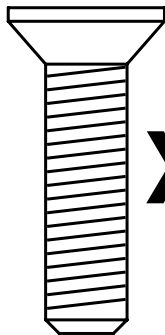

**X 2**

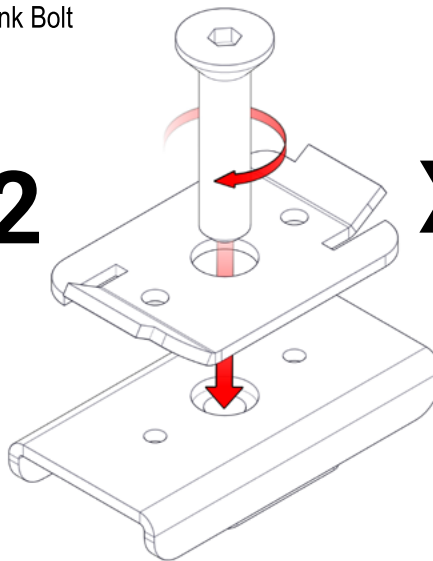

**X 2**

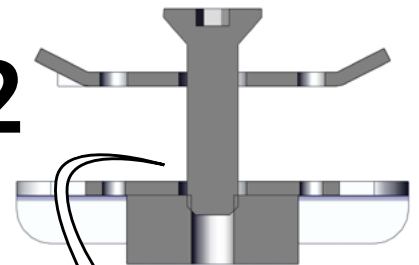

**THIS GAP IS  
REQUIRED FOR  
INSTALLATION**

3.

#10 - 1" Plated Zinc Robertson Powerhead Drill Tip Screw

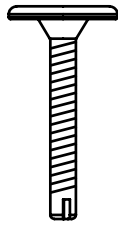

**X 4**

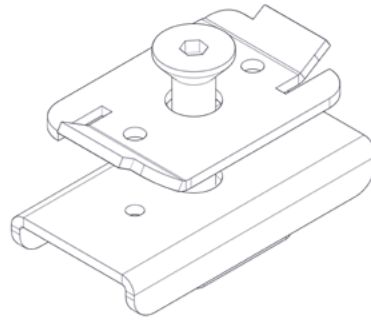

**X 2**

3.1

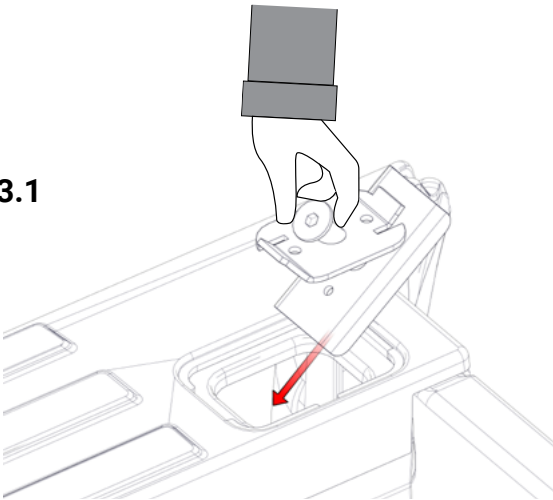

3.2

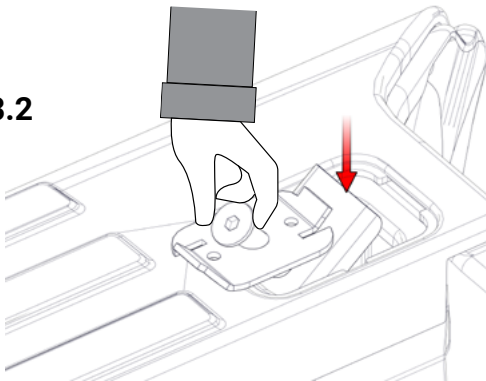

3.3

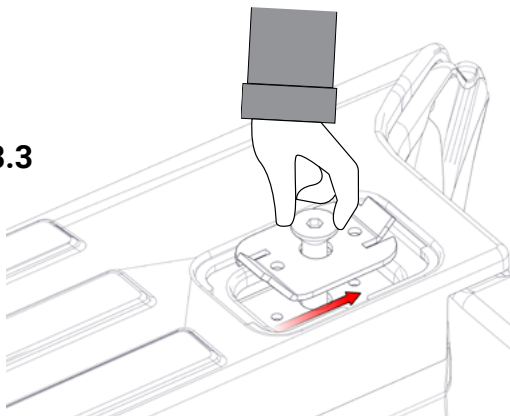

3.4

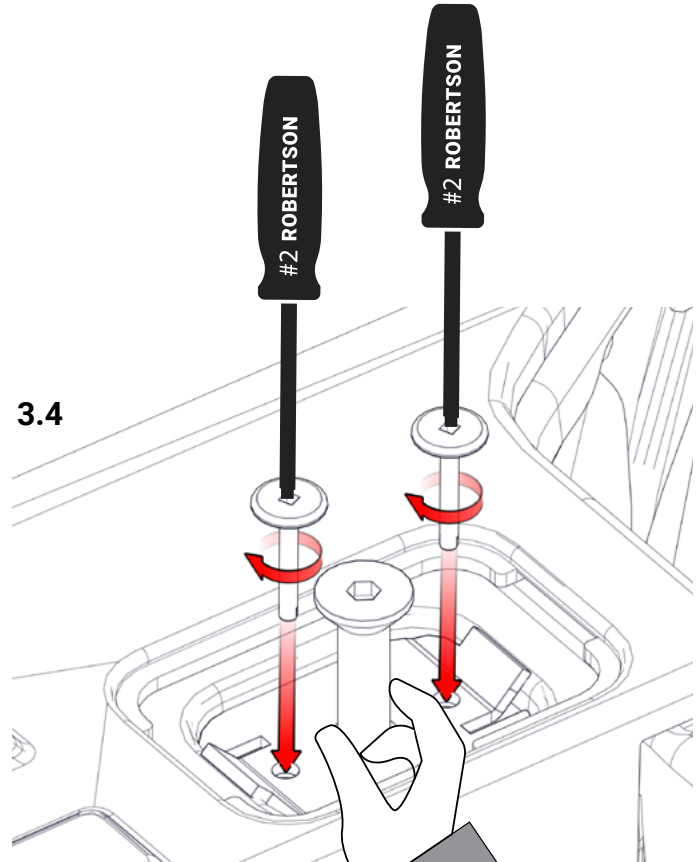

3.5

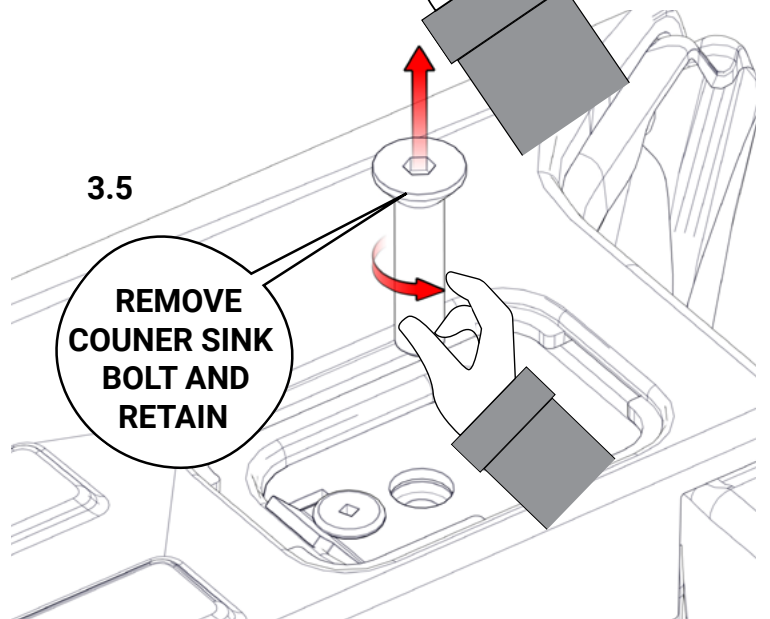

**IF REQUIRED, INSTALL YOUR RAILCAPS PRIOR TO PROCEEDING WITH STEP 4 OR GO TO STEP 13 FOR INSTALLATIONS WITHOUT RAILCAPS.**

**4.**

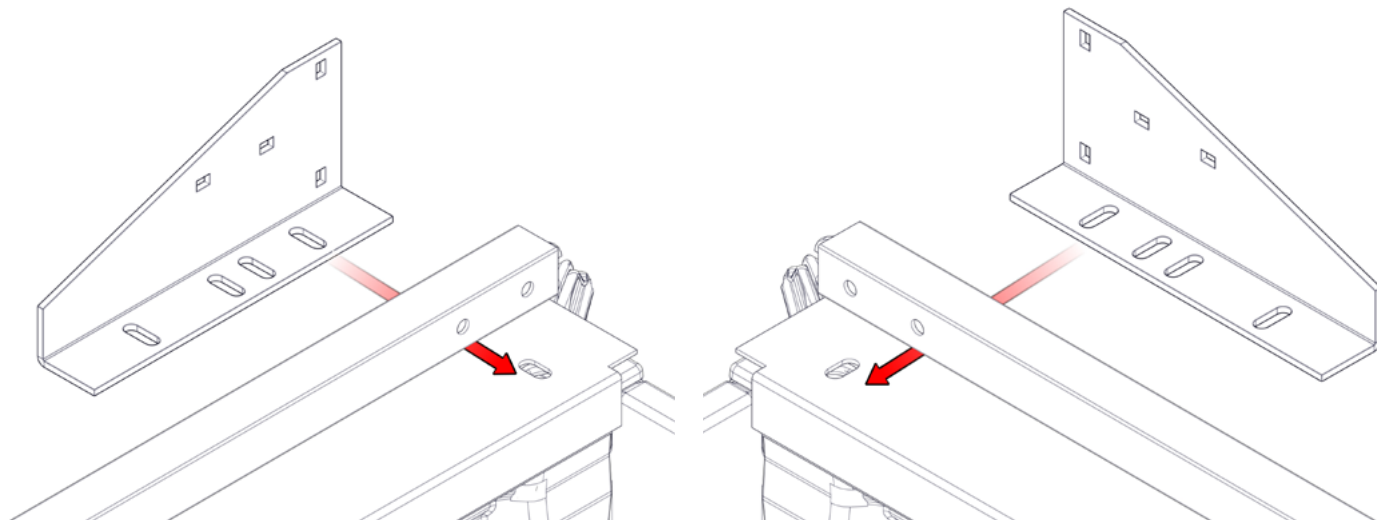

**5.** 3/8 X 1 3/4 Stainless Steel Counter Sink Bolt

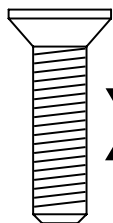

3/8" Stainless Steel Finishing Washer

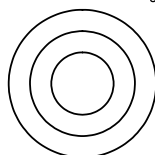

**X 2**

**X 2**

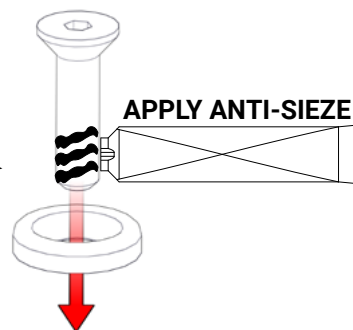
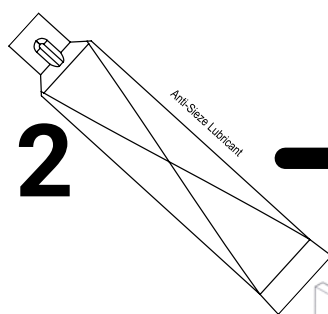

**APPLY ANTI-SIEZE**

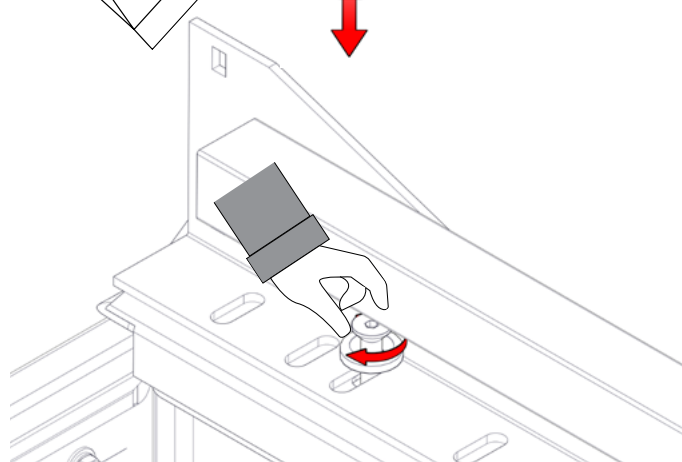
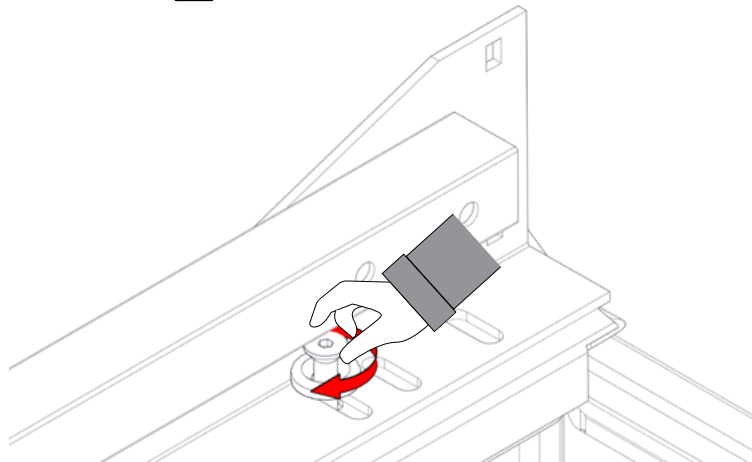

**6.**

**HARDWARE FOR STEP 6-7 IS INCLUDED WITH YOUR RAILCAPS.**

5/16 X 1-1/2 Stainless Steel Carriage Bolt

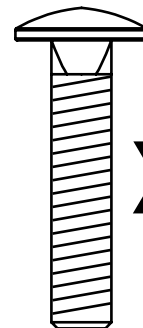

**X 4**



7.

5/16" X 5/8" Zinc Plated Camtainer Nut

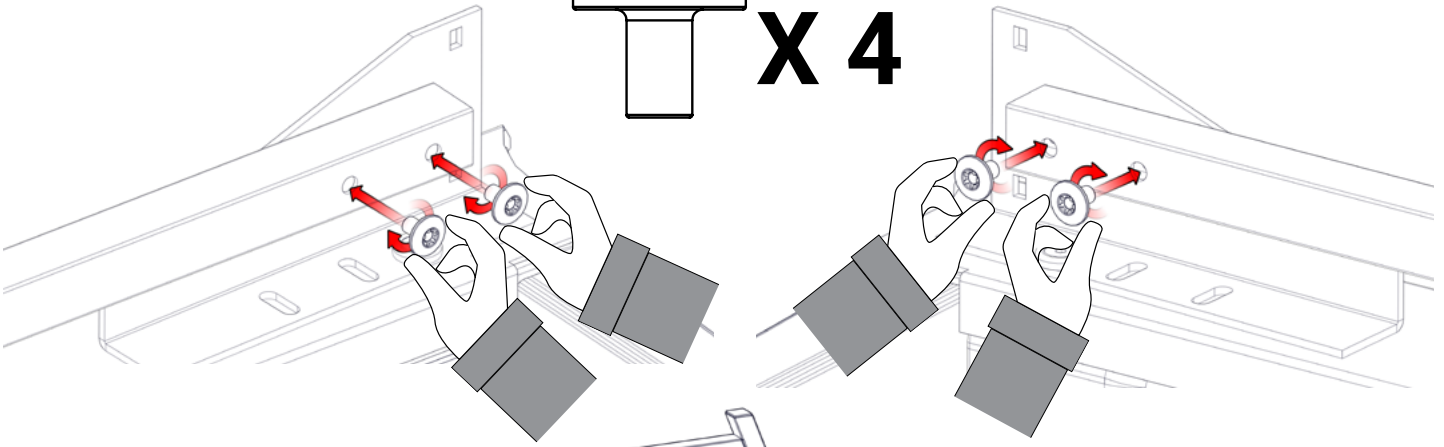
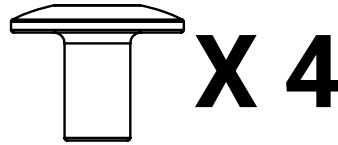

8.

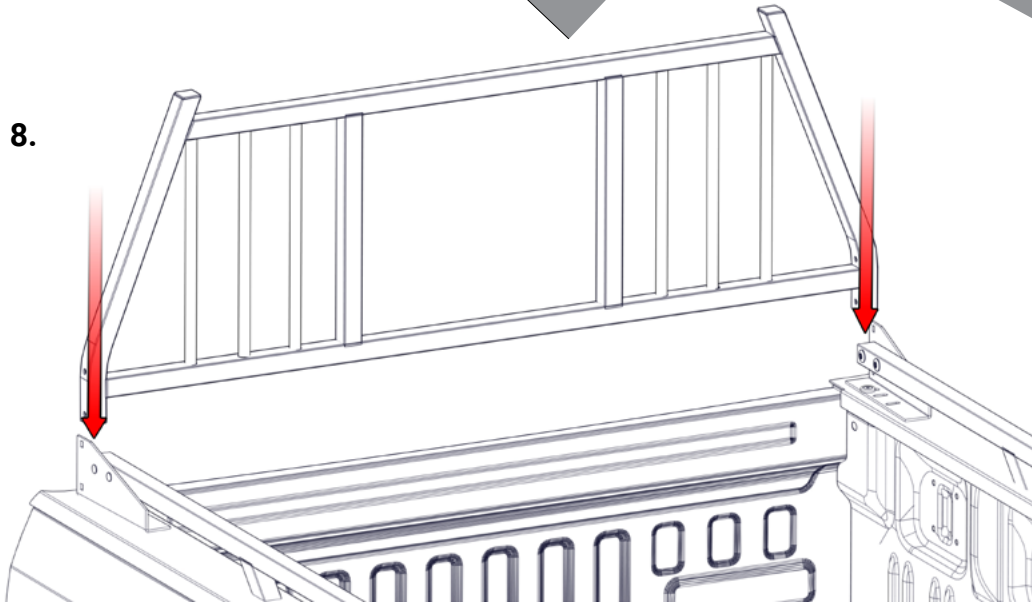

9.

5/16" X 5/8" Zinc Plated Camtainer Nut

5/16 X 1-1/2 Stainless Steel Carriage Bolt

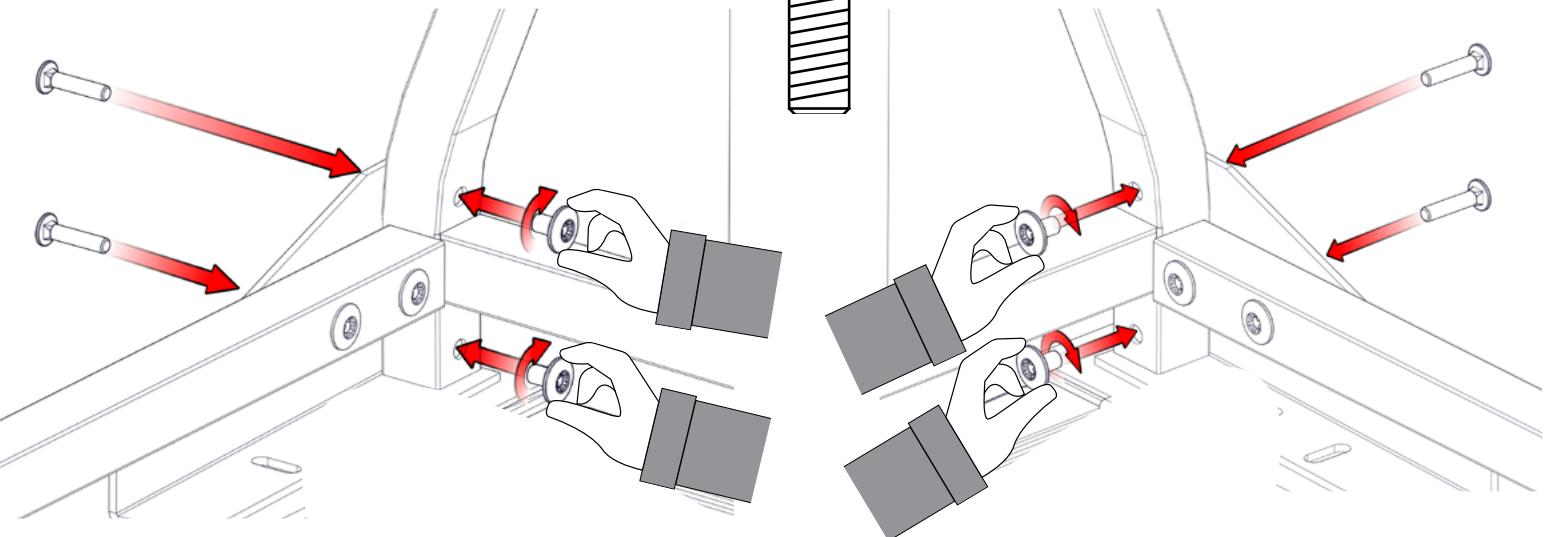
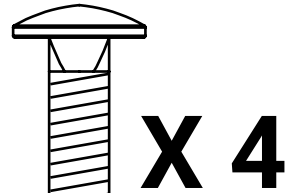



10.



=236 IN-LBF  
=19.5 FT-LBF

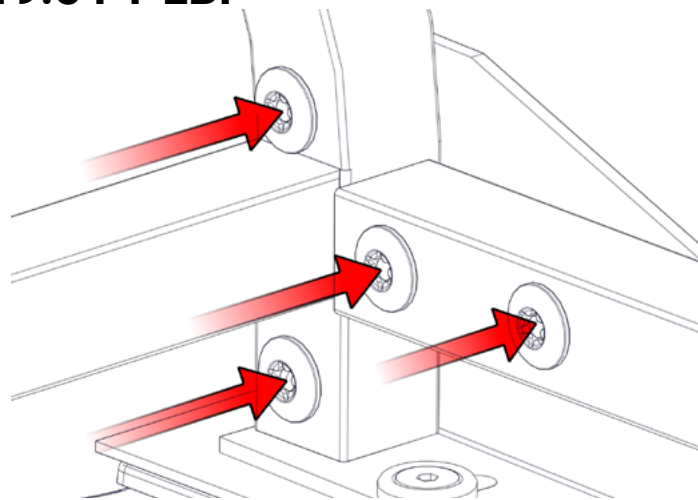
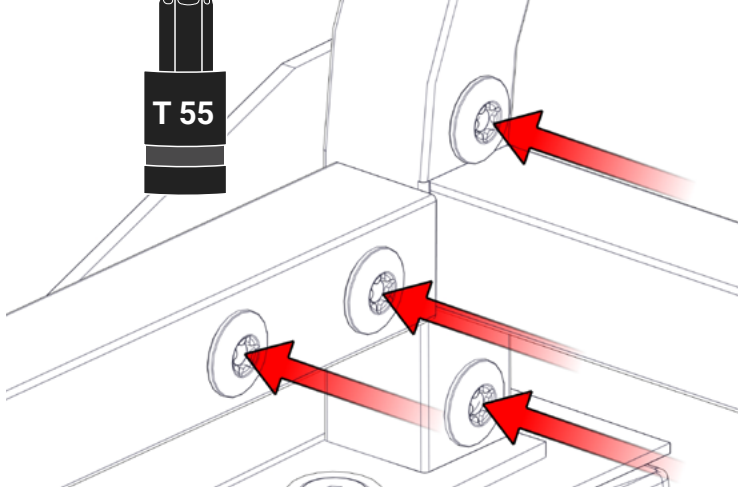

11.

## CENTER CAB GUARD ON TRUCK BOX.

12.



=90 IN-LBF  
=7.5 FT-LBF

INSTALLATION OF CABGUARD WITH RAIL  
CAPS COMPLETE. SEE STEP 19 FOR  
LED CABGUARD WIRING PINOUT  
(IF EQUIPPED).

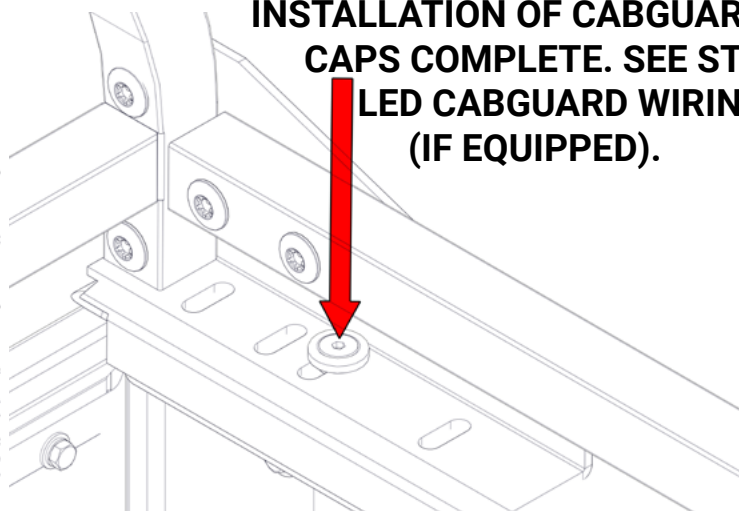
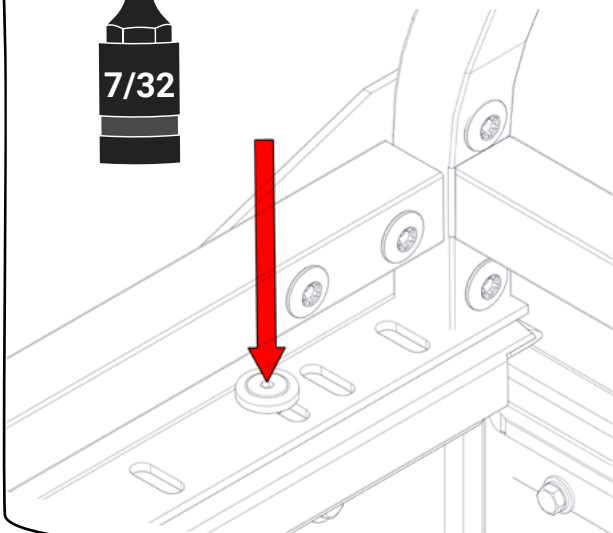

13.

3/8 X 1 3/4 Stainless Steel Counter Sink Bolt

3/8" Stainless Steel Finishing Washer

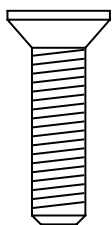

X 2

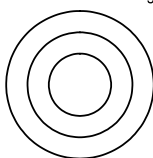

X 2

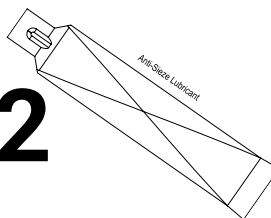

INSTALLATION WITHOUT  
RAILCAPS.

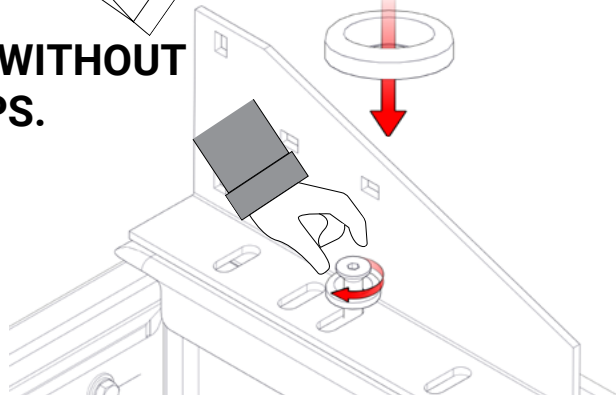
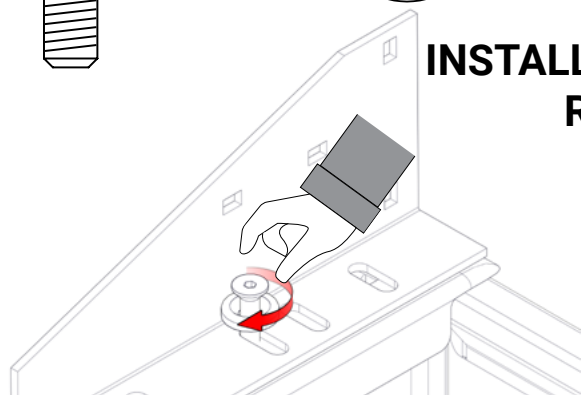
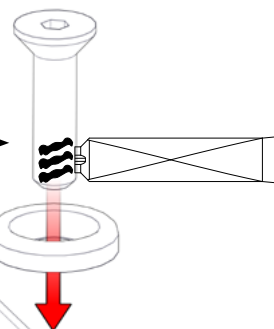

14.

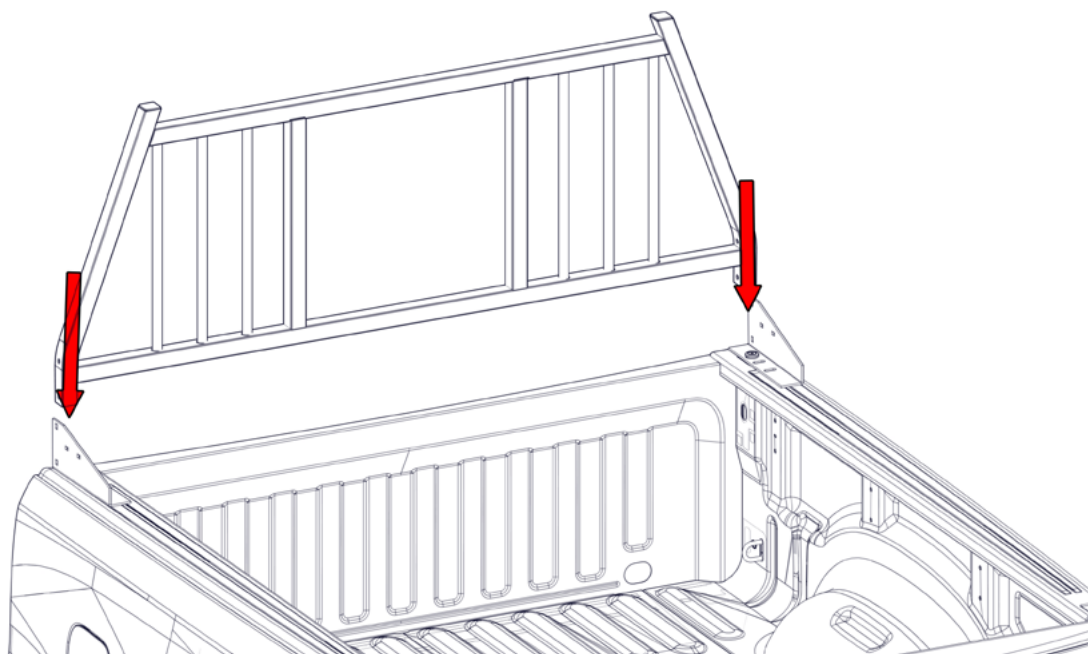

15.

5/16" X 5/8" Zinc Plated Camtainer Nut

5/16 X 1-1/2 Stainless Steel Carriage Bolt

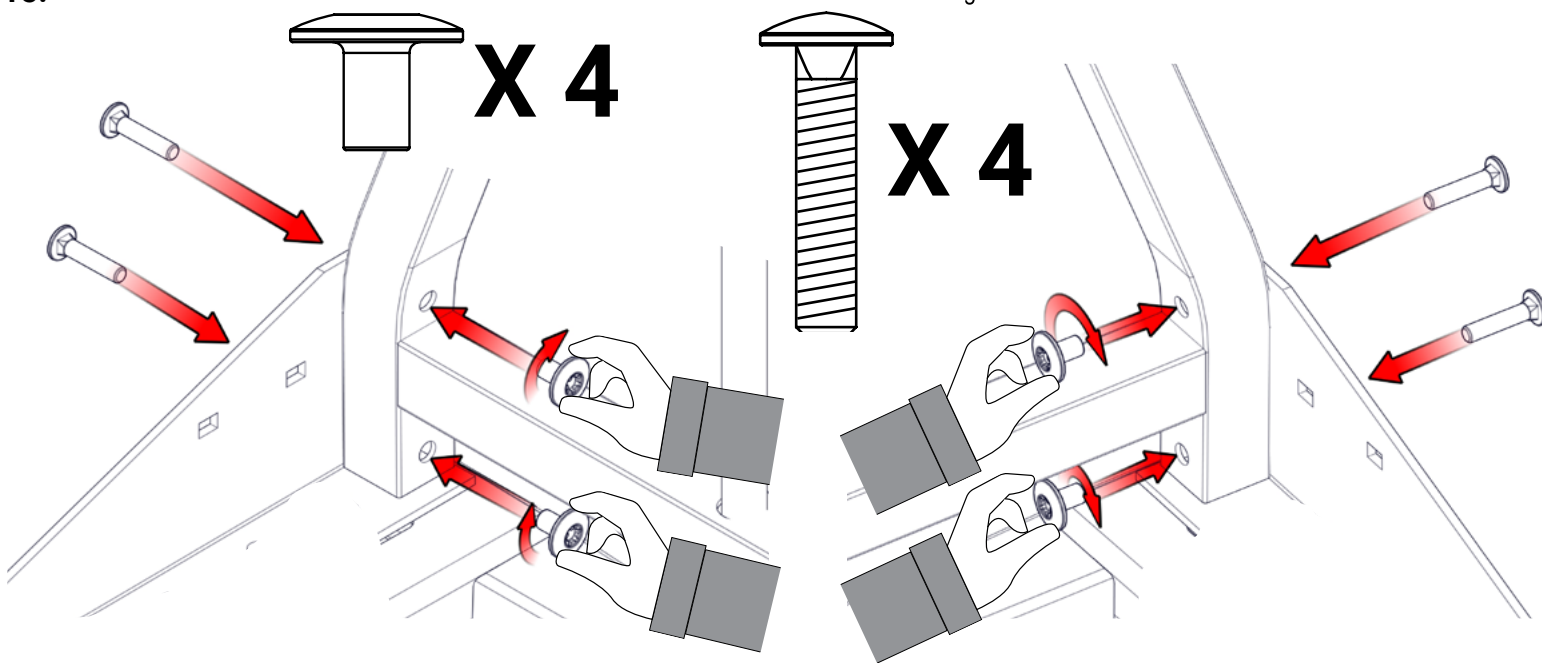

16.

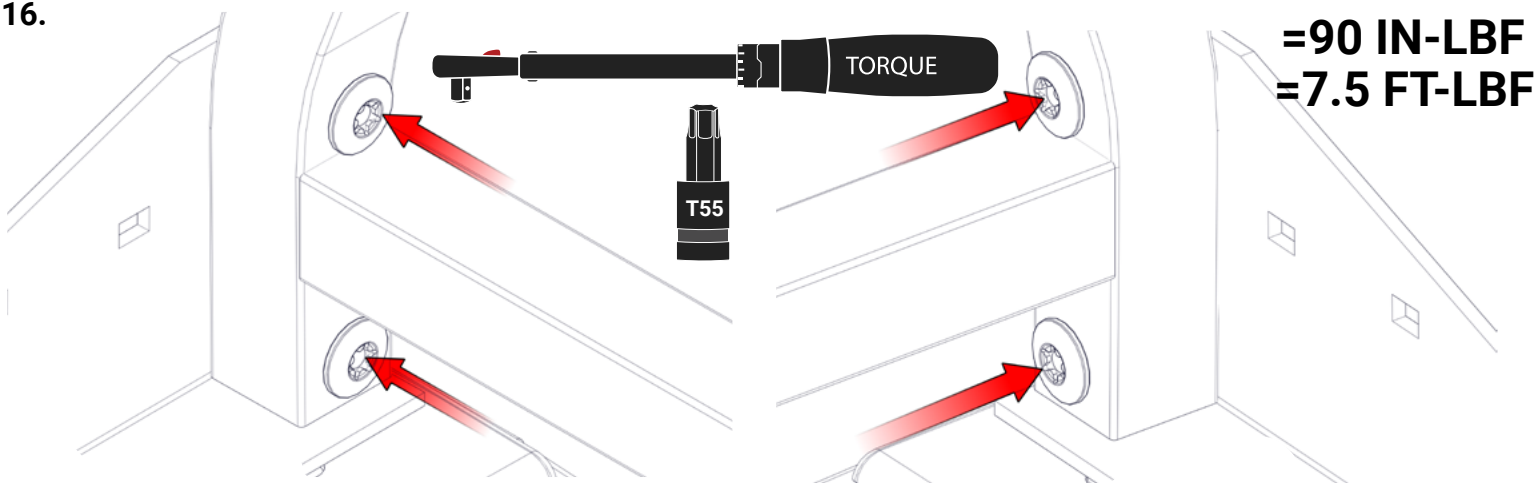



17. **CENTER CAB GUARD ON TRUCK BOX AND  
INSTALL A SECONDARY HOLD DOWN KIT.**

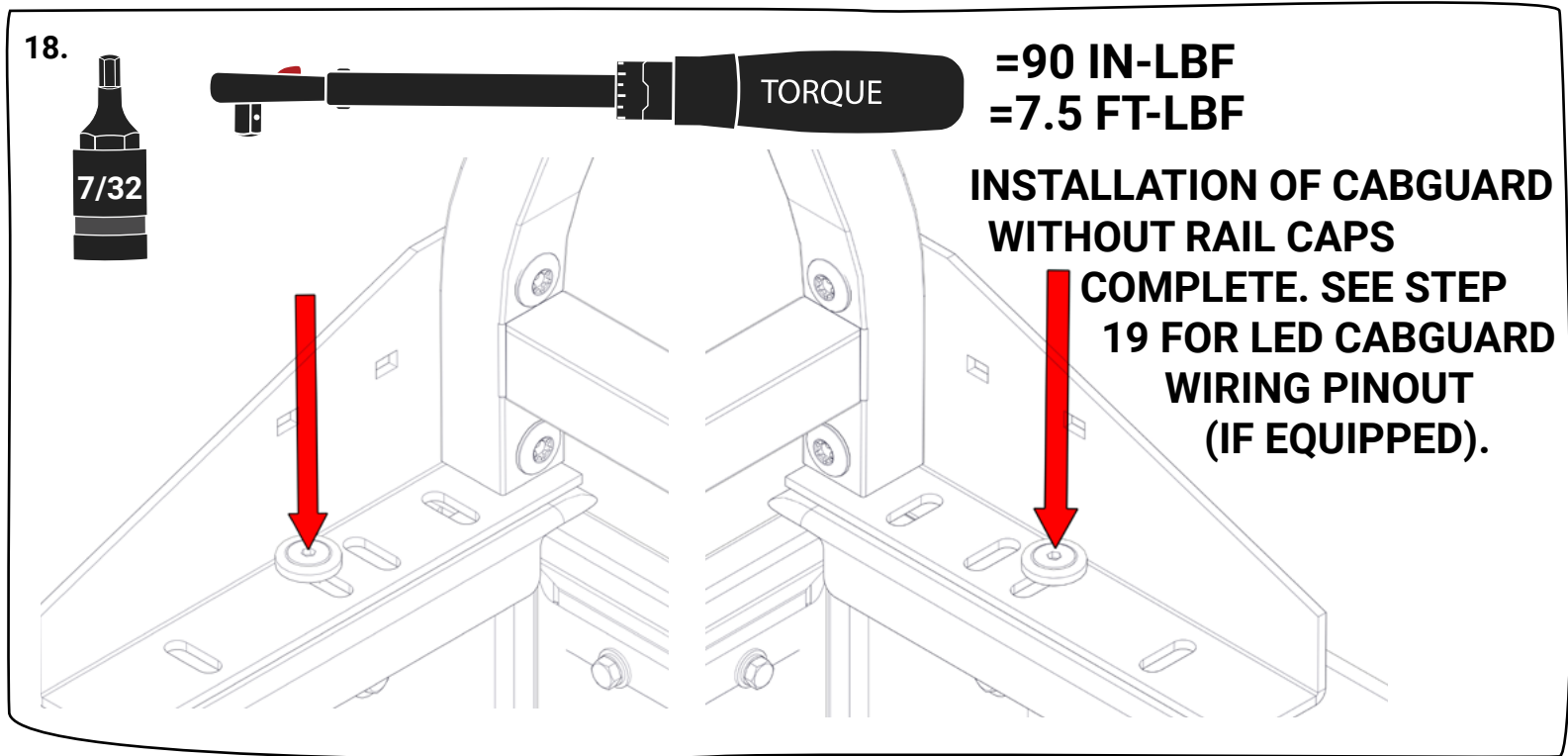

19. **IF YOUR INSTALLING A LED CABGUARD  
PLEASE REFER TO THE WIREING PINOUT  
BELOW.**

- **Red = Left Turn Signal**
- **Yellow = Right Turn Signal**
- **Black = Tail / Marker Lights**
- **Blue = Back Up Lights**
- **White = Chassis Ground**