

INSTALLATION INSTRUCTIONS: 2014-18 SILVERADO/SIERRA RAIL CAP

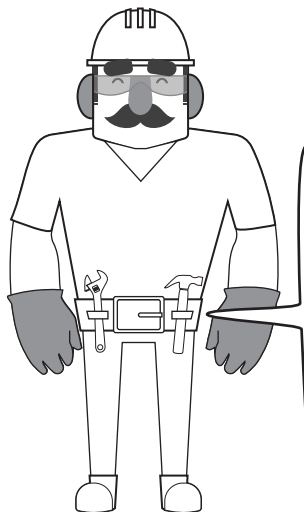

TOOLS NEEDED:

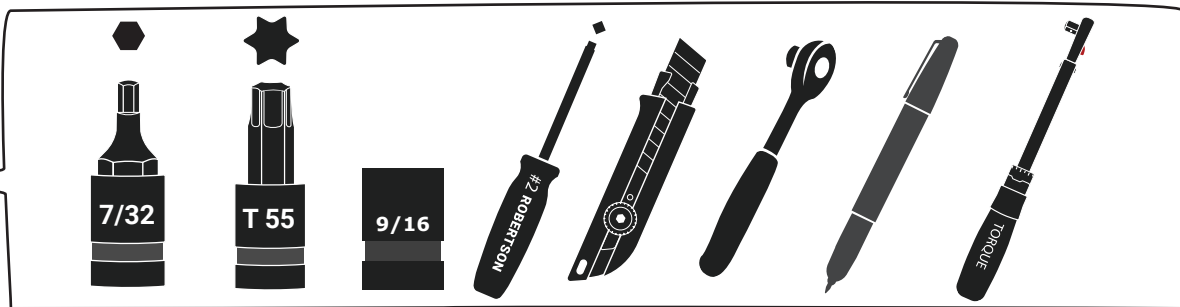

CAUTION:

This equipment is designed to be professionally installed by an approved up-fitter. Always wear ear and eye protection and exercise caution when installing Westcan products.

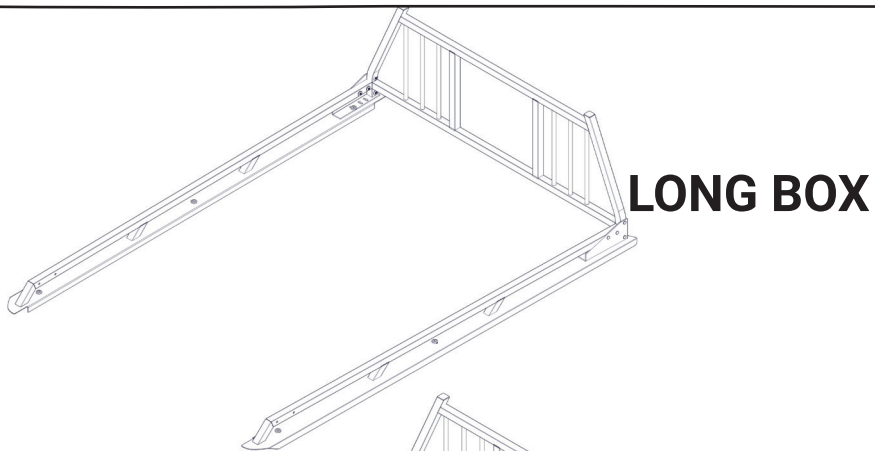

LONG BOX

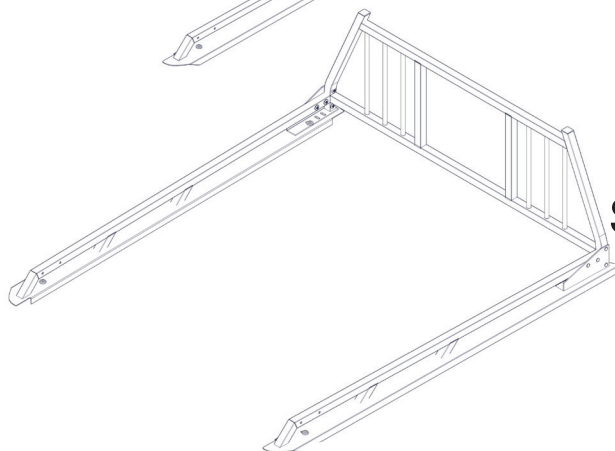

SHORT BOX

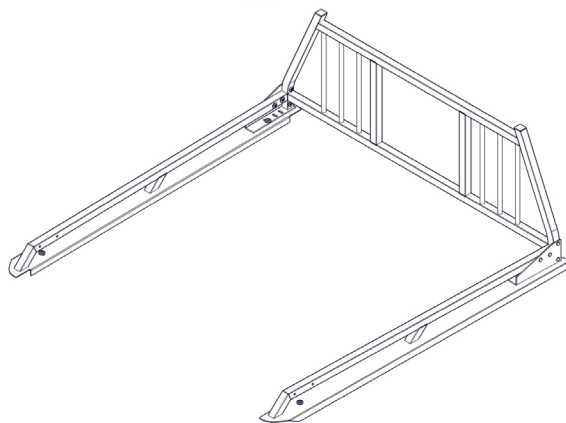

EXTRA SHORT BOX

PREPARATION:

1. Ensure all parts are present and accounted for before installation. **Begin the installation of your cabguard before your rail caps.** Plan the location of your installation ahead of time and make sure your installation location does not impede any other components you are installing or damage the safety and functionality of your vehicle.
2. Exercise extreme diligence when drilling holes into a motor vehicle. Increasing complexity and model year changes can alter the location of fuel, hydraulic and electrical lines. Please visually inspect all locations prior to drilling.
3. Re-Torque the 3/8" x 1-3/4" Stainless Steel Countersink Bolt every 3 month.

BOX CAP PREPARATION:

Some truck box lengths require the plastic truck box caps to be cut to expose the stake pocket cutout. Cut out around the relief in the plastic box cap. Exercise caution when cutting caps to avoid injury.

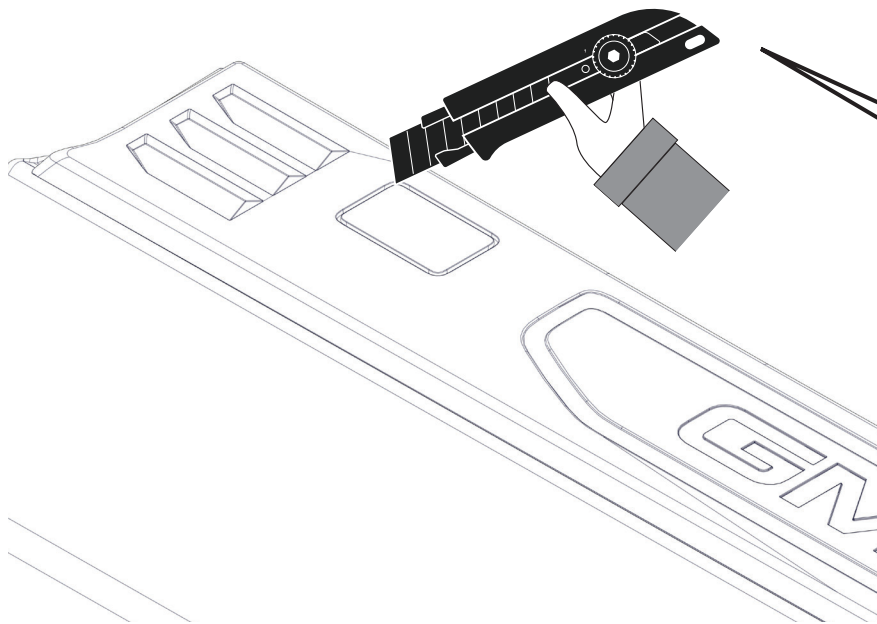

NOTE:
WHEN THE HOLD ICON
IS USED TO TURN A
FASTENER, TIGHTEN
THEM FINGER TIGHT.

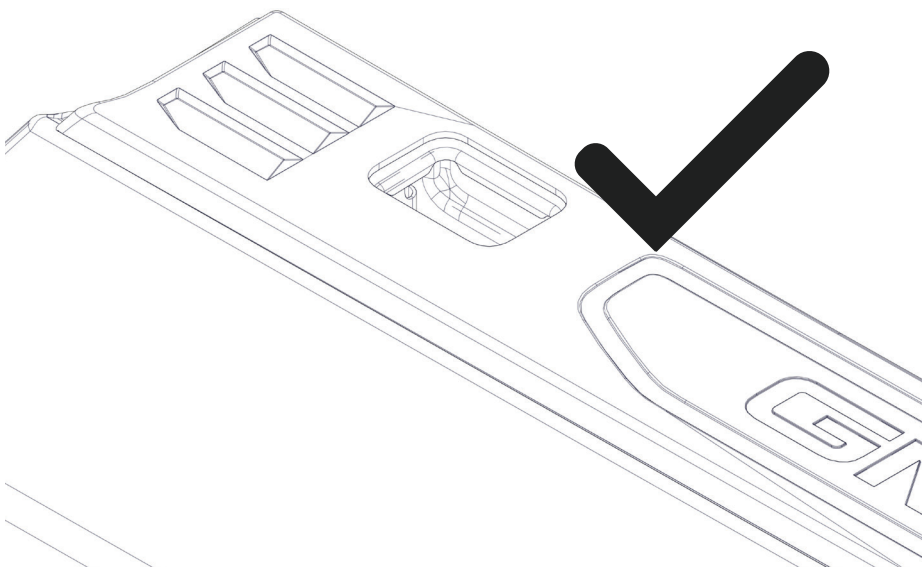

1.

LONG BOX
CUT PLASTIC CAPS TO
EXPOSE THE MIDDLE STAKE POCKET

2.

EXTRA SHORT BOX AND SHORT BOX



X 2

LONG BOX

3/8 X 1 3/4 Stainless Steel Counter Sink Bolt

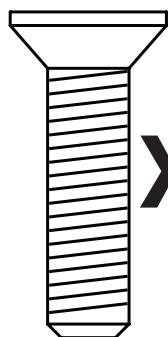

X 2

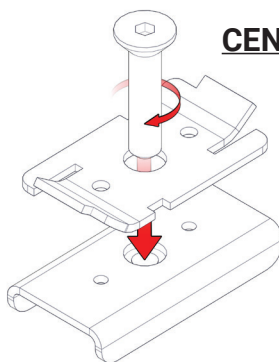

CENTER STAKE POCKET

X 2

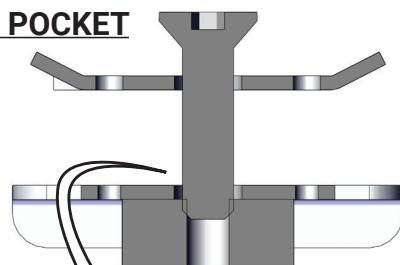

THIS GAP IS
REQUIRED FOR
INSTALLATION



X 2

REAR STAKE POCKET

3.

REQUIRED FOR MIDDLE LONG BOX STAKE POCKET

#10 - 1" Plated Zinc Robertson Powerhead Drill Tip Screw

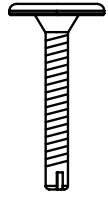

X 4

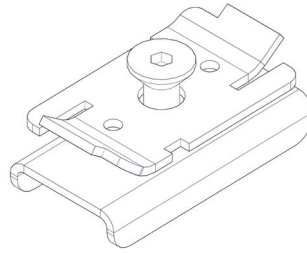

X 2

3.1

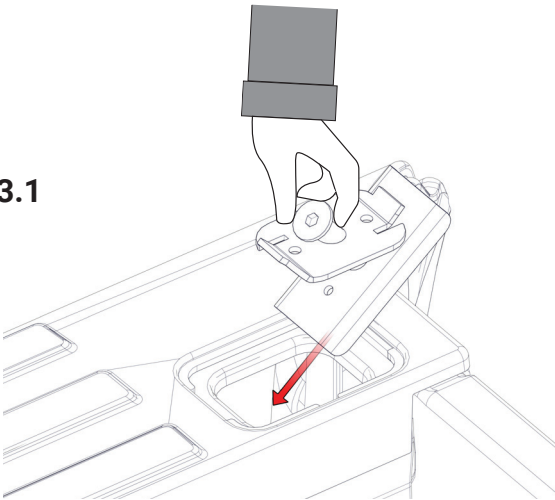

3.2

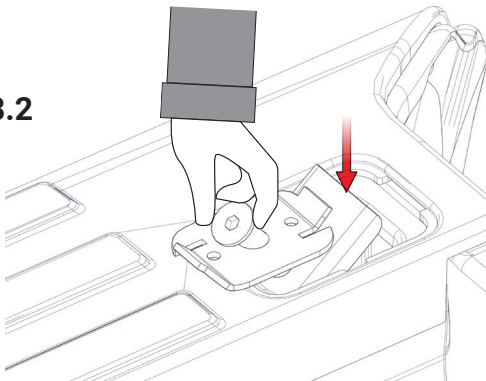

3.3

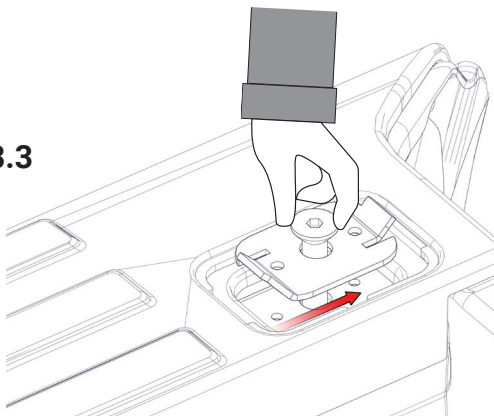

3.4

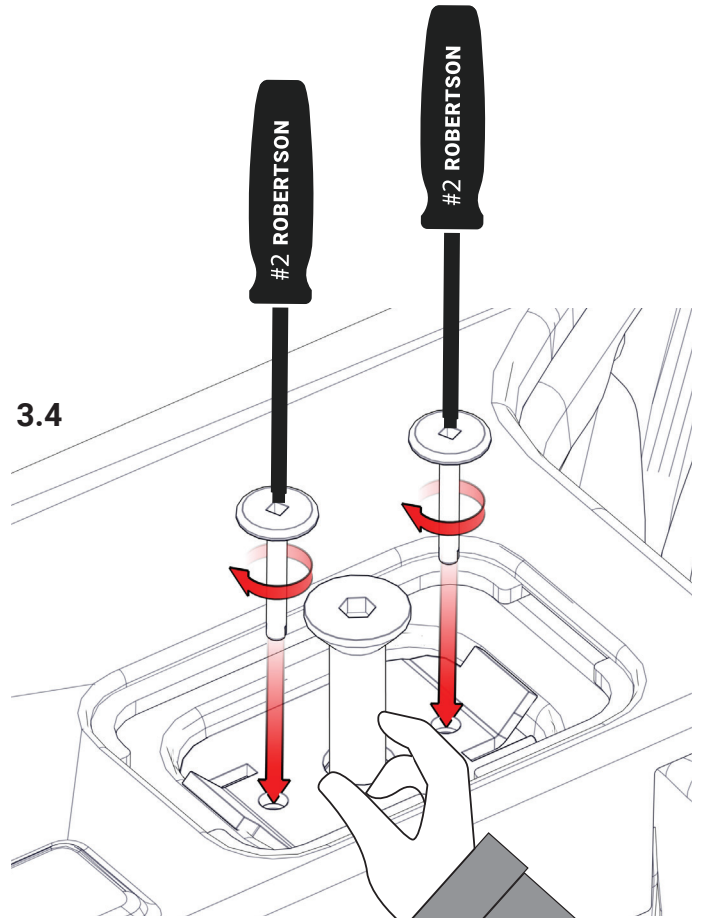

3.5

**REMOVE
COUNTER SINK
BOLT AND RETAIN
FOR STEP 5-6**

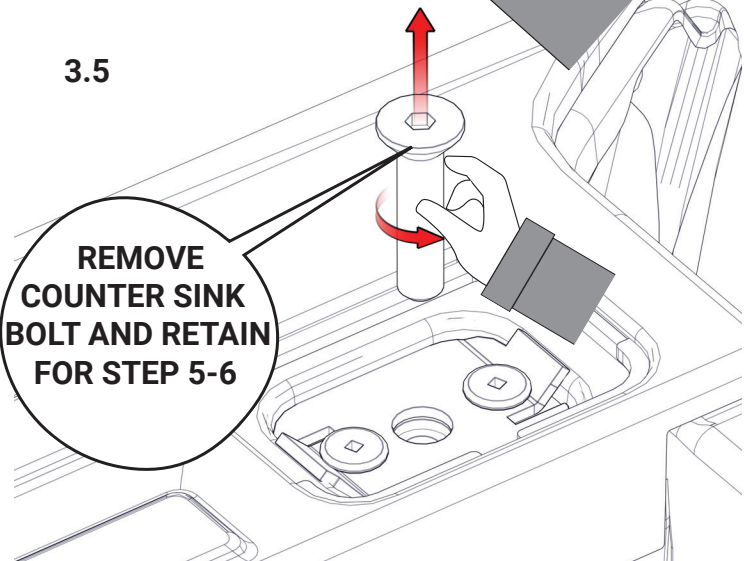

REQUIRED FOR EXTRA SHORT, SHORT AND LONG BOX REAR STAKE POCKET

4.

3/8" x 1 1/4" Stainless Steel Hex Bolt

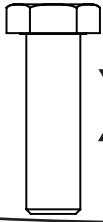

X 2

3/8" Stainless Steel Lock Washer

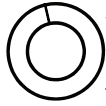

X 2

3/8" Stainless Steel Flat Washer

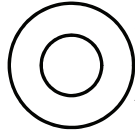

X 2



X 2

4.1
REMOVE TAILLIGHT
HOUSING FOLLOWING
VEHICLE MANUFACTURERS
GUIDELINES.

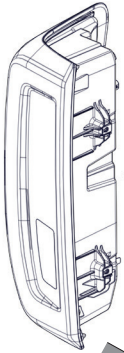

4.4

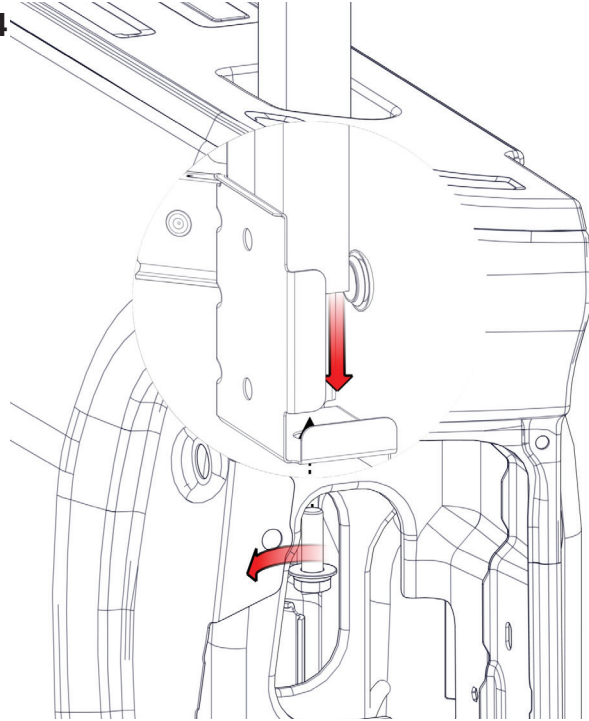

9/16

4.2

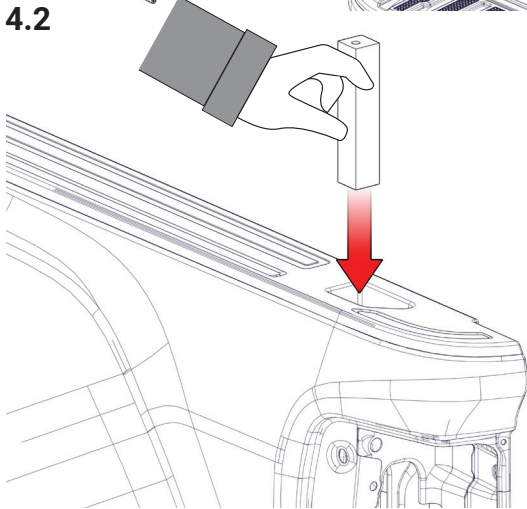

4.5

4.3

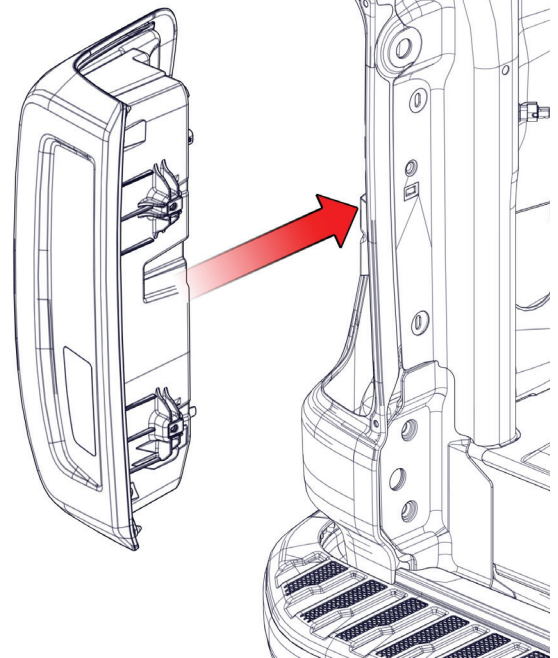
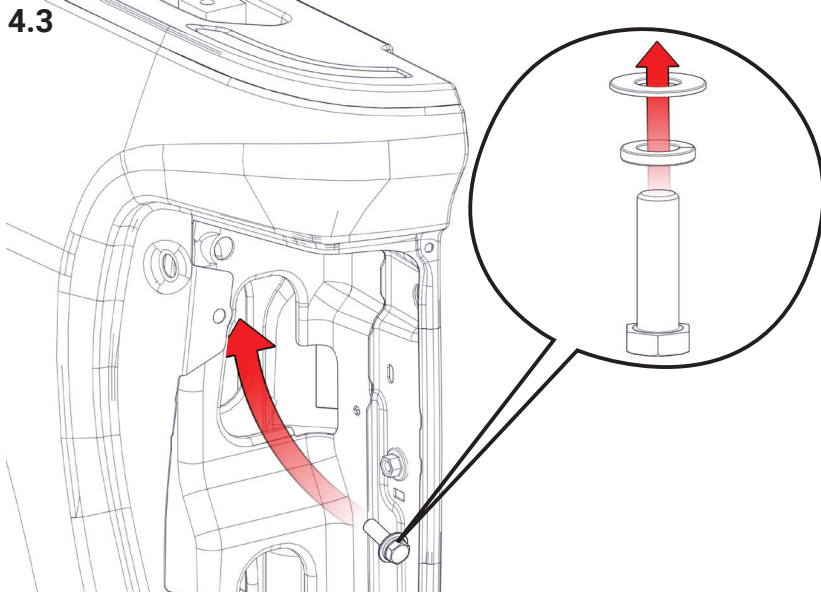

5.

LONG BOX

3/8 X 1 3/4 Stainless Steel Counter Sink Bolt

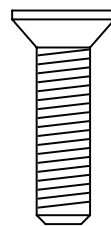

X 4

3/8" Stainless Steel Finishing Washer

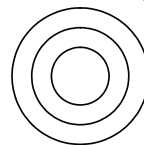

X 4

Anti-Sieze Lubricant

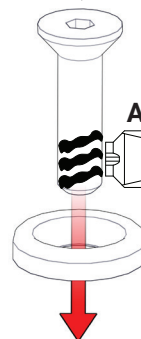
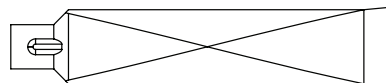

APPLY ANTI-SIEZE

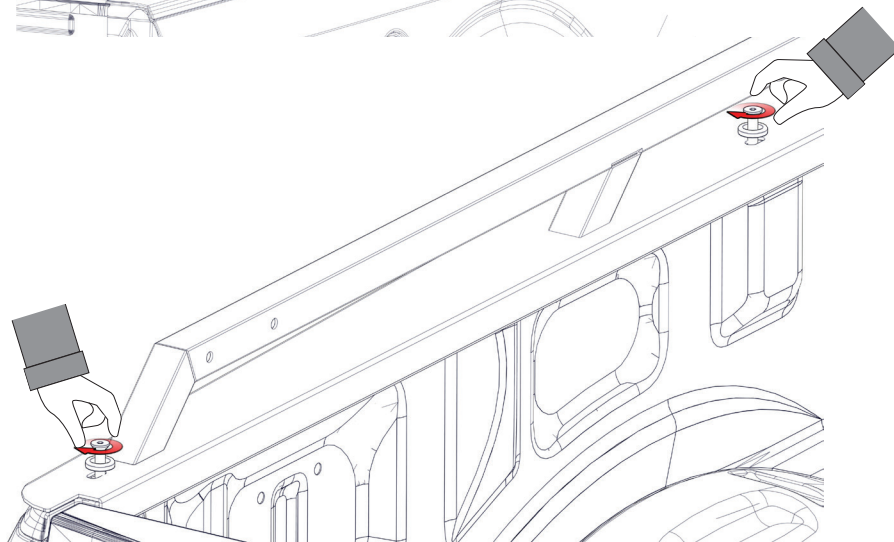
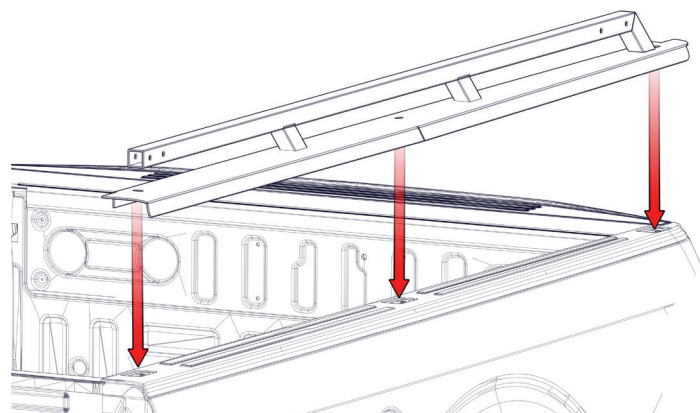

**=90 IN-LBF
=7.5 FT-LBF**

**IF INSTALLING WITH A CABGUARD,
TORQUE DOWN WHEN THE CABGUARD
INSTALL IS COMPLETE.**

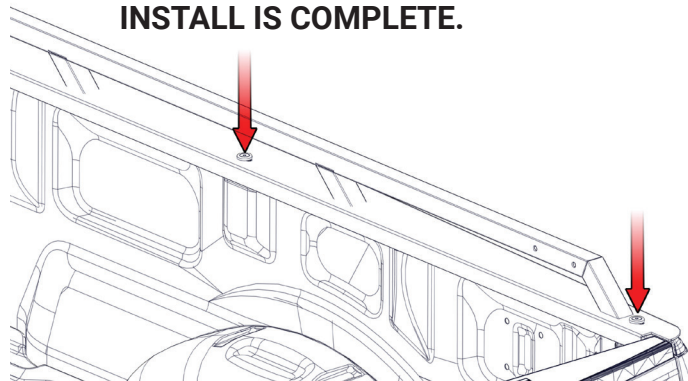
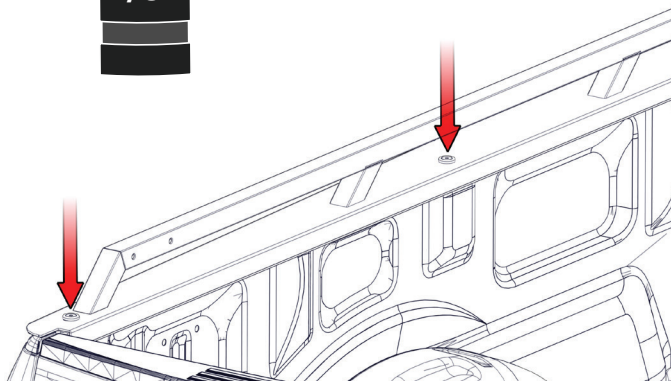

6.

EXTRA SHORT BOX AND SHORT BOX

3/8 X 1 3/4 Stainless Steel Counter Sink Bolt

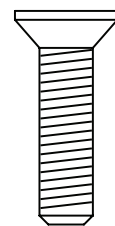
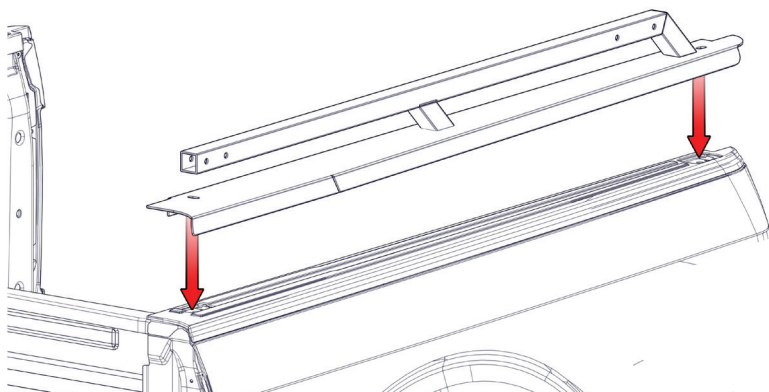

X 2

3/8" Stainless Steel Finishing Washer

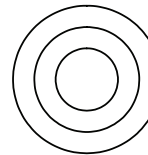

X 2

Anti-Sieze Lubricant

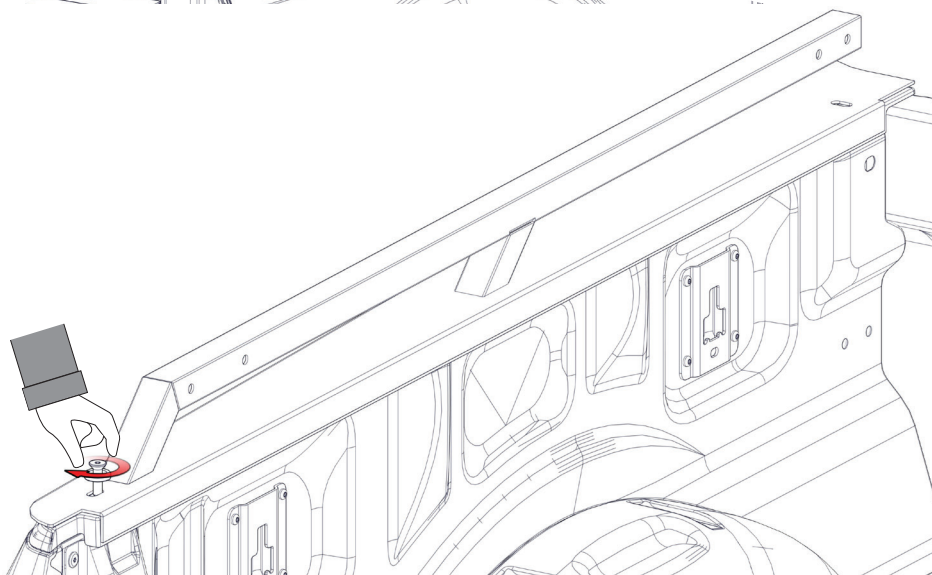
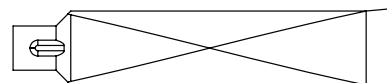

APPLY ANTI-SIEZE

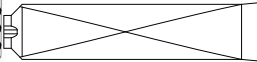

**=90 IN-LBF
=7.5 FT-LBF**

**IF INSTALLING WITH A CABGUARD,
TORQUE DOWN WHEN THE CABGUARD
INSTALL IS COMPLETE.**

