

INSTALLATION INSTRUCTIONS: 2014-2019 SILVERADO/SIERRA DUALY CROSS OVER BOX CAB GUARD

TOOLS NEEDED:

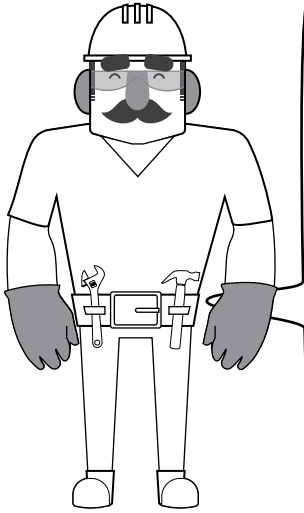

CAUTION:

This equipment is designed to be professionally installed by an approved up-fitter. Always wear ear and eye protection and exercise caution when installing Westcan products.

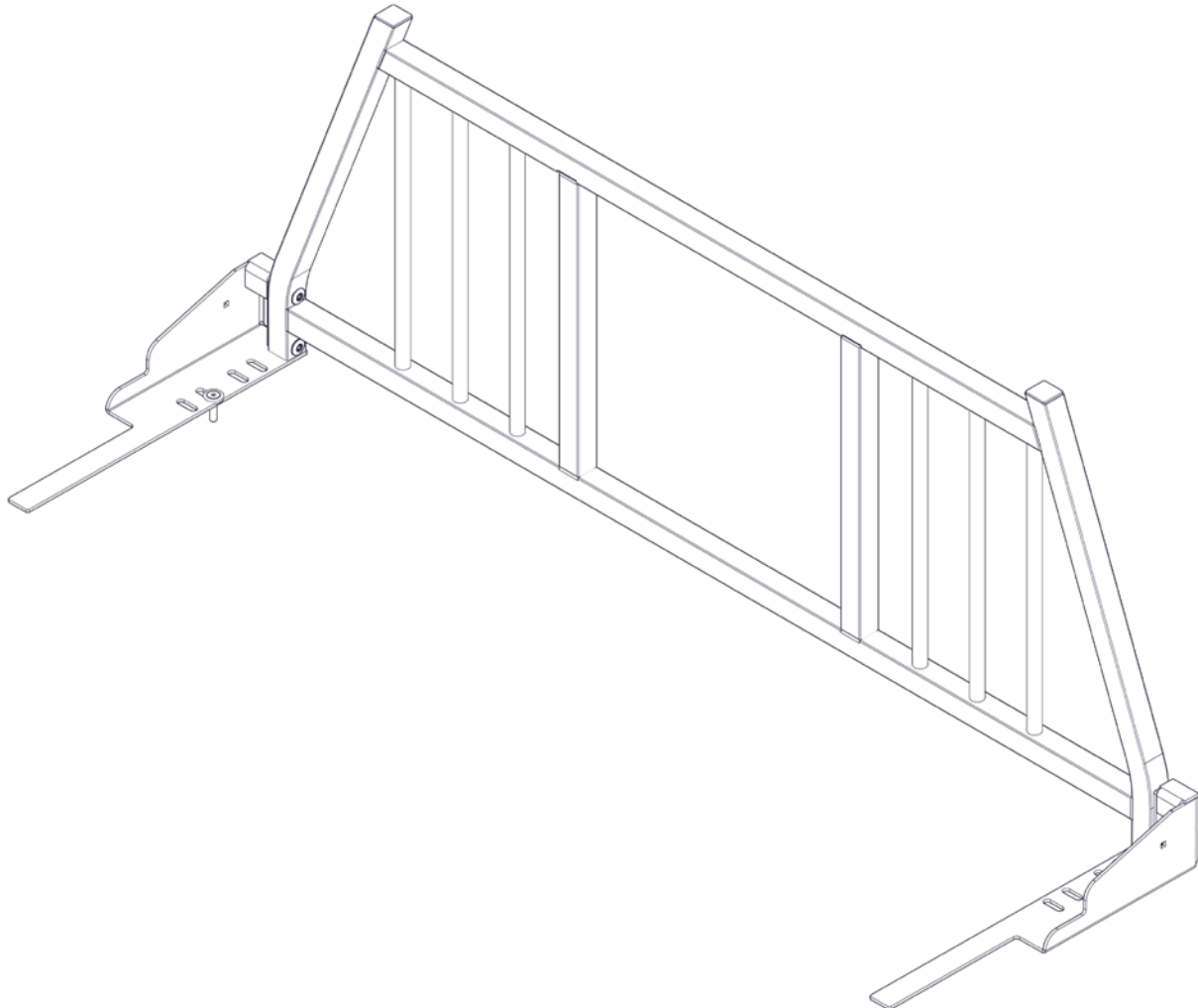

PREPARATION:

1. Ensure all parts are present and accounted for before installation. Plan the location of your installation ahead of time and make sure your installation location does not impede any other components you are installing or damage the safety and functionality of your vehicle.
2. Exercise extreme diligence when drilling holes into a motor vehicle. Increasing complexity and model year changes can alter the location of fuel, hydraulic and electrical lines. Please visually inspect all locations prior to drilling.
3. Re-Torque the 3/8" x 1-3/4" Stainless Steel Countersink Bolt every 3 month.

BOX CAP PREPARATION:

Some truck box lengths require the plastic truck box caps to be cut to expose the stake pocket cutout. Use the provided template as a guide for cutting the box cap. Exercise caution when cutting caps to avoid injury.

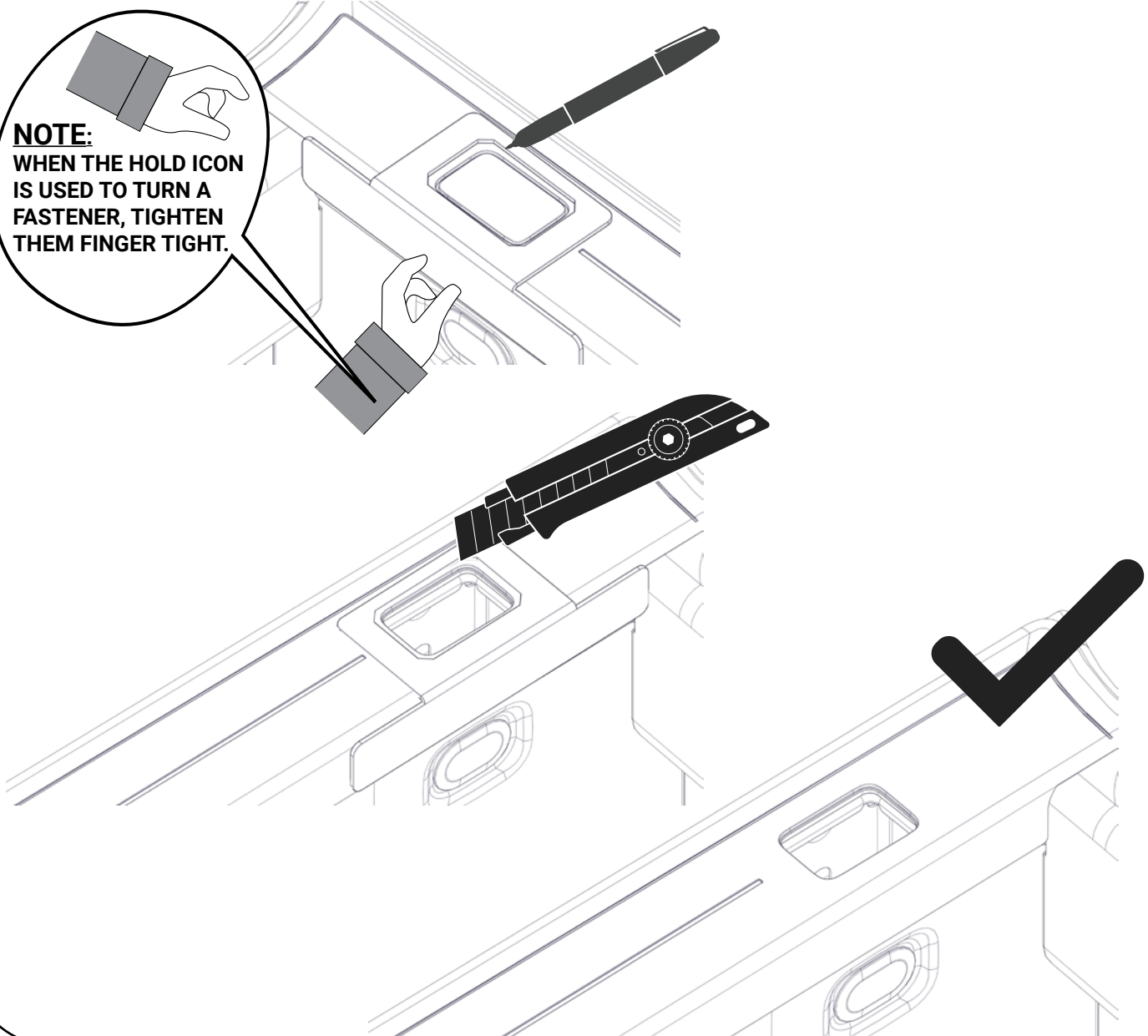

1.

LONG BOX DUALY
CUT PLASTIC CAPS TO EXPOSE FRONT STAKE POCKET.

2.

3/8 X 1 3/4 Stainless Steel Counter Sink Bolt

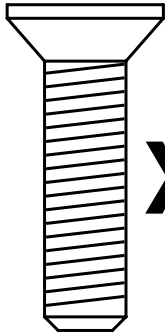

X 2

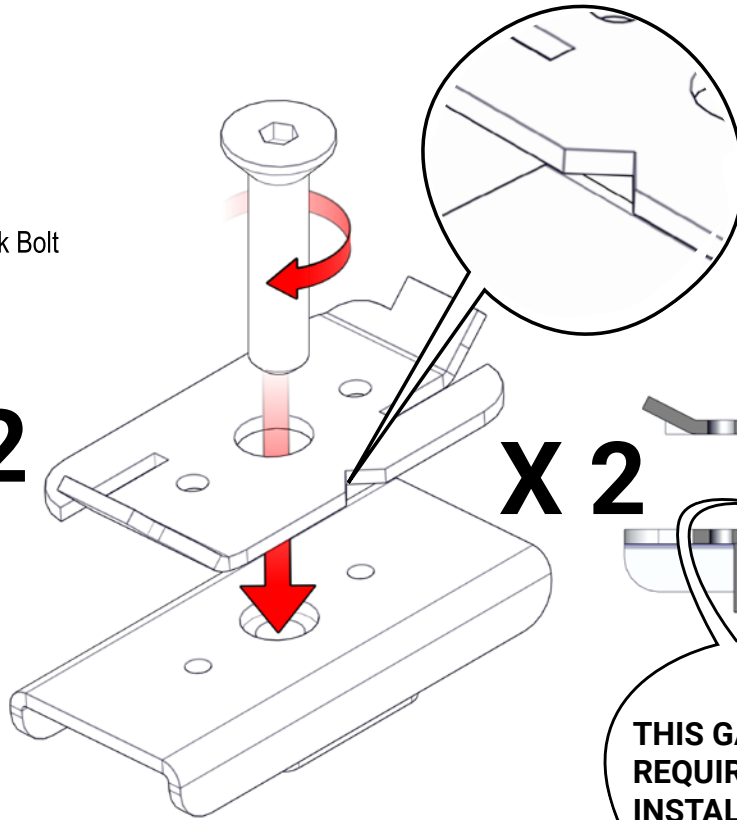

X 2

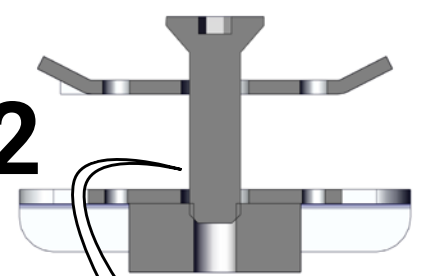

**THIS GAP IS
REQUIRED FOR
INSTALLATION**

3.

REQUIRED FOR FRONT STAKE POCKETS

#10 - 1" Plated Zinc Robertson Powerhead Drill Tip Screw

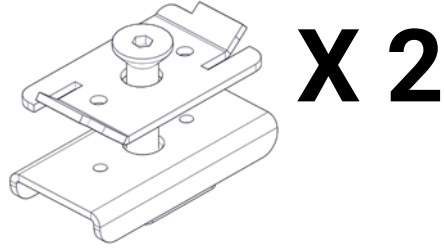
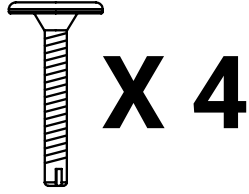

3.1

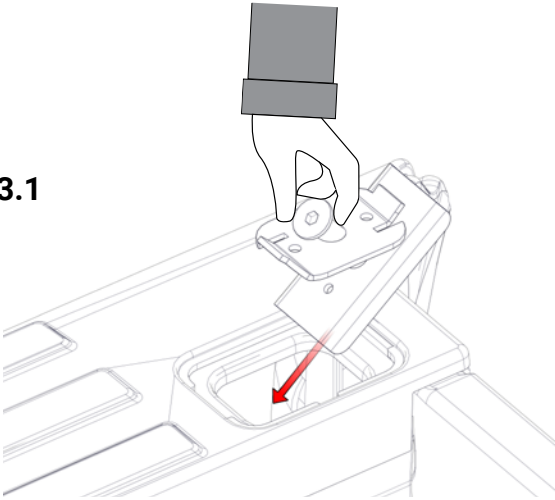

3.2

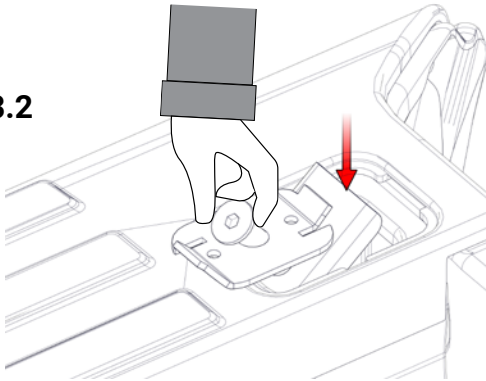

3.3

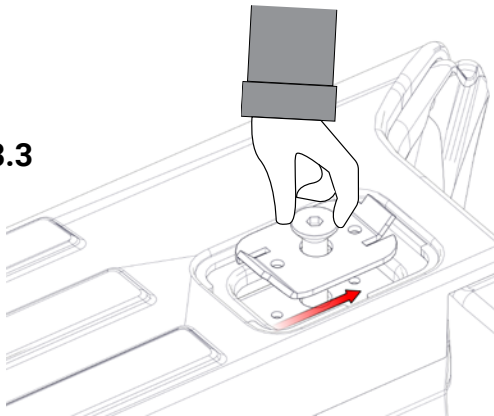

3.4

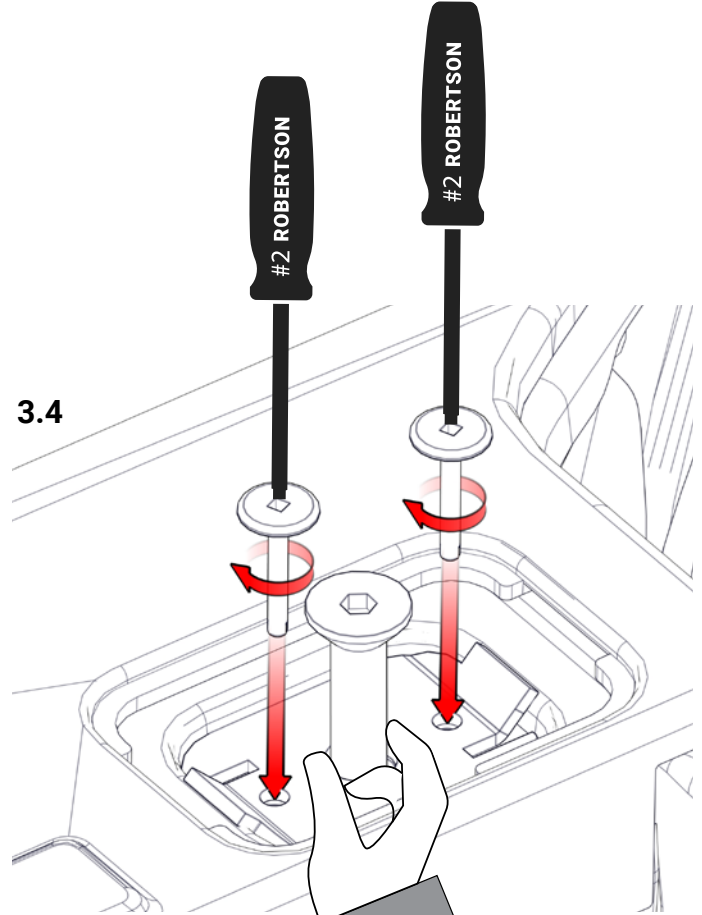

3.5

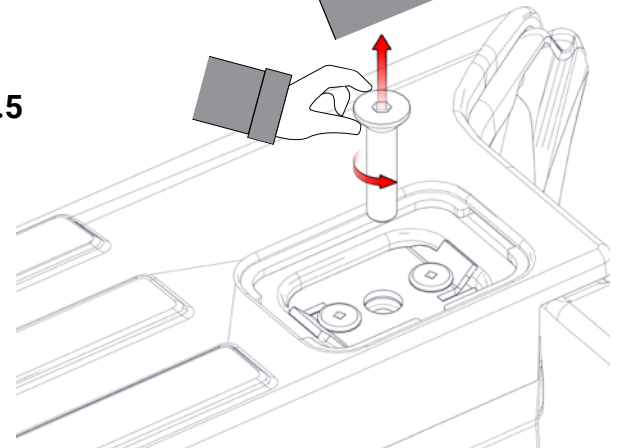

4.

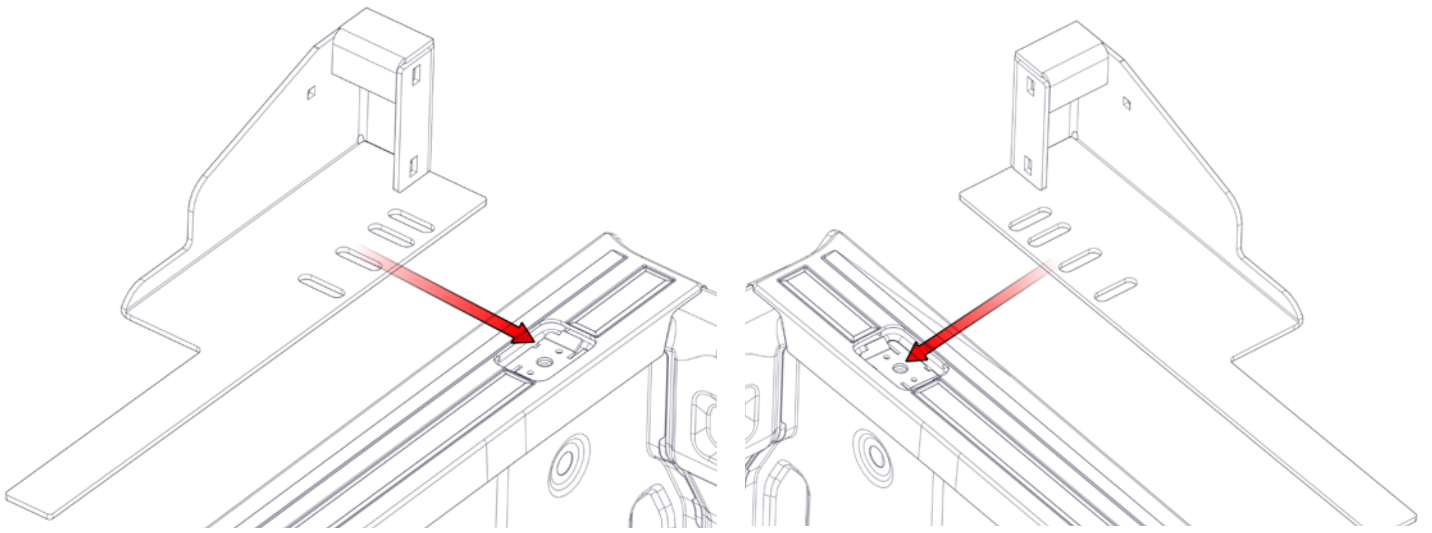

5.

3/8 X 1 3/4 Stainless Steel Counter Sink Bolt

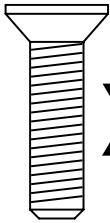

3/8" Stainless Steel Finishing Washer

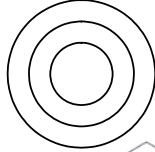

X 2 **X 2**

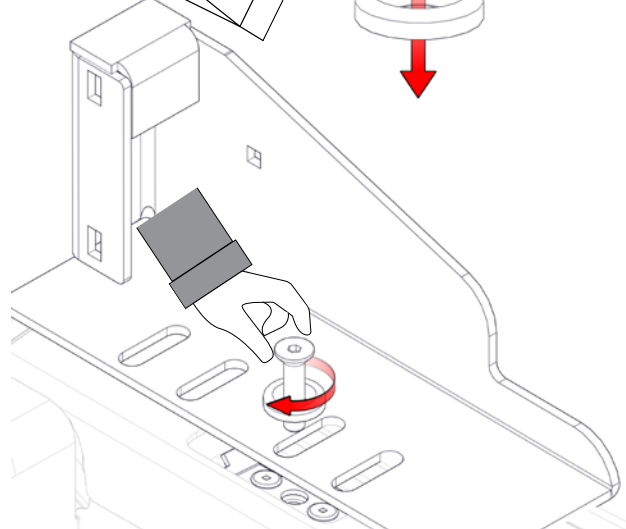
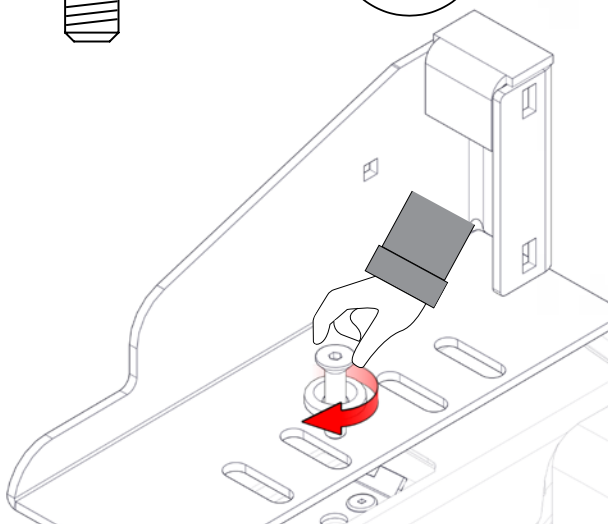
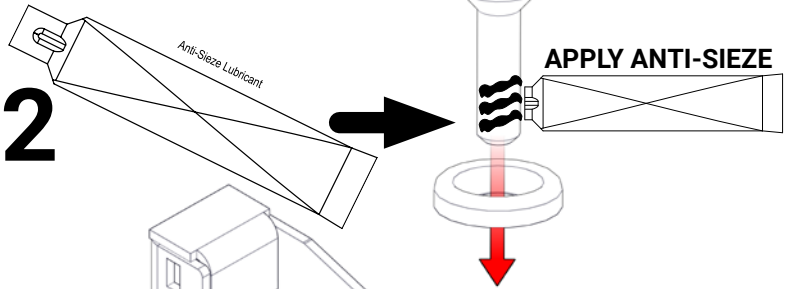

6.

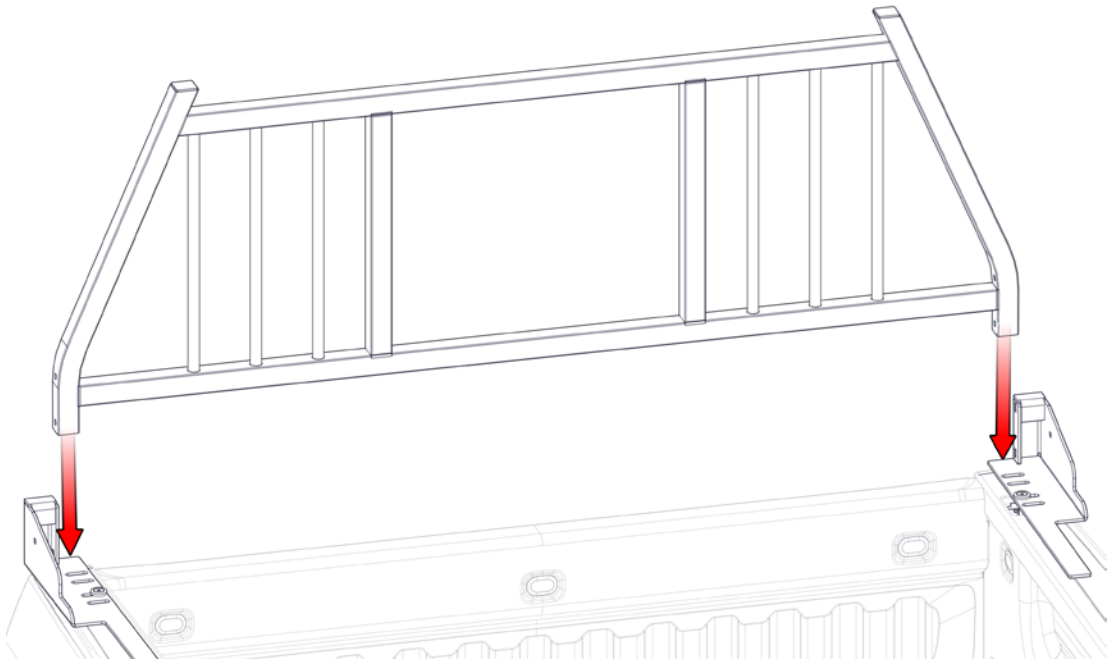

6.

5/16" X 5/8" Zinc Plated Camtainer Nut

5/16 X 1-1/2 Stainless Steel Carriage Bolt

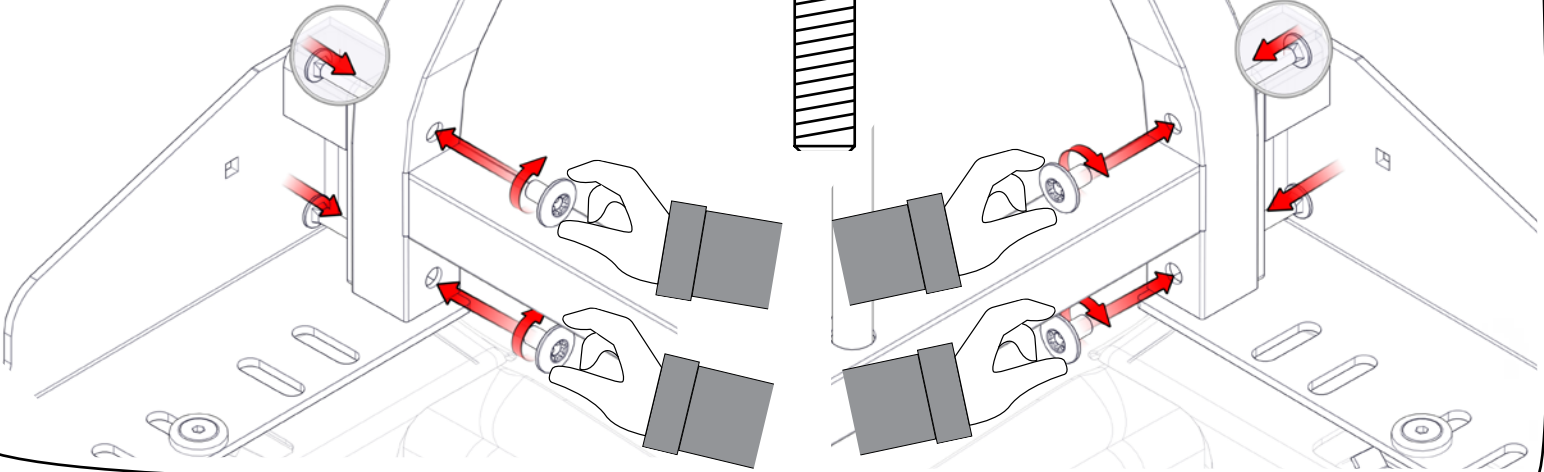
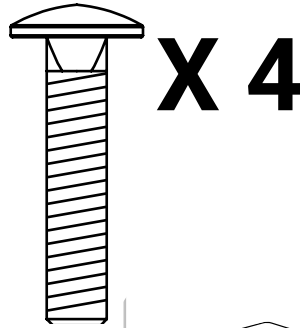

7.

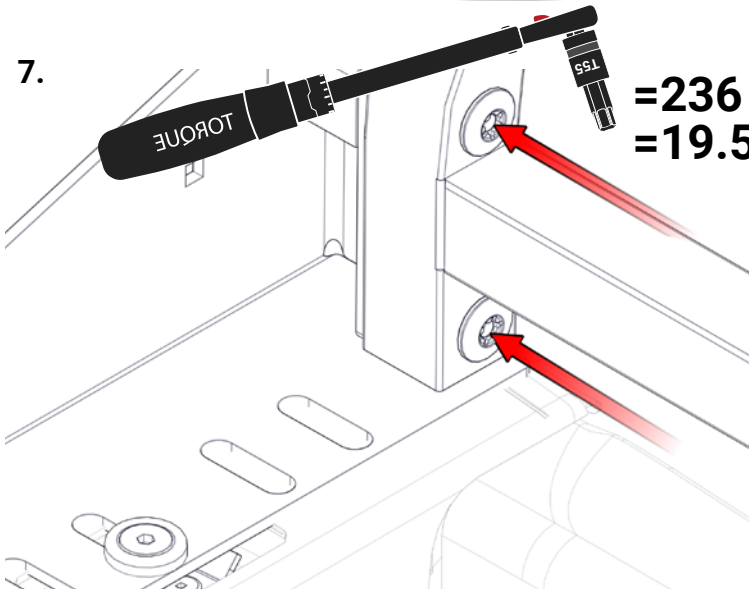

**=236 IN-LBF
=19.5 FT-LBF**

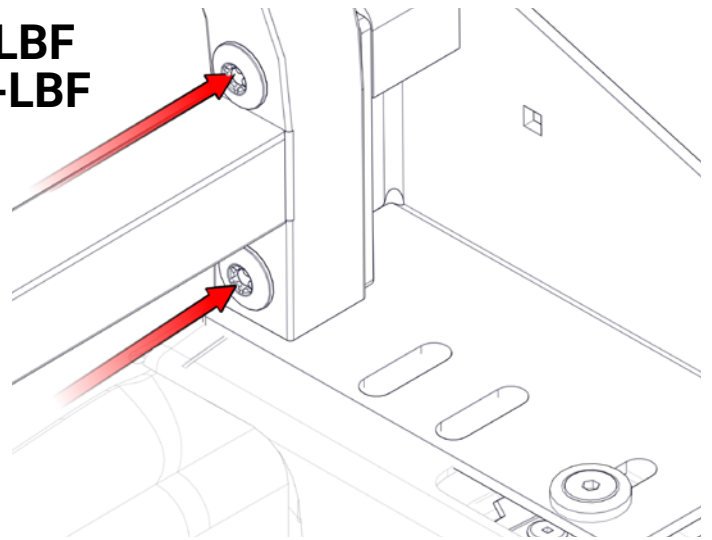

8.



**CENTER CABGUARD
ON TRUCK**

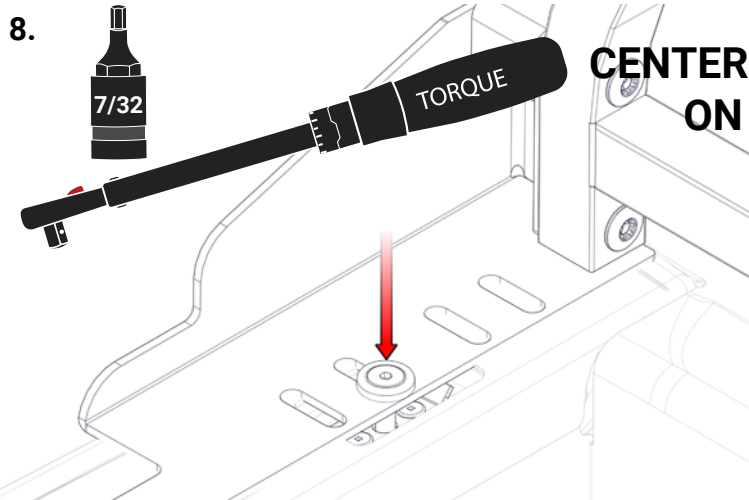

**=90 IN-LBF
=7.5 FT-LBF**

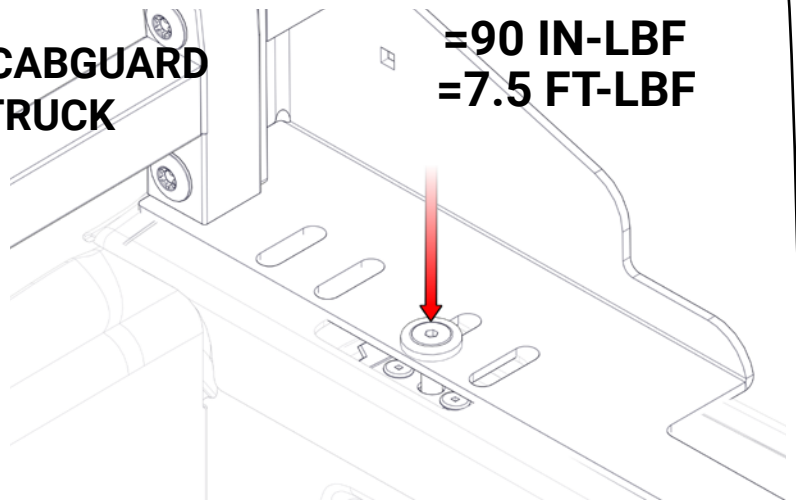

THIS STEP IS FOR INSTALLATIONS WITHOUT WESTCAN RAILCAPS ONLY. SKIP TO STEP 9 FOR INSTALLATIONS WITH WESTCAN RAILCAPS OR PROCEED TO STEP 11.

9.

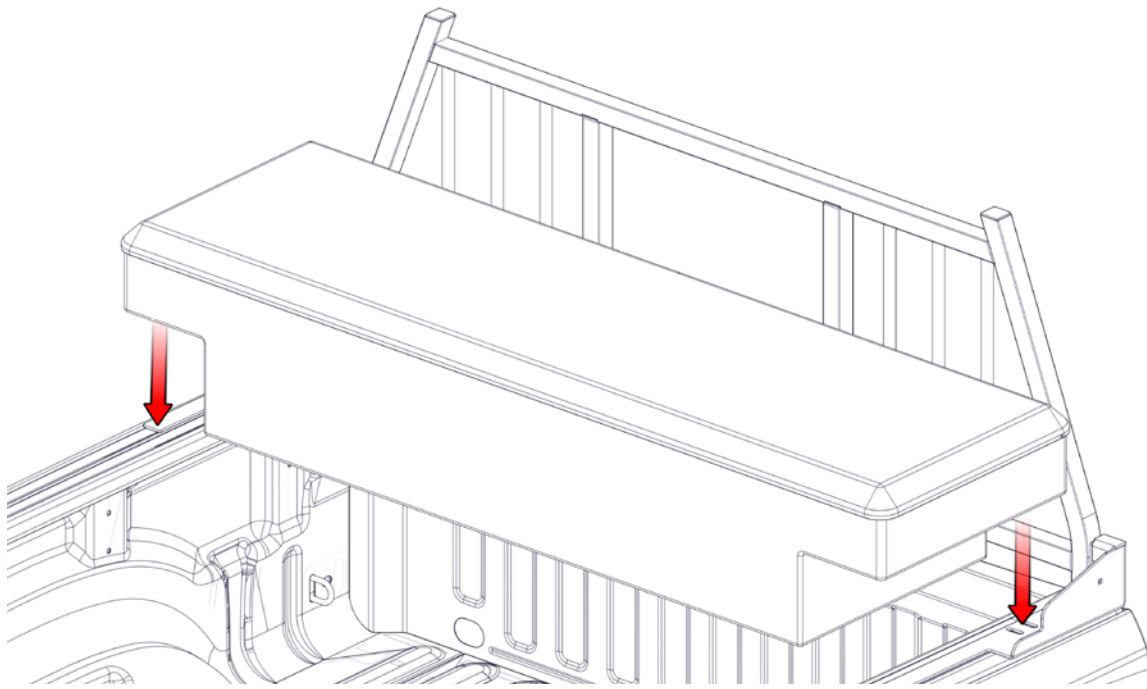

10. **RECOMENDED SPACING TO CABGUARD WITHOUT A REAR RACK. MEASURE WITH LID OPEN**

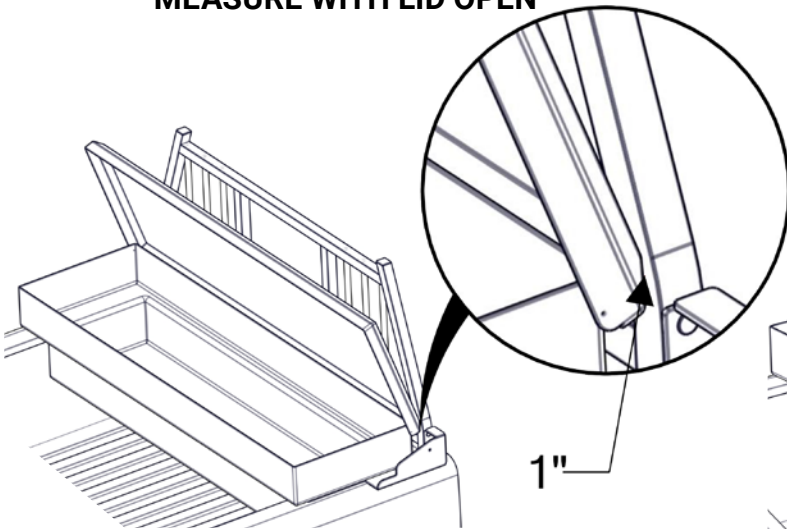

RECOMENDED SPACING TO CABGUARD WITH A REAR RACK. MEASURE WITH LID OPEN

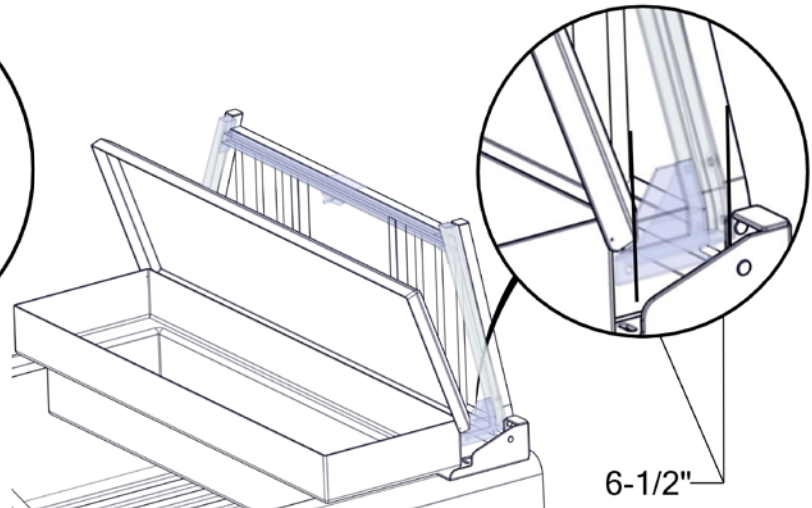

11. **THIS STEP IS FOR INSTALLATIONS WITHOUT WESTCAN RAILCAPS ONLY. SKIP TO STEP 12 FOR INSTALLATIONS WITH WESTCAN RAILCAPS.**

INSTALL YOUR CROSS OVER TOOL BOX AS PER THE MANUFACTURERS INSTRUCTIONS.

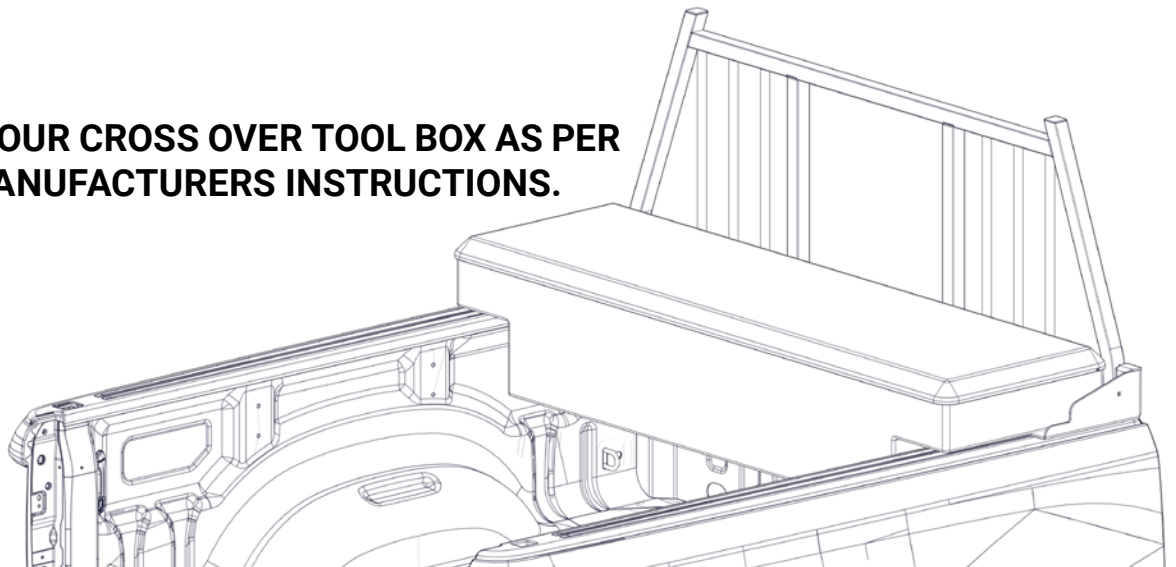

12.

TIE RAIL CUT DOWN PROCESS FOR INSTALLS WITHOUT A REAR RACK

SEE STEP 10 FOR SPACING PROCESS WITHOUT A REAR RACK. MEASURE TO THE END OF THE END OF THE TOOLBOX, OMITTING THE LID.

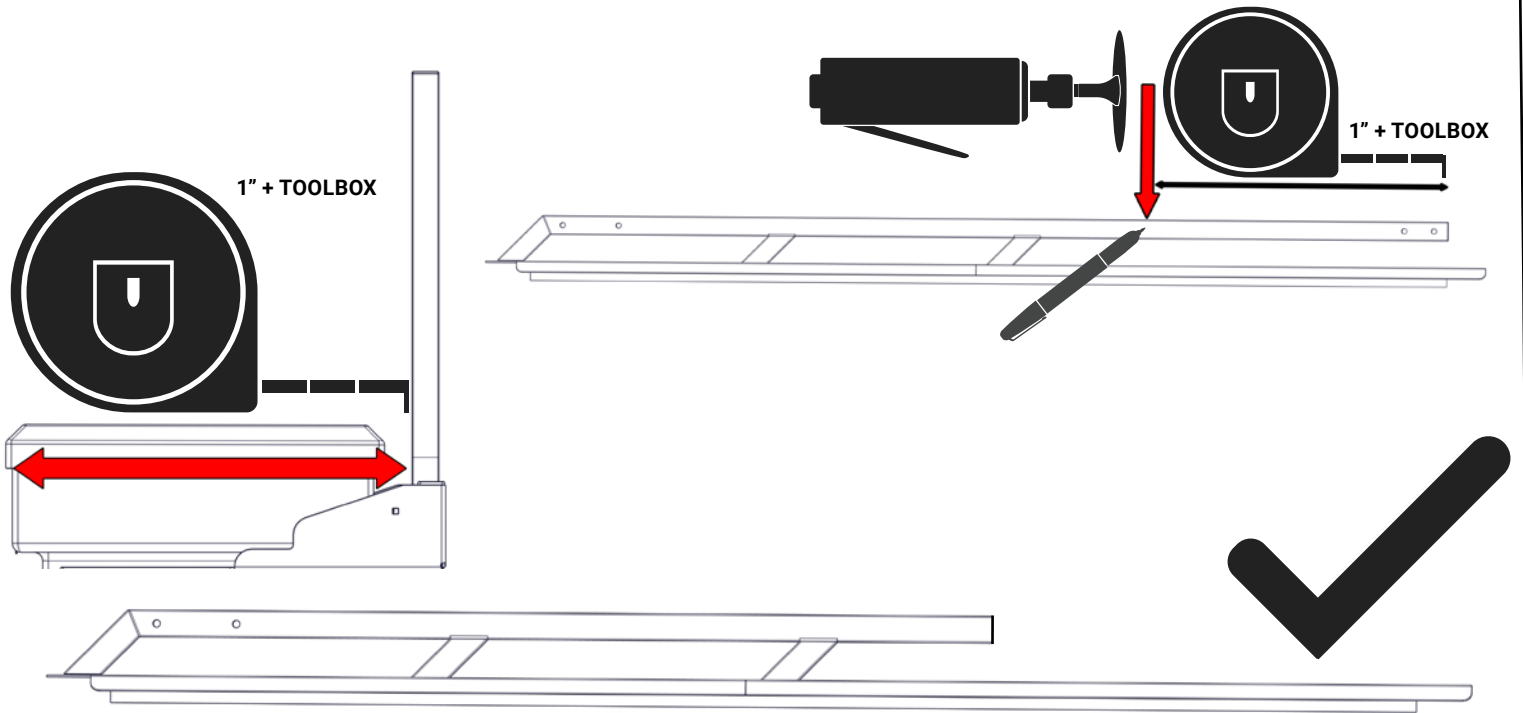

TIE RAIL CUT DOWN PROCESS FOR INSTALLS WITH A REAR RACK

SEE STEP 10 FOR SPACING PROCESS WITH A REAR RACK. MEASURE TO THE END OF THE END OF THE TOOLBOX, OMITTING THE LID.

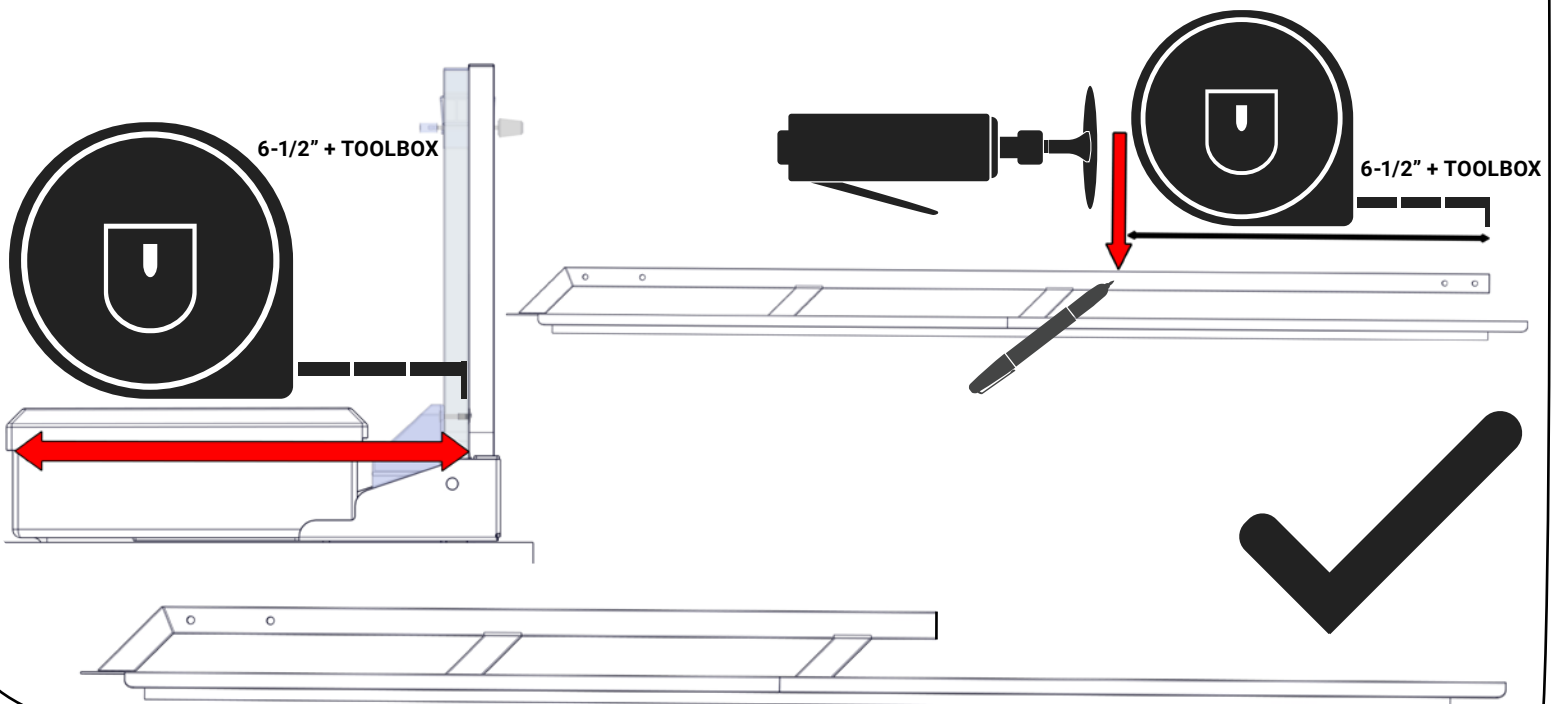

13.

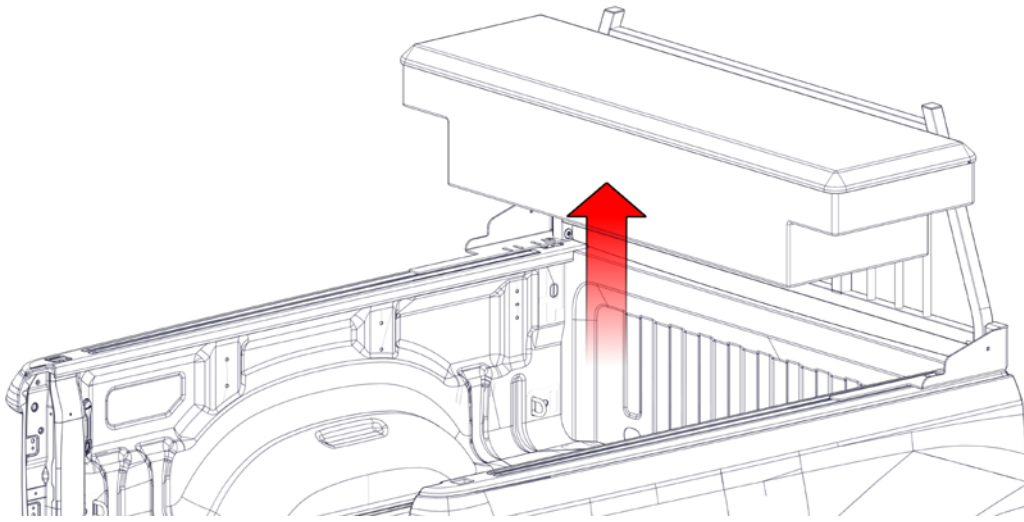

14.

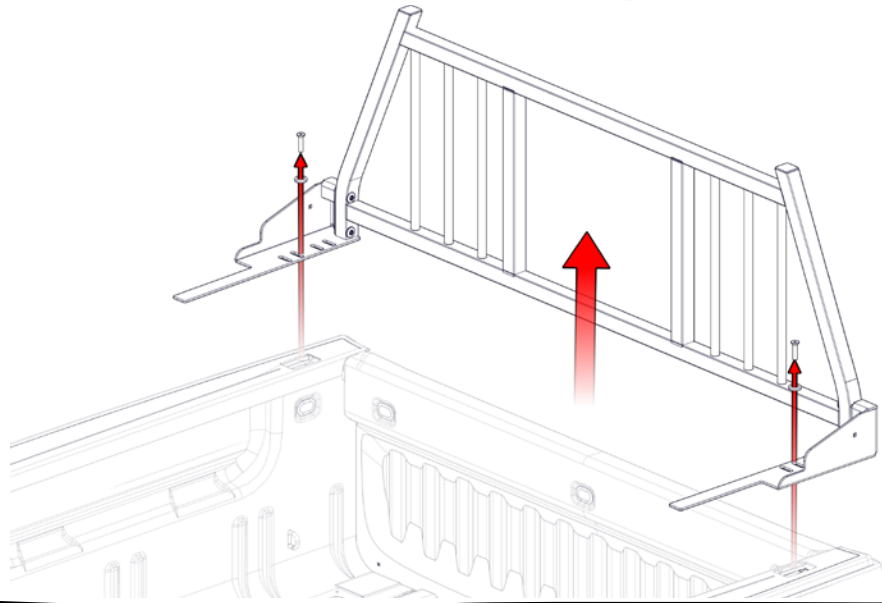

15. **INSTALL YOUR RAILCAPS WITH CUT DOWN TIE RAILS AS PER THE INSTRUCTIONS INCLUDED WITH THEM.**

16.

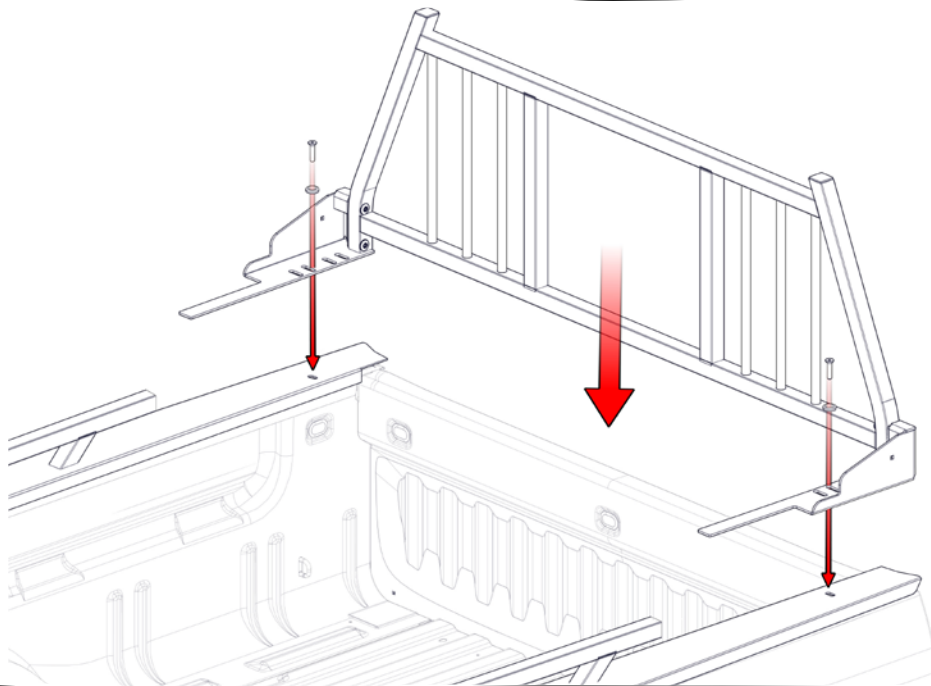

17.

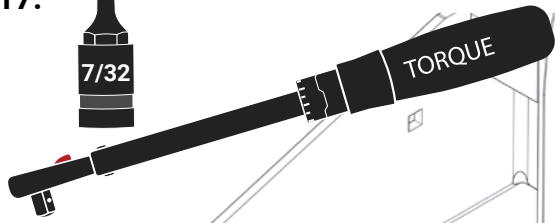

**CENTER CABGUARD
ON TRUCK**

**=90 IN-LBF
=7.5 FT-LBF**

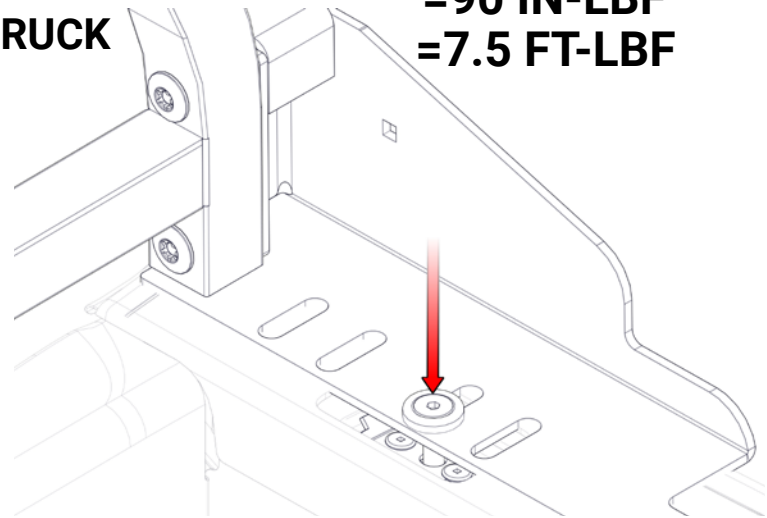
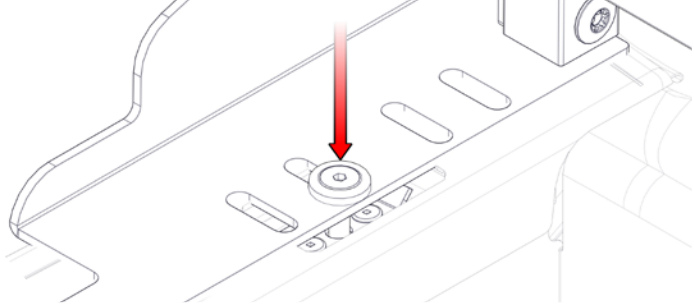

18.

**FOR INSTALLATIONS WITH WESTCAN REAR RACK ONLY. SKIP TO
STEP 19 FOR INSTALLATIONS WITHOUT WESTCAN REAR RACK.**

**HARDWARE INCLUDED WITH THE
REAR RACK INSTALL KIT**

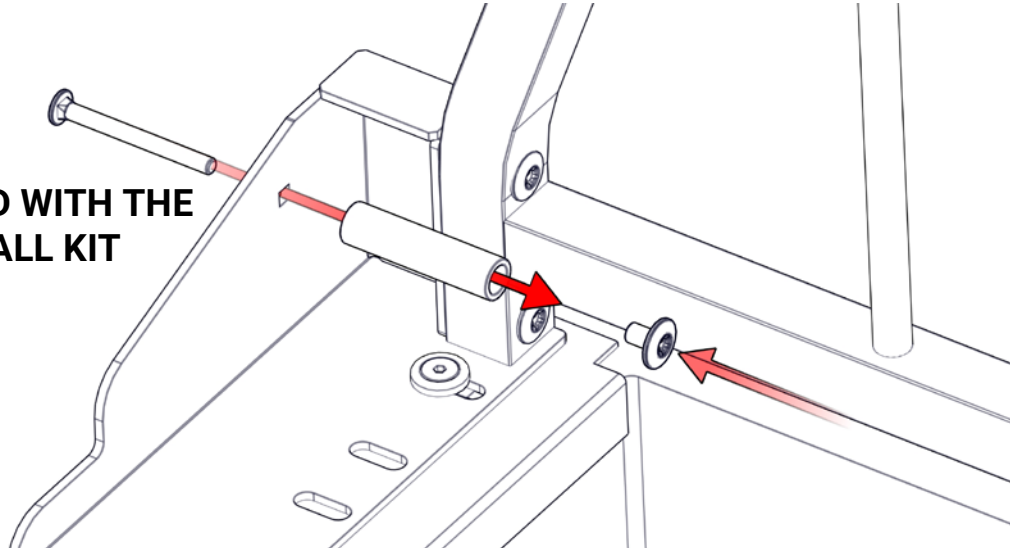

19.

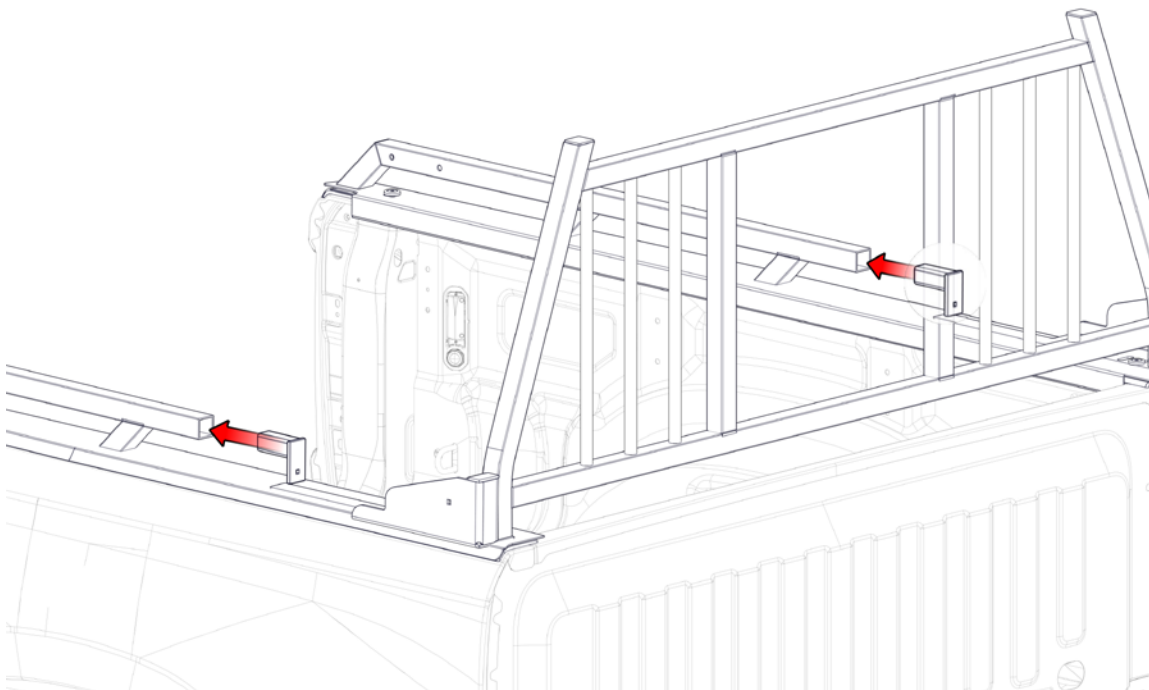

20.

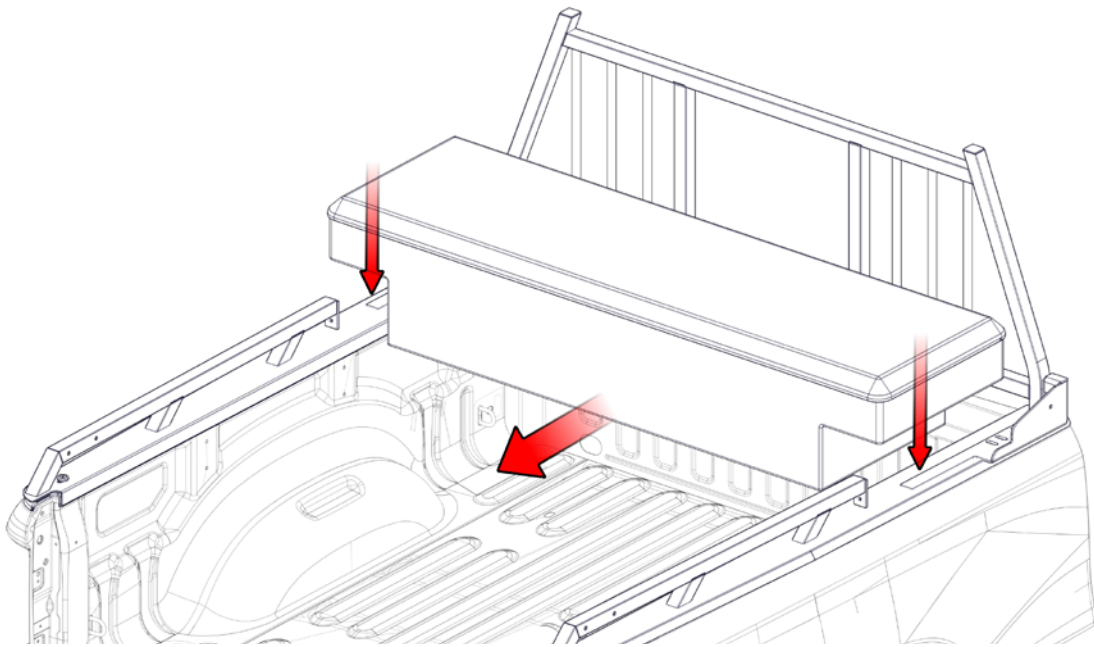

21.

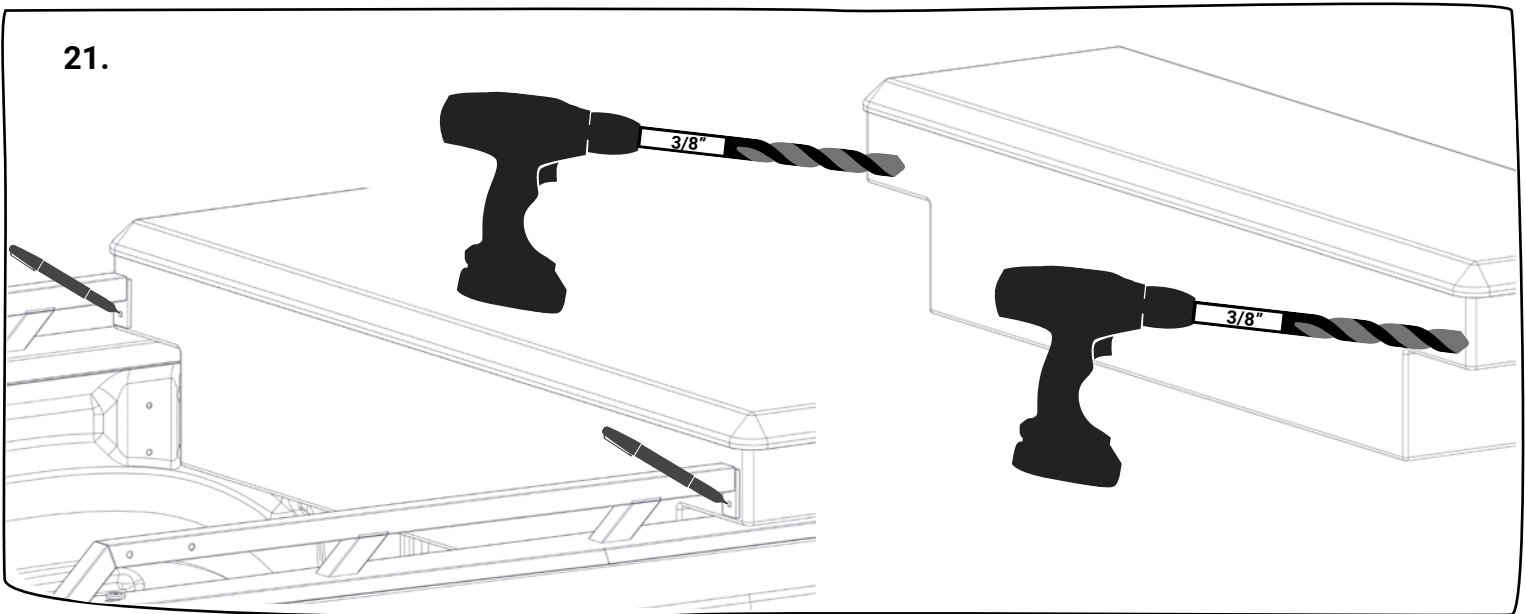

22.

5/16" Stainless Steel Flat Washer

5/16" X 1" Stainless Steel Carriage Bolt

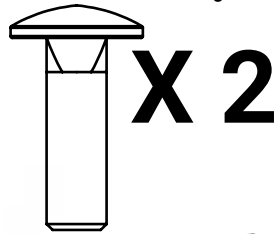
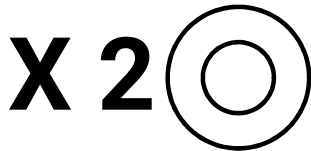

5/16" Stainless Steel Nylock Nut

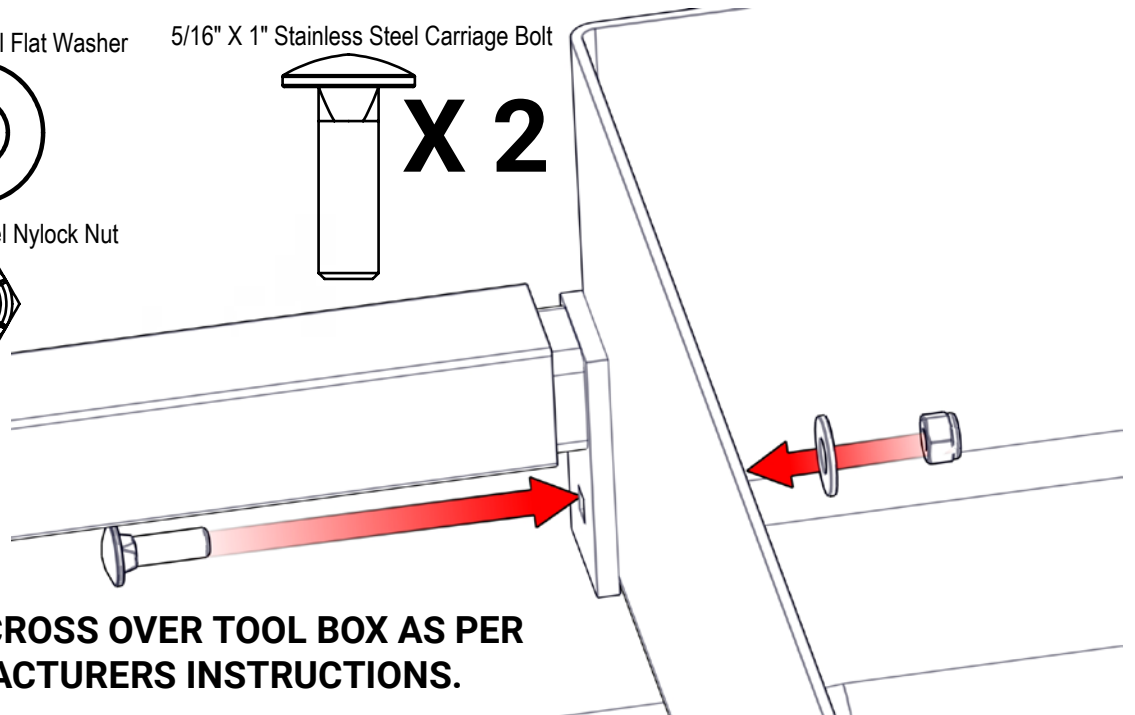

INSTALL YOUR CROSS OVER TOOL BOX AS PER THE MANUFACTURERS INSTRUCTIONS.

IF YOUR INSTALLING A LED CABGUARD
PLEASE REFER TO THE WIRING PIN OUT
BELOW.

- **Red = Left Turn Signal**
- **Yellow = Right Turn Signal**
- **Black = Tail / Marker Lights**
- **Blue = Back Up Lights**
- **White = Chassis Ground**

PRINT AT A 1:1 SCALE AND CUT OUT. FOLD ALONG THE DOTTED LINE.

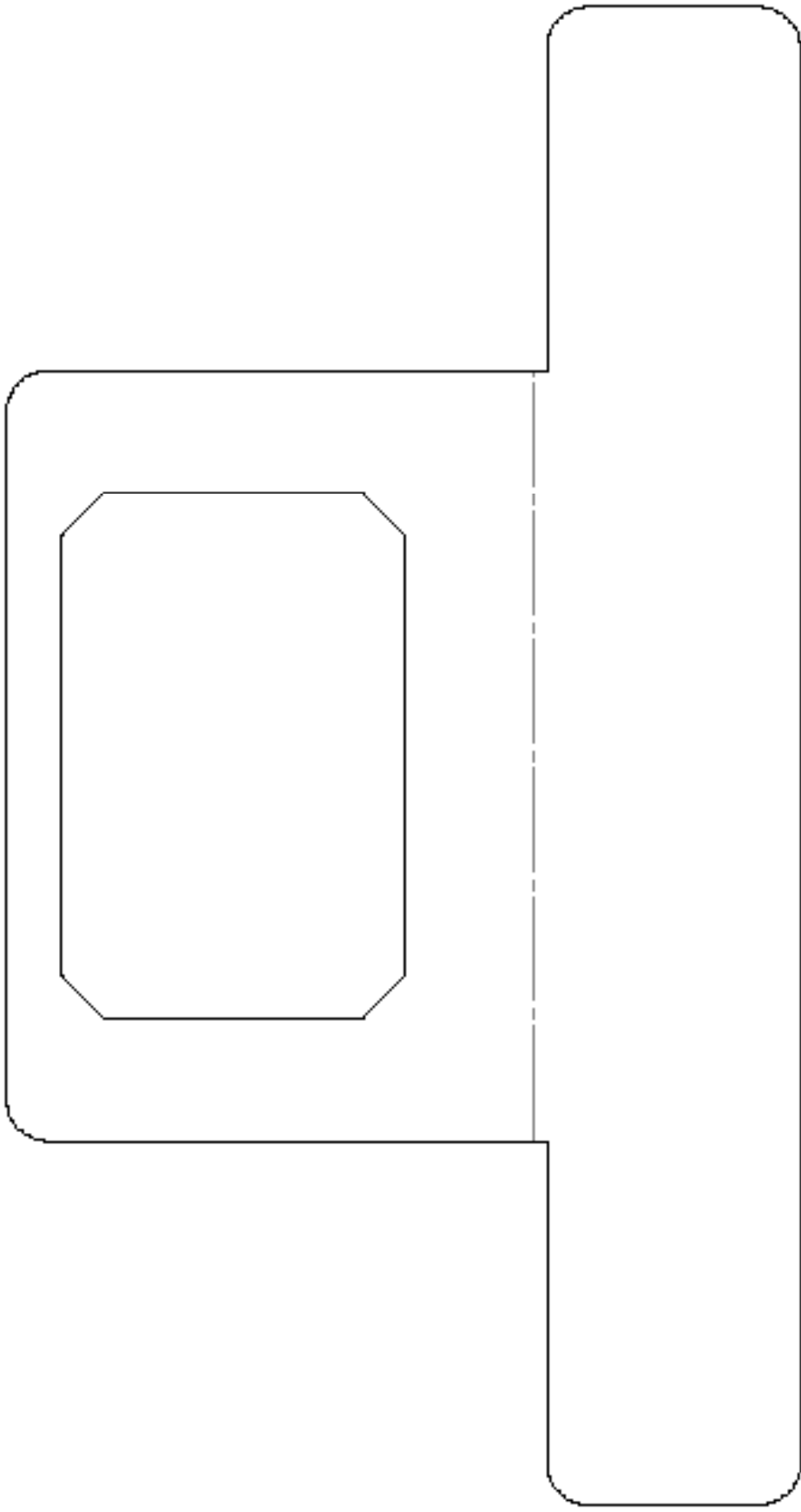

WESTCAN

MANUFACTURING LTD.

DESCRIPTION: Chevroler front shales pocket cutout template

ROW:	MATERIAL:	SHEET OF 1
DESCRIPTION:	PART NR:	
DATE:		

DATE:	TIME:
BY:	BY:

THE INFORMATION CONTAINED HEREIN IS THE PROPERTY OF WESTCAN MANUFACTURING LTD. AND IS NOT TO BE REPRODUCED OR TRANSMITTED IN ANY FORM OR BY ANY MEANS, ELECTRONIC OR MECHANICAL, INCLUDING PHOTOCOPYING, RECORDING, OR BY ANY INFORMATION STORAGE AND RETRIEVAL SYSTEM.