

INSTALLATION INSTRUCTIONS: 2015+ F-150 CAB GUARD

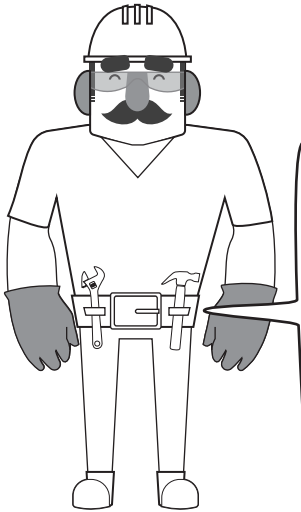

TOOLS NEEDED:

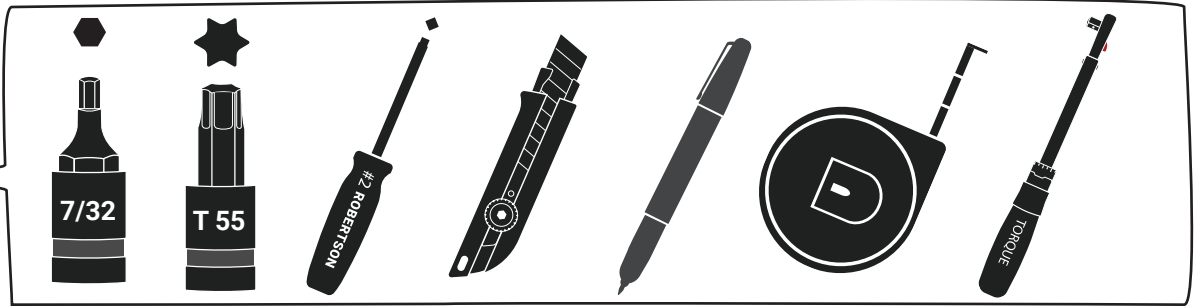

CAUTION:

This equipment is designed to be professionally installed by an approved up-fitter. Always wear ear and eye protection and exercise caution when installing Westcan products.

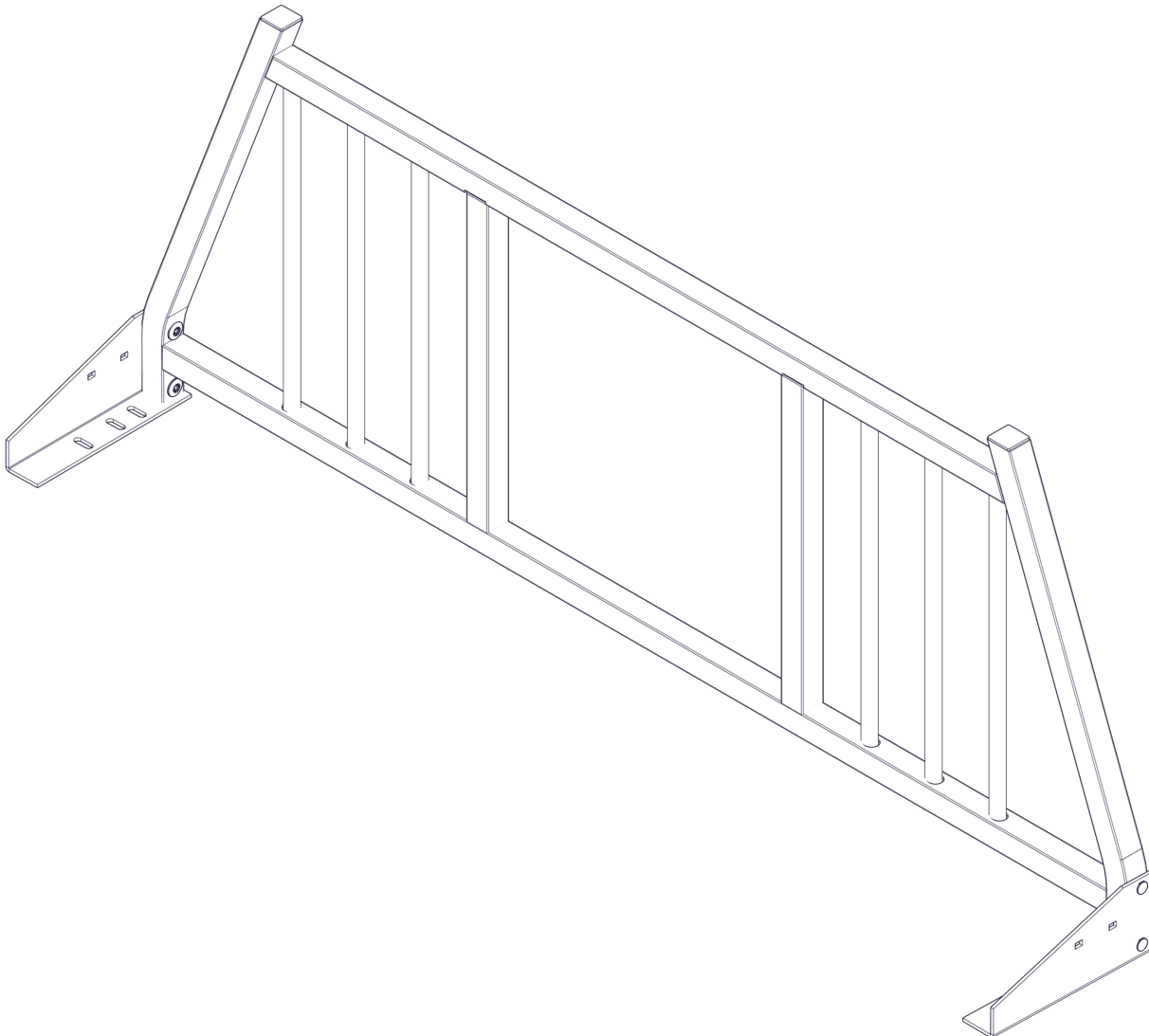

PREPARATION:

1. Ensure all parts are present and accounted for before installation. **Begin the installation of your cabguard before your rail caps.** Plan the location of your installation ahead of time and make sure your installation location does not impede any other components you are installing or damage the safety and functionality of your vehicle.
2. Exercise extreme diligence when drilling holes into a motor vehicle. Increasing complexity and model year changes can alter the location of fuel, hydraulic and electrical lines. Please visually inspect all locations prior to drilling.
3. Re-Torque the 3/8" x 1-3/4" Stainless Steel Countersink Bolt every 3 month.

BOX CAP PREPARATION:

Some truck box lengths require the plastic truck box caps to be cut to expose the stake pocket cutout. Use the provided template as a guide for cutting the box cap (see last page). Exercise caution when cutting caps to avoid injury.

NOTE:

WHEN THE HOLD ICON IS USED TO TURN A FASTENER, TIGHTEN THEM FINGER TIGHT.

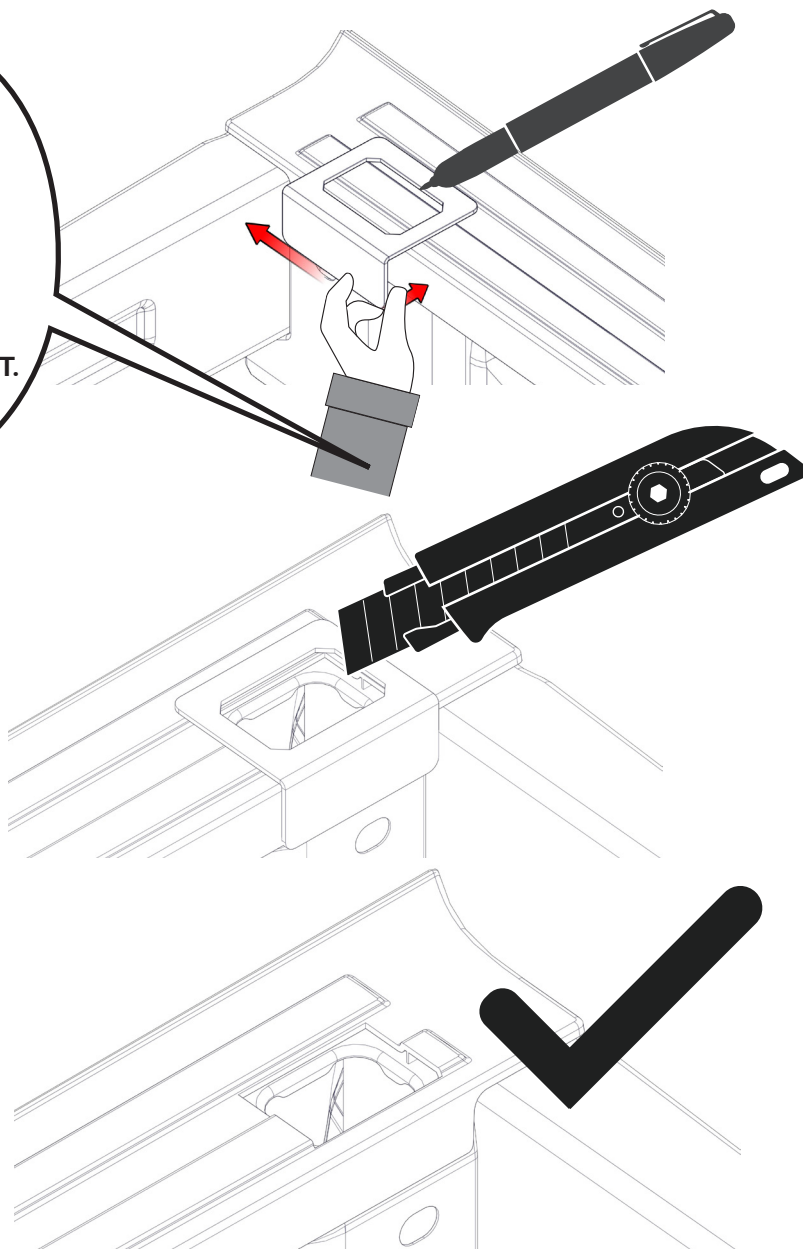

1

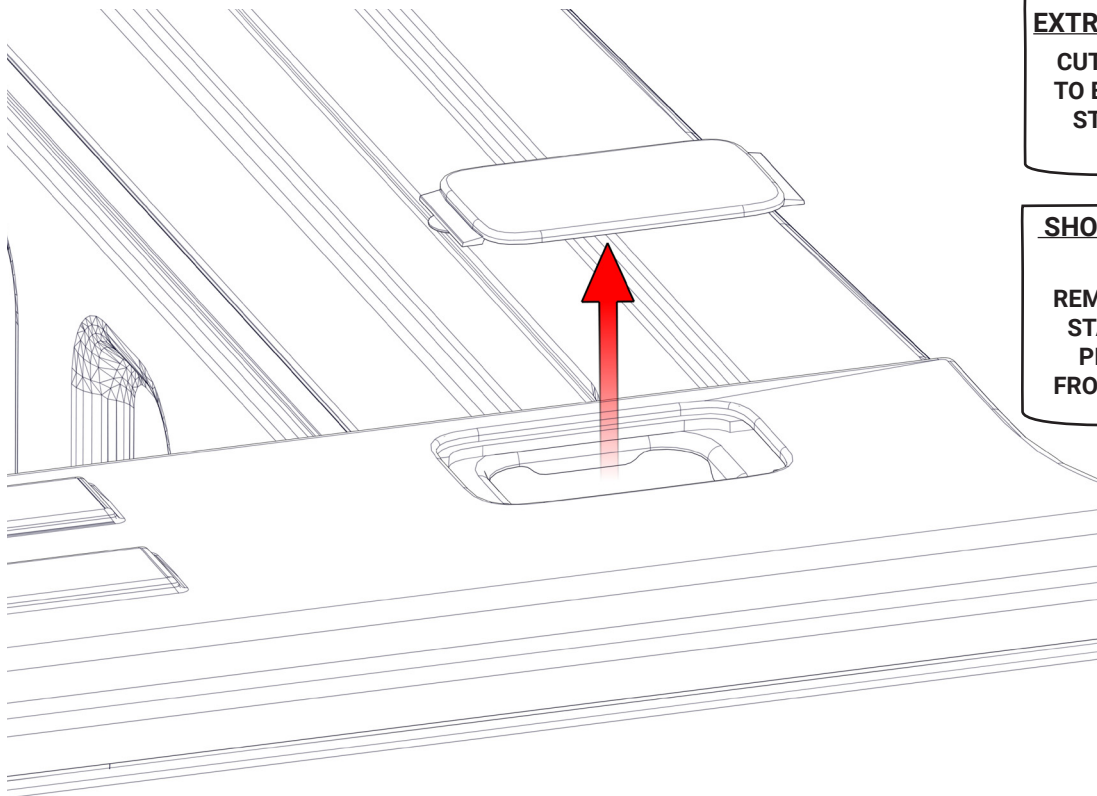
**EXTRA SHORT BOX**

CUT PLASTIC CAP
TO EXPOSE FRONT
STAKE POCKET

**SHORT AND LONG
BOX**

REMOVE PLASTIC
STAKE POCKET
PLUGS FROM
FRONT POSITION.

2

EXTRA SHORT BOX, SHORT BOX AND LONG BOX

3/8 X 1 3/4 Stainless Steel Counter Sink Bolt

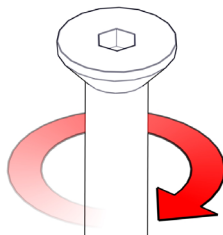
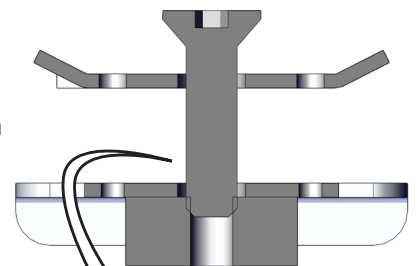
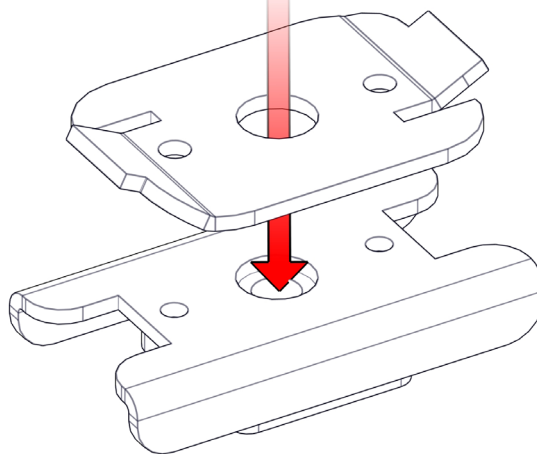
**X 2****X 2**

THIS GAP IS
REQUIRED FOR
INSTALLATION

3.

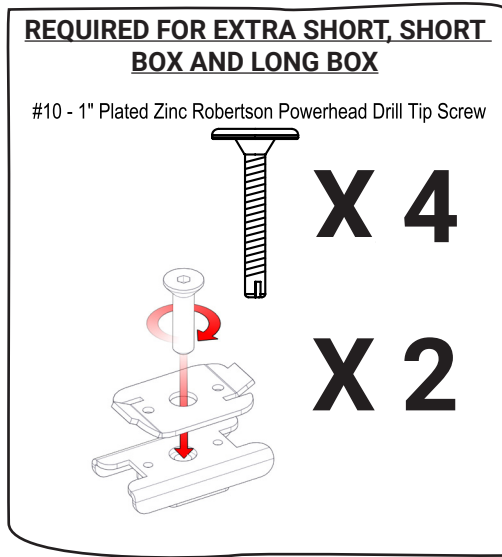

3.1

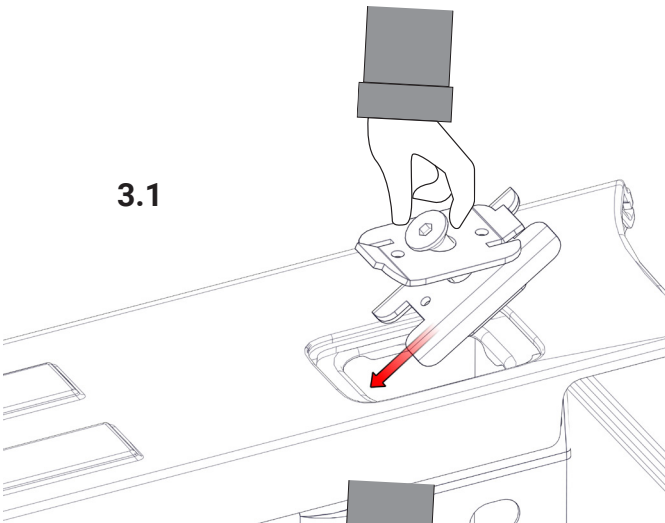

3.2

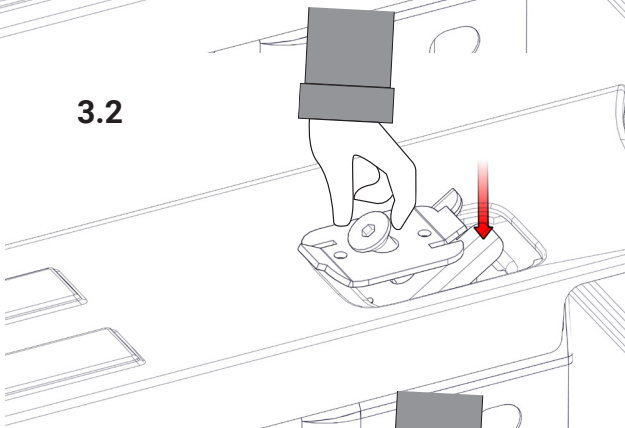

3.3

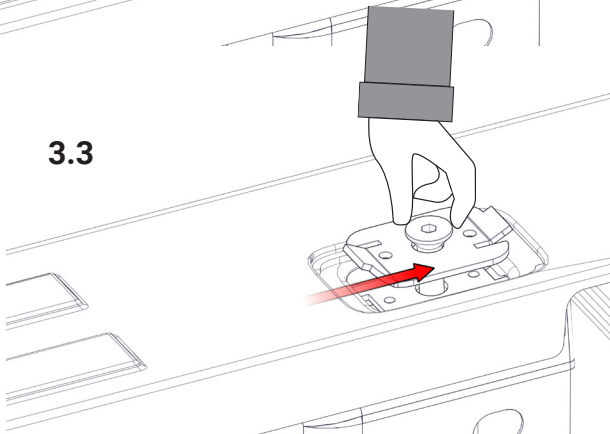

3.4

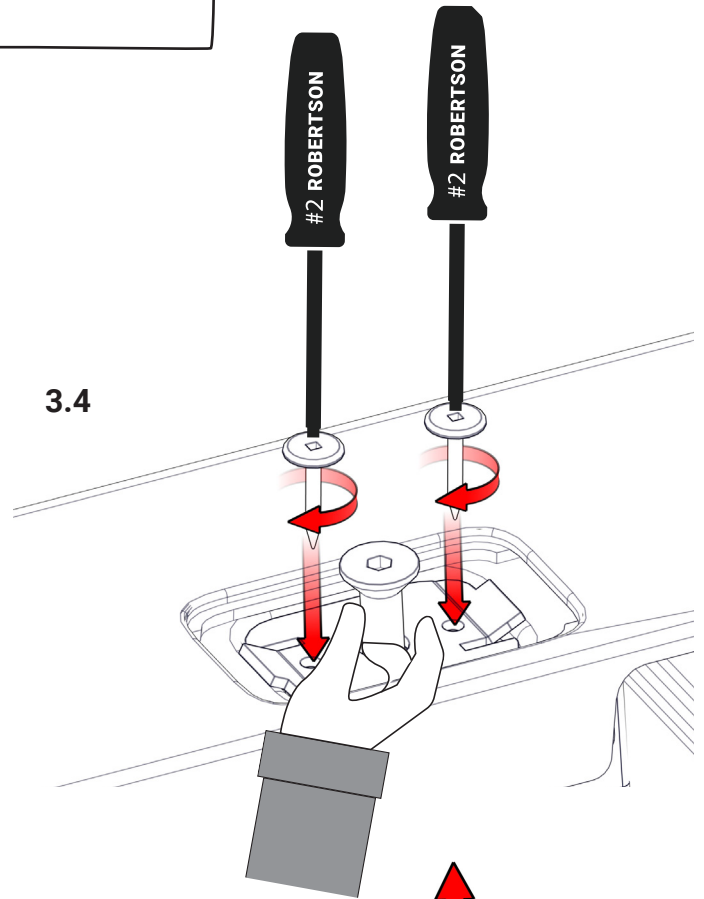

3.5

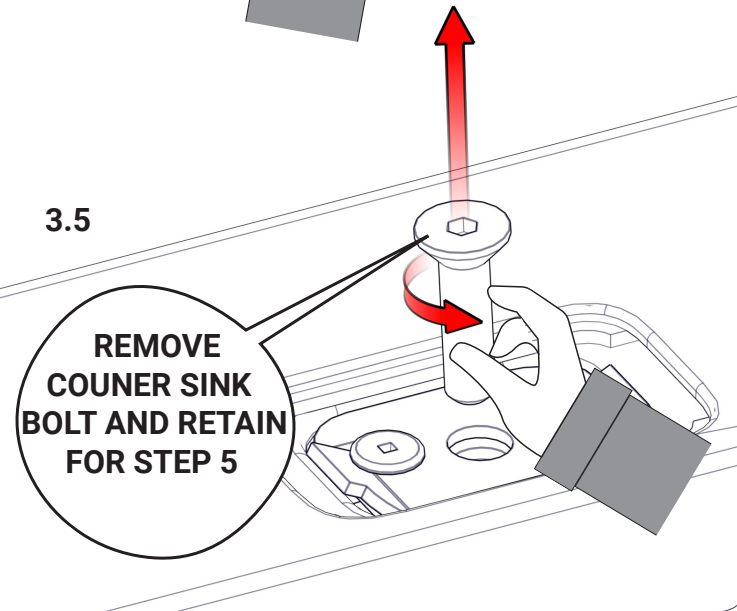

IF REQUIRED, INSTALL YOU RAILCAPS PRIOR TO PROCEEDING WITH STEP 4 OR GO TO STEP 13 FOR INSTALLATIONS WITHOUT RAILCAPS.

4.

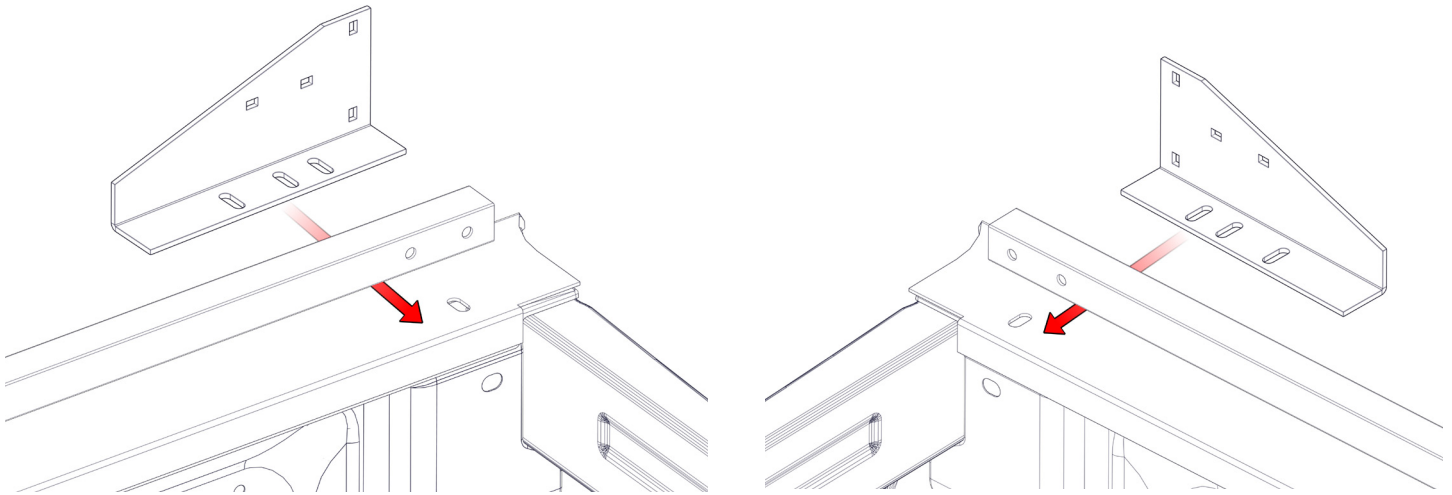

5.

3/8 X 1 3/4 Stainless Steel Counter Sink Bolt

3/8" Stainless Steel Finishing Washer

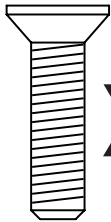

X 2

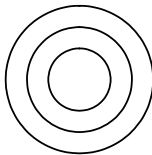

X 2

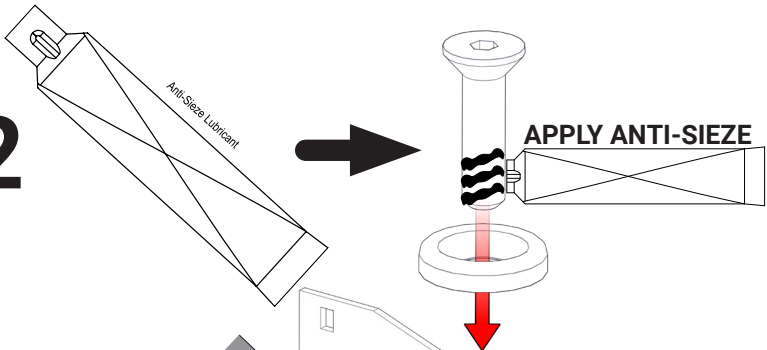

APPLY ANTI-SIEZE

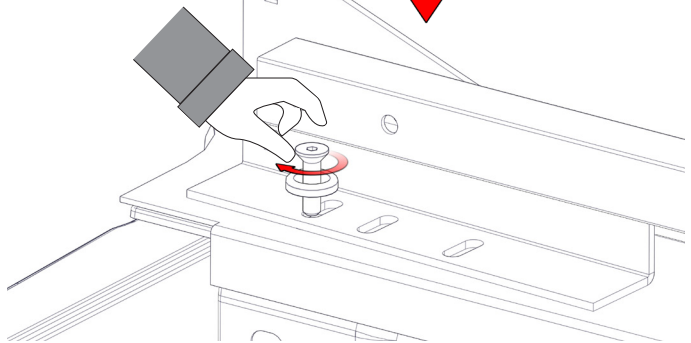
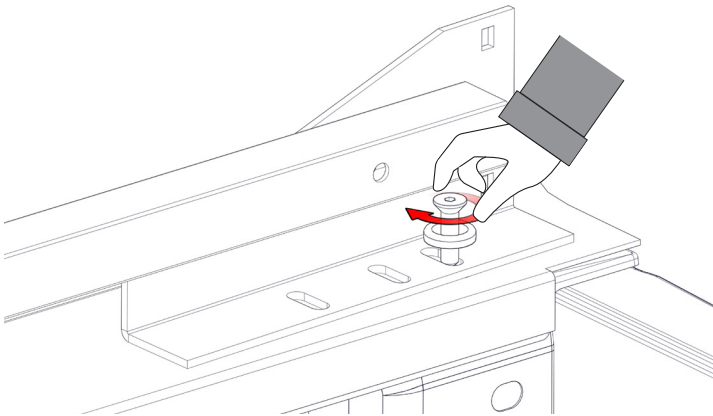

6.

HARDWARE FOR STEP 6-7 IS INCLUDED WITH YOUR RAILCAPS.



5/16 X 1-1/2 Stainless Steel Carriage Bolt

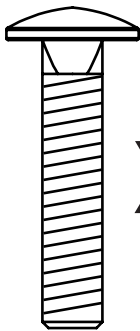

X 4

7.

5/16" X 5/8" Zinc Plated Camtainer Nut

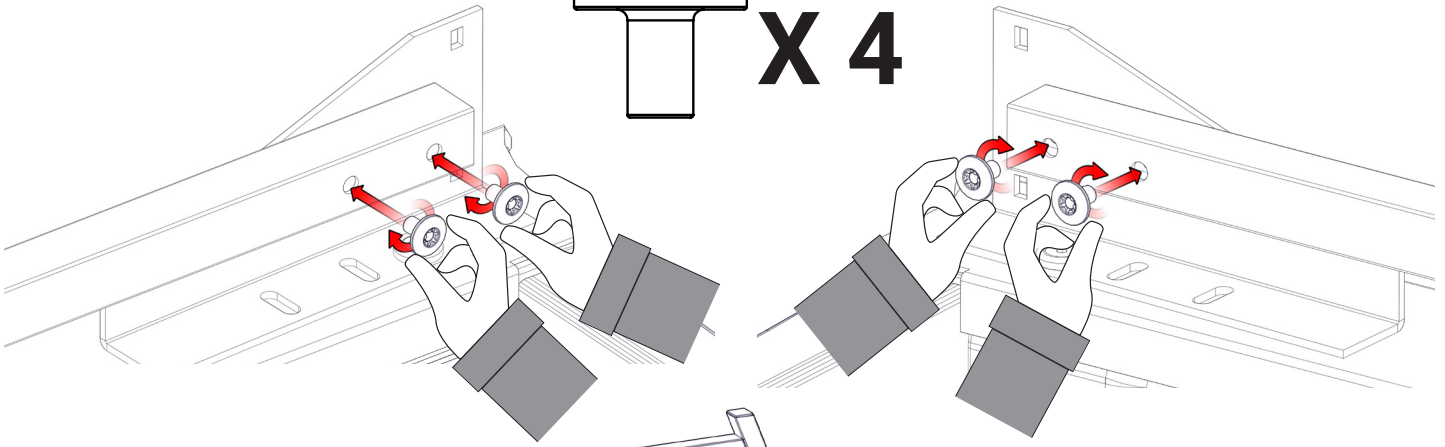

8.

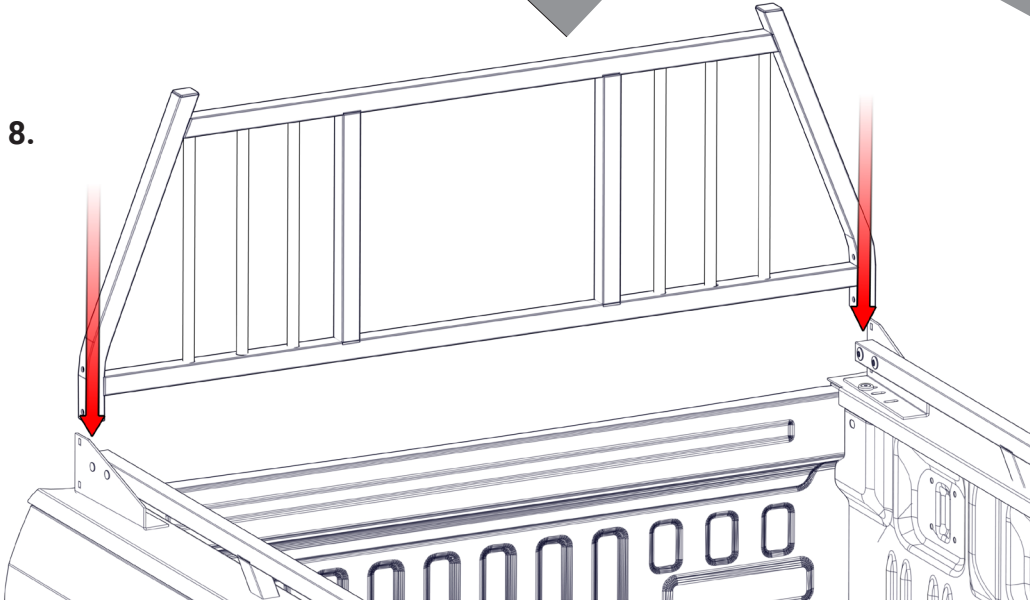

9.

5/16" X 5/8" Zinc Plated Camtainer Nut

5/16 X 1-1/2 Stainless Steel Carriage Bolt

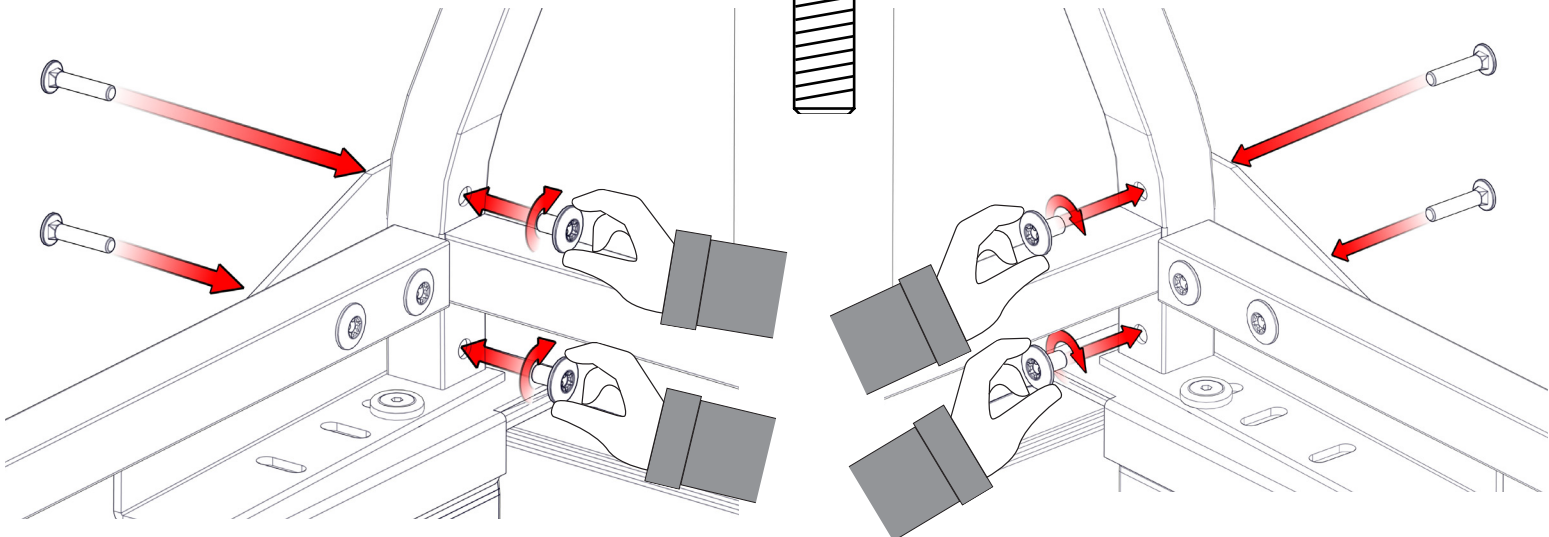
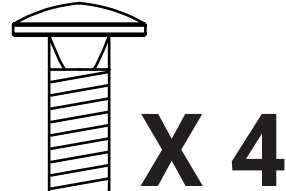

10.

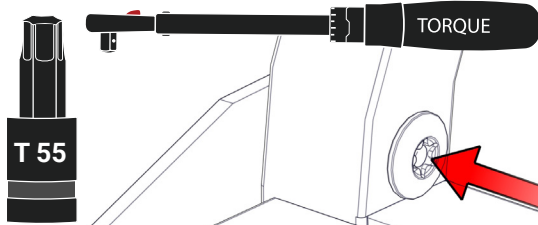

**=236 IN-LBF
=19.5 FT-LBF**

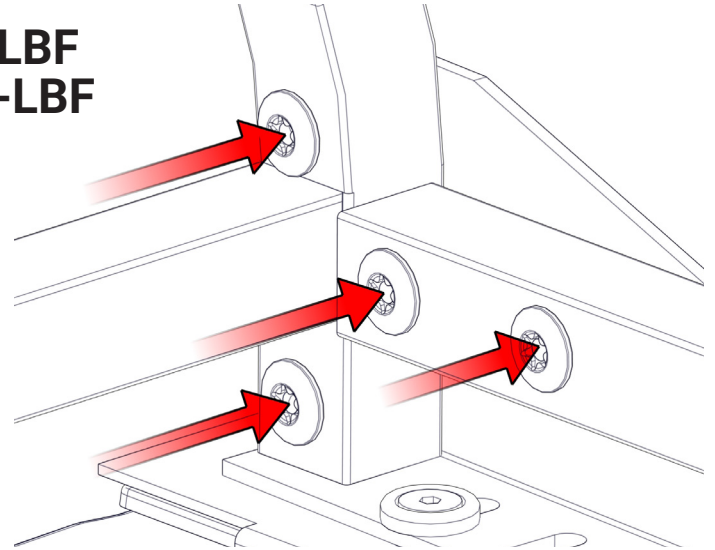

11.

CENTER CAB GUARD ON TRUCK BOX.

12.

**=90 IN-LBF
=7.5 FT-LBF**



**INSTALLATION OF CABGUARD
WITH RAIL CAPS COMPLETE.
SEE STEP 19 FOR LED
CABGUARD WIRING PINOUT
(IF EQUIPPED).**

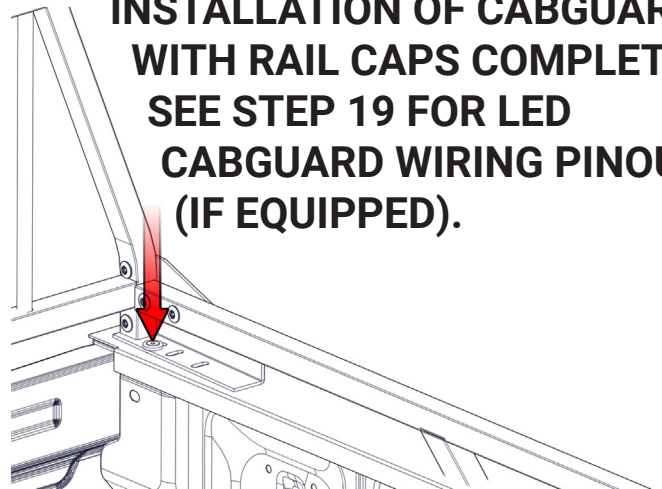

13.

3/8 X 1 3/4 Stainless Steel Counter Sink Bolt

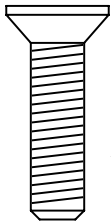

3/8" Stainless Steel Finishing Washer

X 2  **X 2**

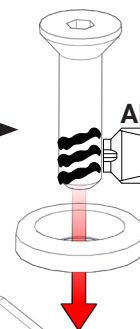
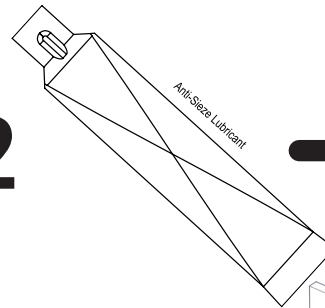

APPLY ANTI-SIEZE

**INSTALLATION WITHOUT
RAILCAP.**

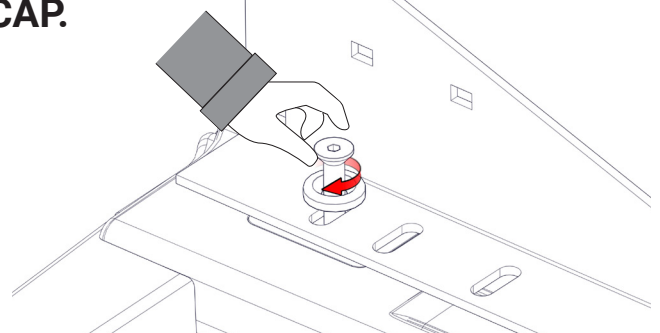
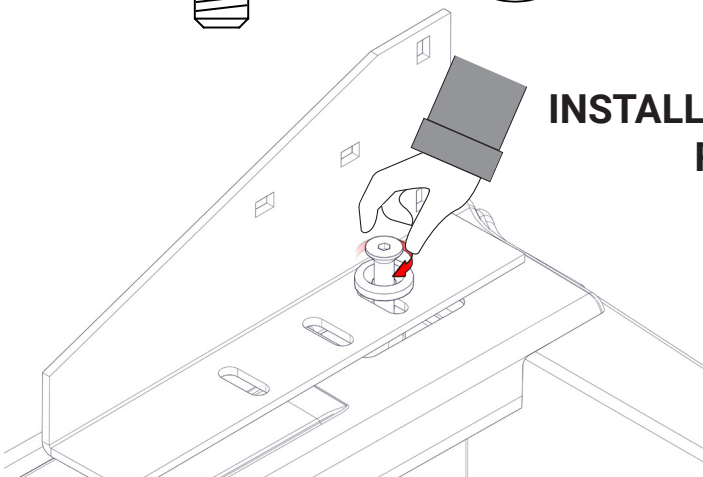

14.

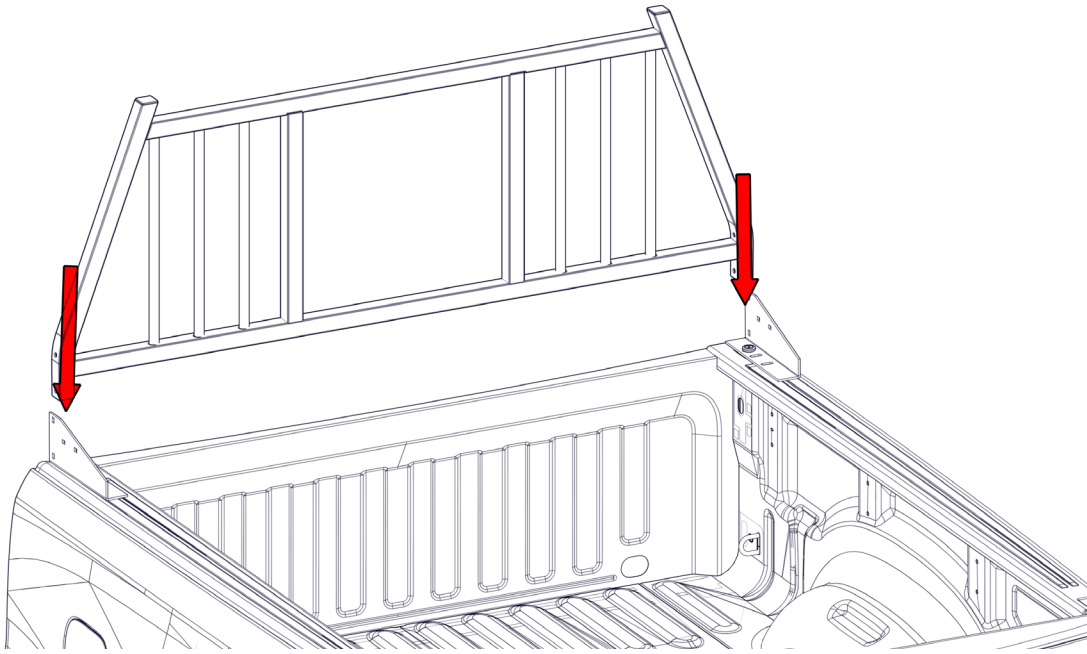

15.

5/16" X 5/8" Zinc Plated Camtainer Nut

5/16 X 1-1/2 Stainless Steel Carriage Bolt

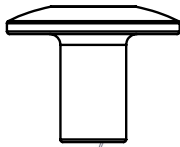

X 4

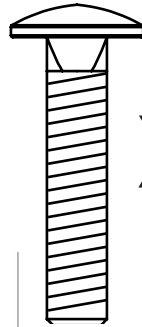

X 4

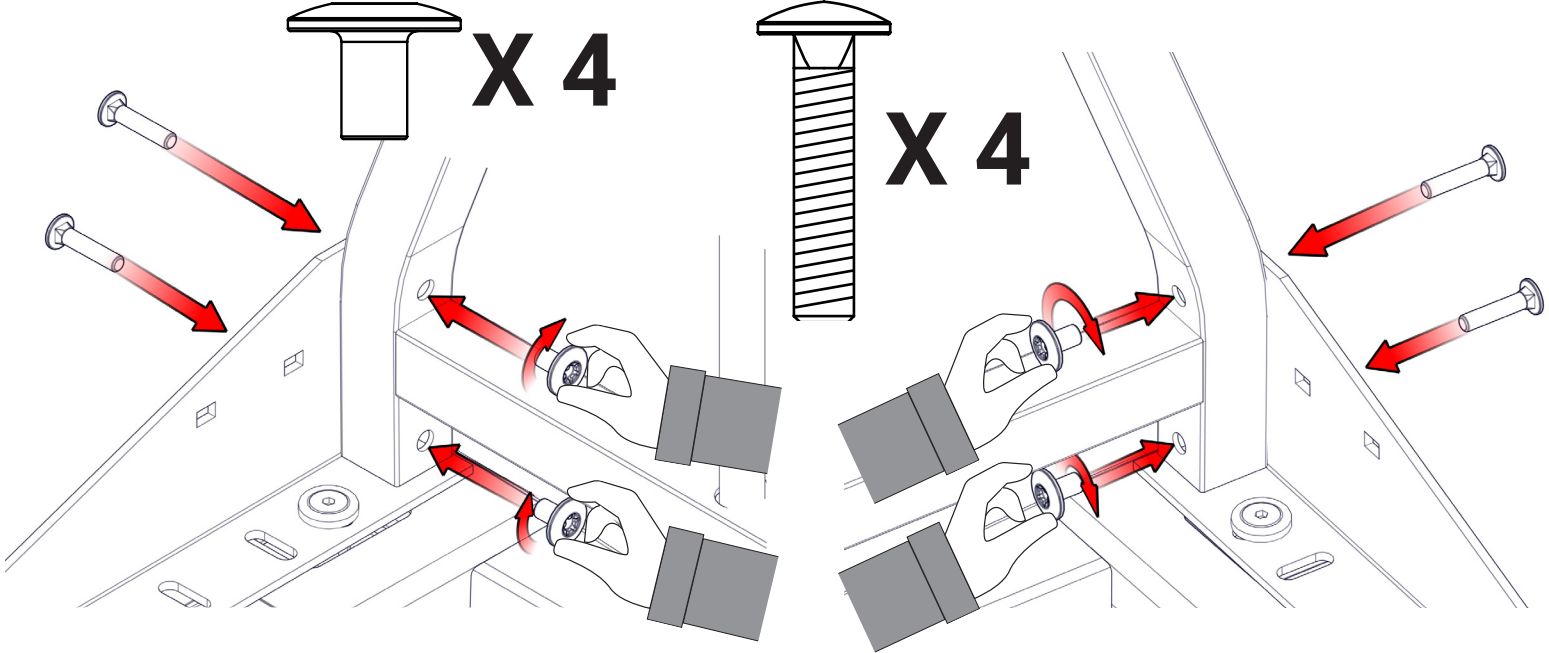

16.

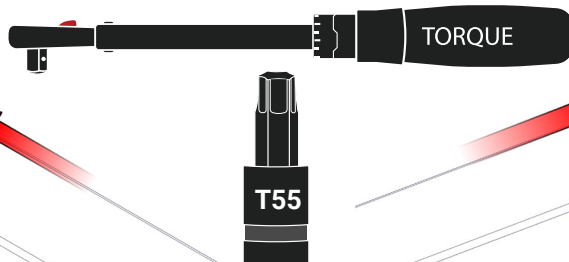

**=90 IN-LBF
=7.5 FT-LBF**

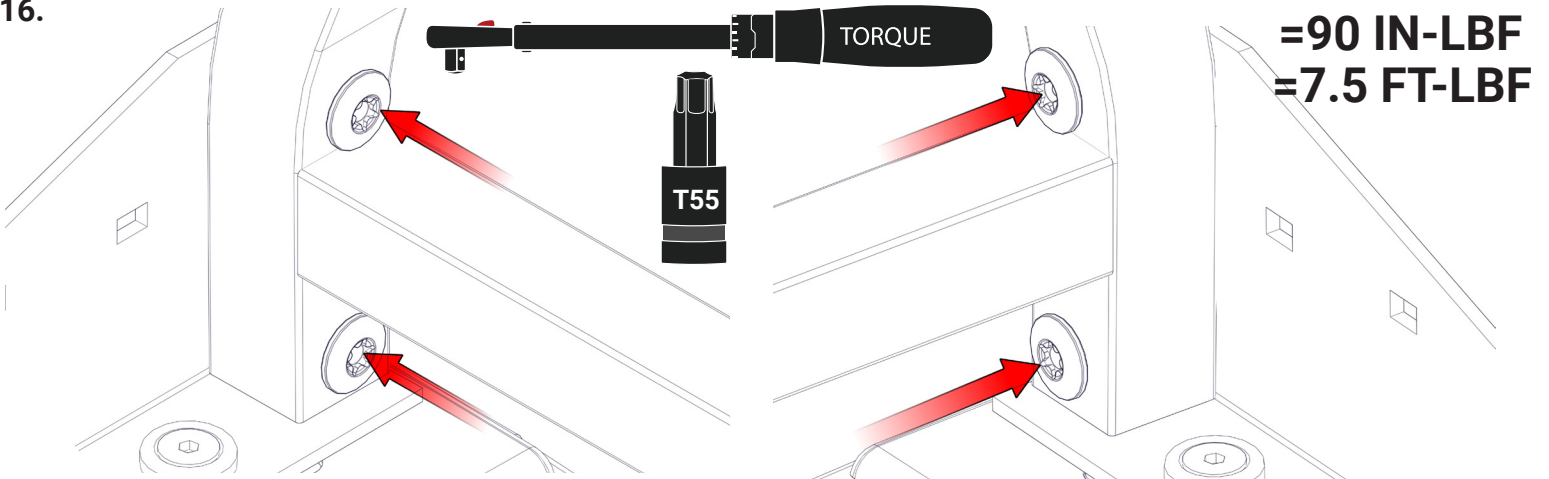

17. **CENTER CAB GUARD ON TRUCK BOX AND
INSTALL A SECONDARY HOLD DOWN KIT.**

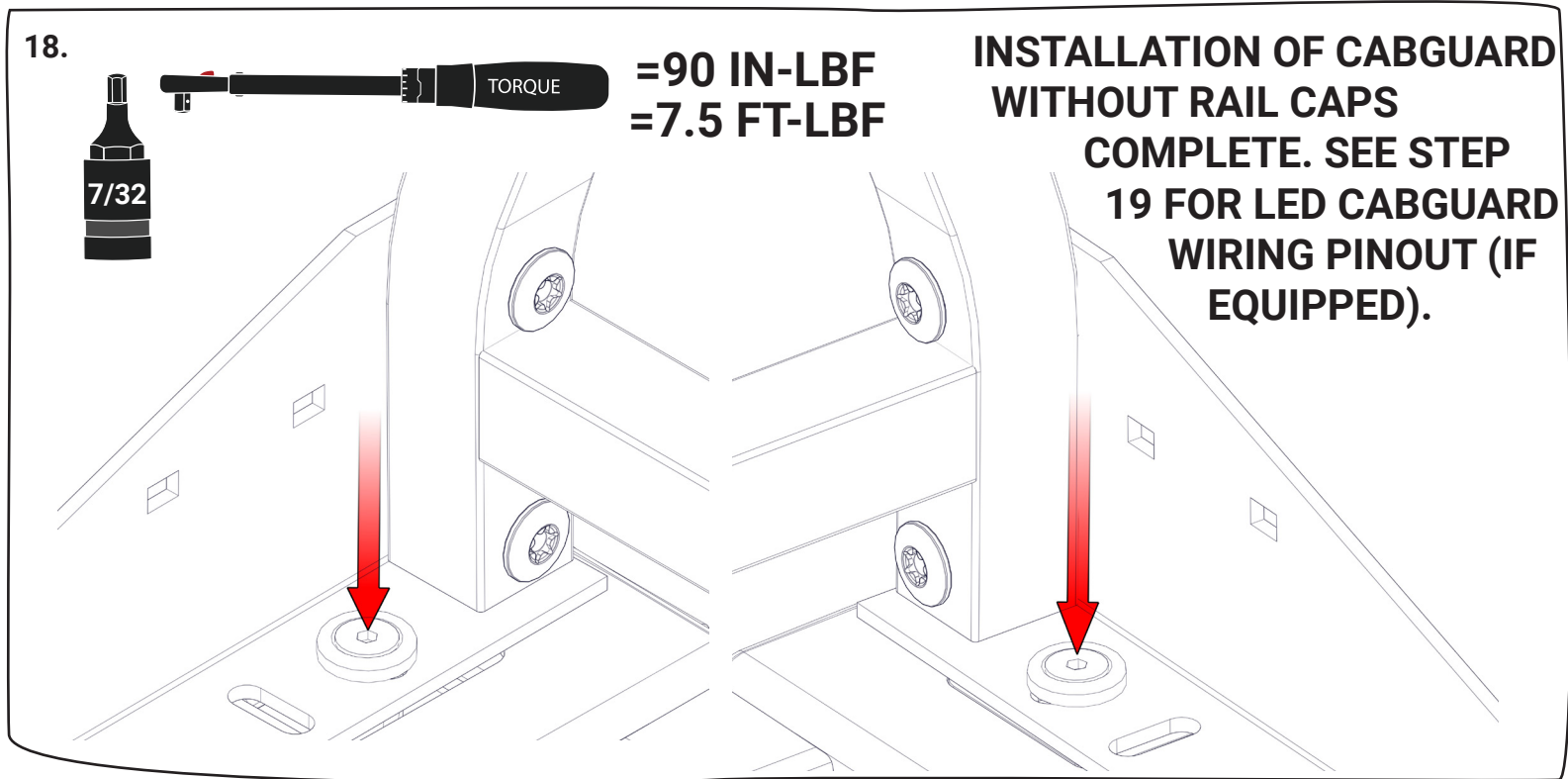

19.

**IF YOUR INSTALLING A LED CABGUARD
PLEASE REFER TO THE WIREING PINOUT
BELOW.**

- **Red = Left Turn Signal**
- **Yellow = Right Turn Signal**
- **Black = Tail / Marker Lights**
- **Blue = Back Up Lights**
- **White = Chassis Ground**

PRINT OUT AT A 1:1 SCALE AND CUT OUT. FOLD ALONG THE DOTTED LINE.

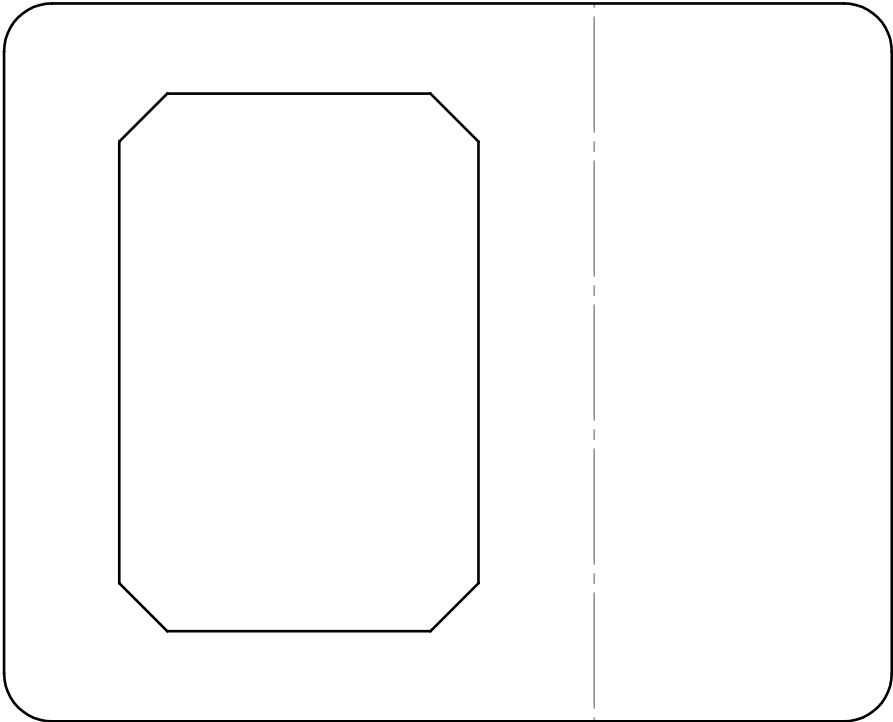

WESTCAN
MANUFACTURING LTD.

DESCRIPTION:F-150 Front Stake Pocket Cutout Template.

UNLESS OTHERWISE SPECIFIED, DIMENSIONS ARE IN INCHES				Rev:		
TOLERANCE				DRAWN BY: DTocher		
ANG.	FRAC.	.XX	.XXX	DATE: 14/05/18	MATERIAL:	Sheet 1 OF 1
± 0.5°	1/32"	±0.01"	±0.005"		PART NR:	

PROPRIETARY AND CONFIDENTIAL
THE INFORMATION CONTAINED IN THIS
DRAWING IS THE SOLE PROPERTY OF
WESTCAN MANUFACTURING LTD. ANY
REPRODUCTION IN PART OR AS A WHOLE
WITHOUT THE WRITTEN PERMISSION OF
WESTCAN MANUFACTURING LTD IS
PROHIBITED.