

INSTALLATION INSTRUCTIONS: 2015+ F-150 RAIL CAP

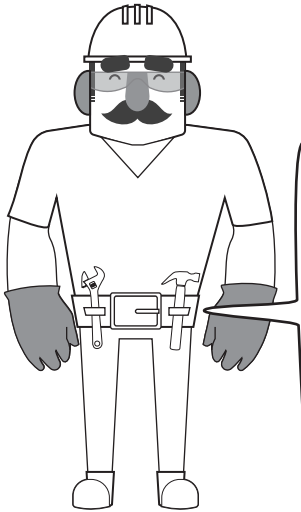

TOOLS NEEDED:

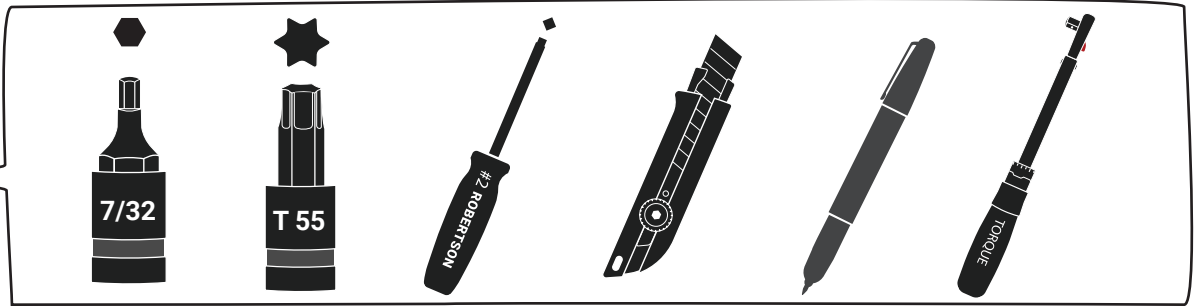

CAUTION:

This equipment is designed to be professionally installed by an approved up-fitter. Always wear ear and eye protection and exercise caution when installing Westcan products.

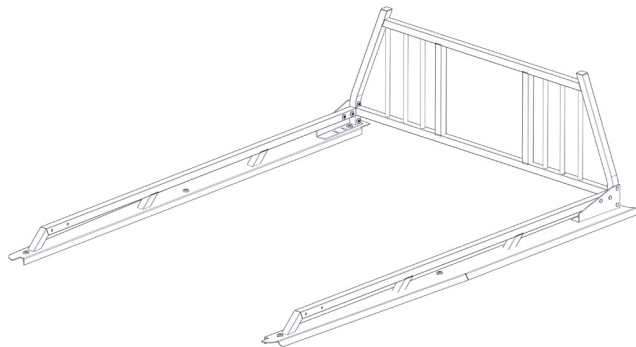

LONG BOX

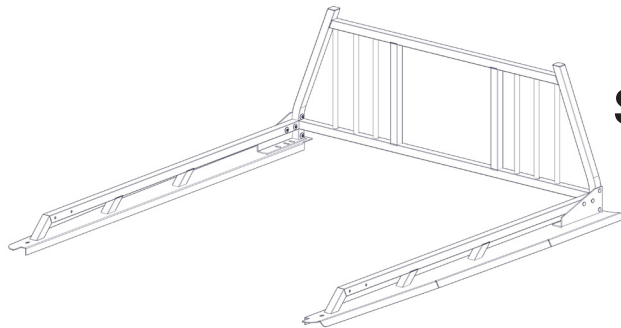

SHORT BOX

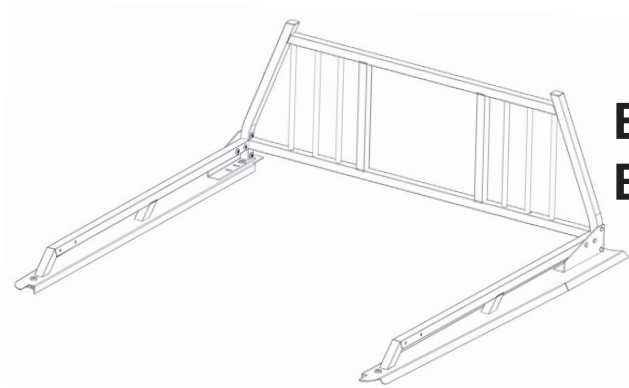

EXTRA SHORT BOX

PREPARATION:

1. Ensure all parts are present and accounted for before installation. **Begin the installation of your cabguard before your rail caps.** Plan the location of your installation ahead of time and make sure your installation location does not impede any other components you are installing or damage the safety and functionality of your vehicle.
2. Exercise extreme diligence when drilling holes into a motor vehicle. Increasing complexity and model year changes can alter the location of fuel, hydraulic and electrical lines. Please visually inspect all locations prior to drilling.
3. Re-Torque the 3/8" x 1-3/4" Stainless Steel Countersink Bolt every 3 month.

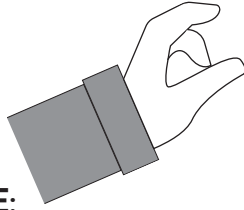

NOTE:
WHEN THE HOLD ICON IS
USED TO TURN A FASTENER,
TIGHTEN THEM FINGER TIGHT.

1

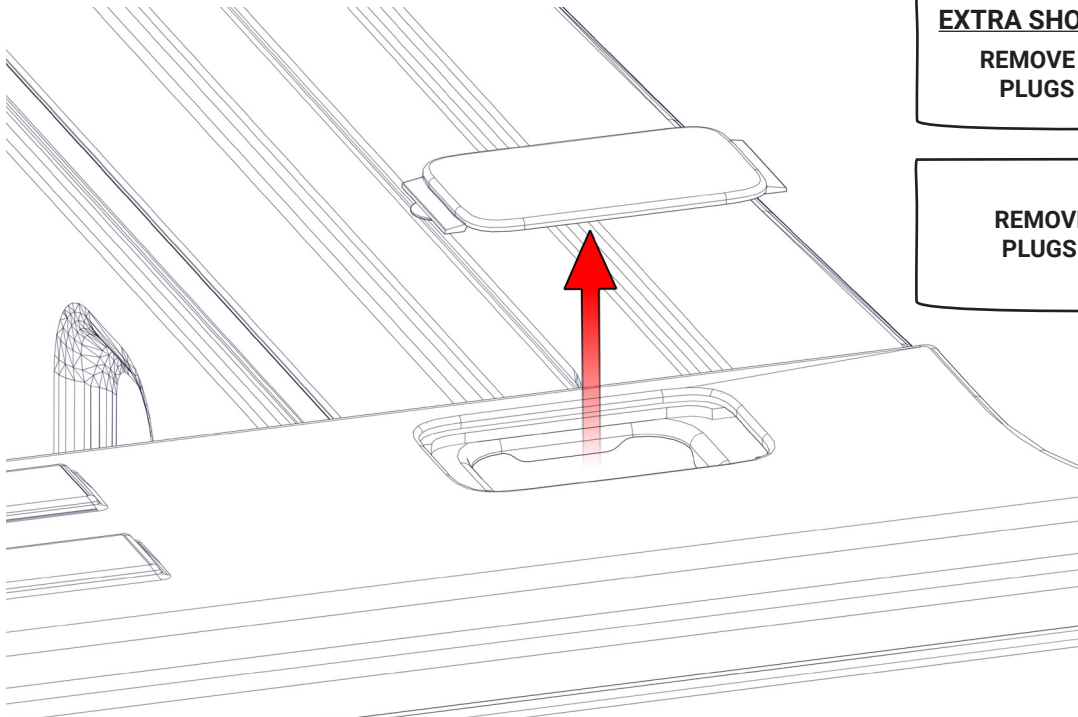

EXTRA SHORT BOX AND SHORT BOX

REMOVE PLASTIC STAKE POCKET
PLUGS FROM REAR POSITION.

LONG BOX

REMOVE PLASTIC STAKE POCKET
PLUGS FROM MIDDLE AND REAR
POSITION.

EXTRA SHORT BOX AND SHORT BOX

3/8 X 1 3/4 Stainless Steel Counter Sink Bolt

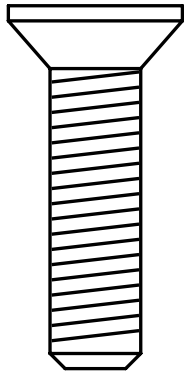

X 2

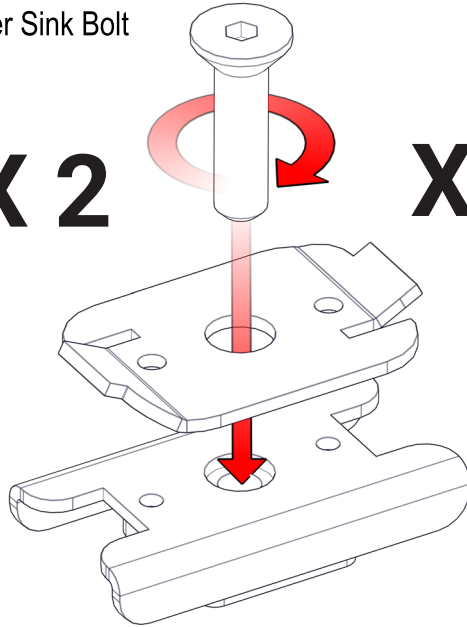

X 2

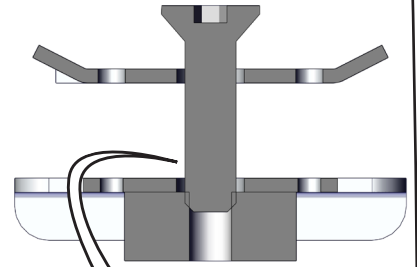

**THIS GAP IS
REQUIRED FOR
INSTALLATION**

LONG BOX

3/8 X 1 3/4 Stainless Steel Counter Sink Bolt

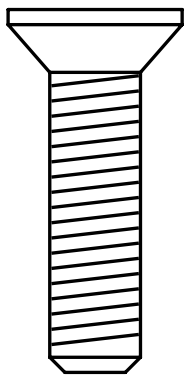

X 4

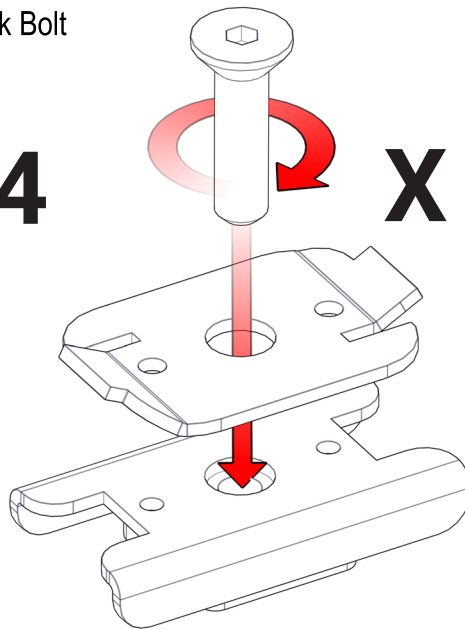

X 4

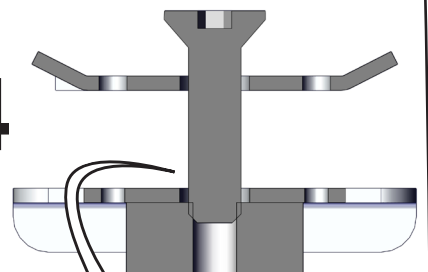

**THIS GAP IS
REQUIRED FOR
INSTALLATION**

3.

REQUIRED FOR EXTRA SHORT AND SHORT BOX

#10 - 1" Plated Zinc Robertson Powerhead Drill Tip Screw

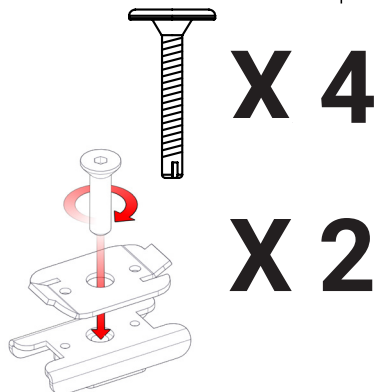

REQUIRED FOR LONG BOX

#10 - 1" Plated Zinc Robertson Powerhead Drill Tip Screw

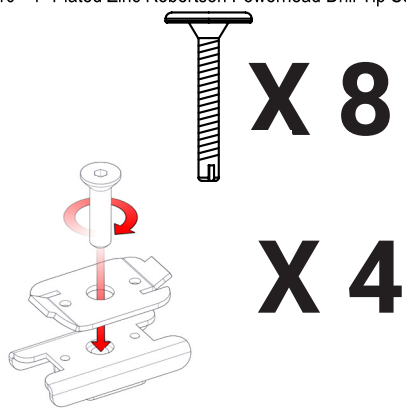

3.1

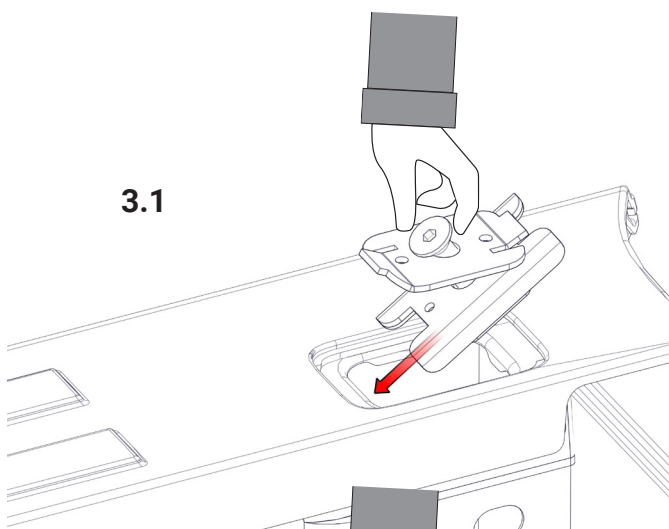

3.2

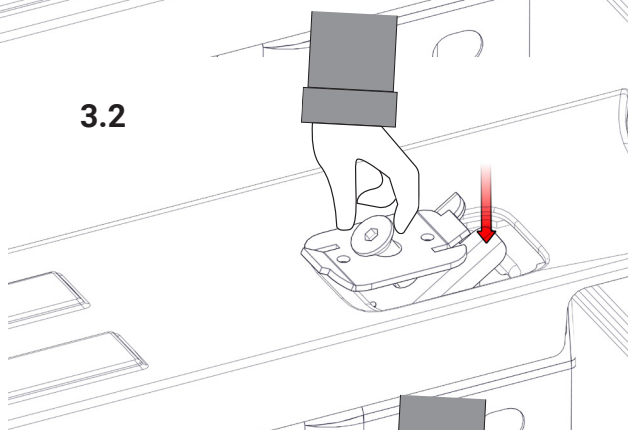

3.3

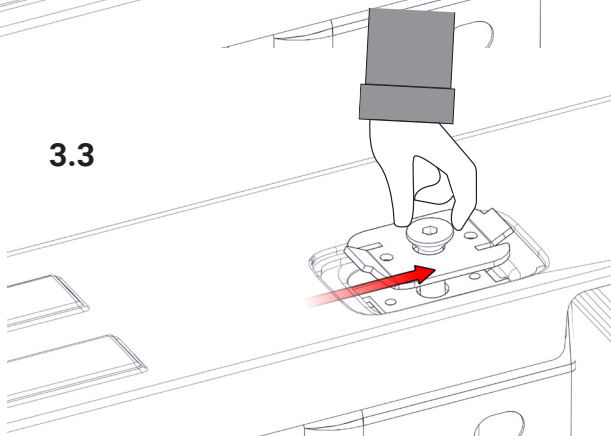

3.4

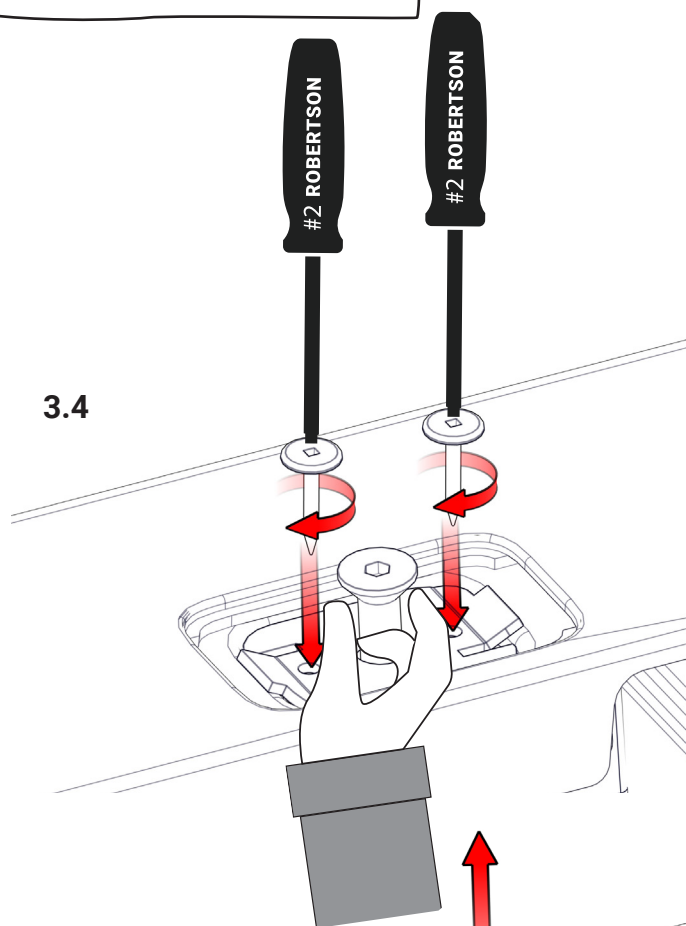

3.5

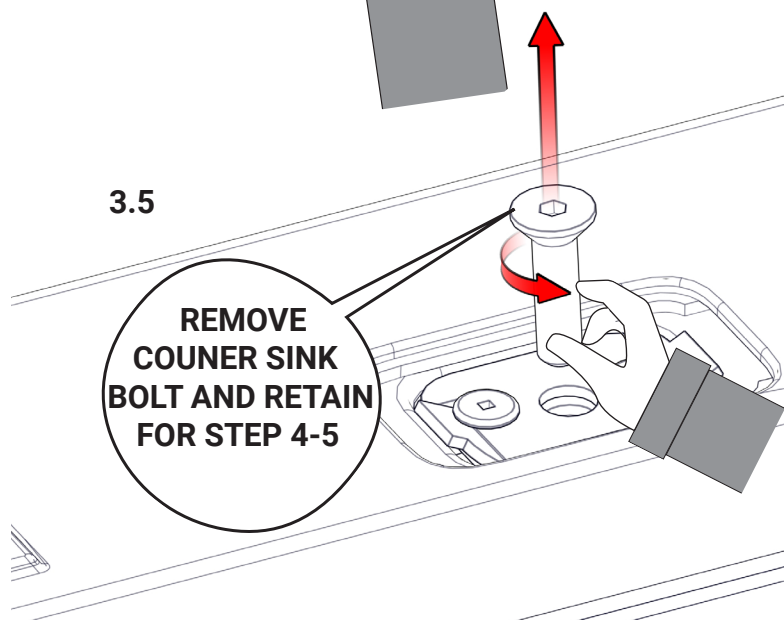

4.

LONG BOX

3/8 X 1 3/4 Stainless Steel Counter Sink Bolt

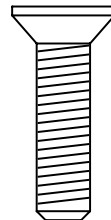

X 4

3/8" Stainless Steel Finishing Washer

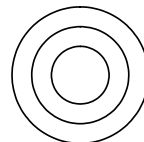

X 4

Anti-Sieze Lubricant

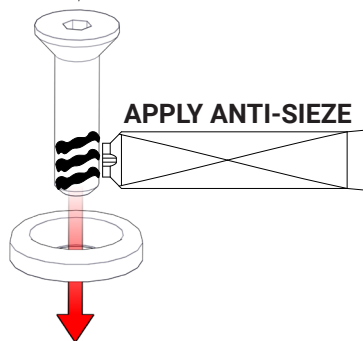
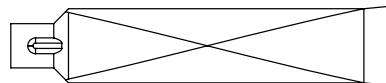

APPLY ANTI-SIEZE

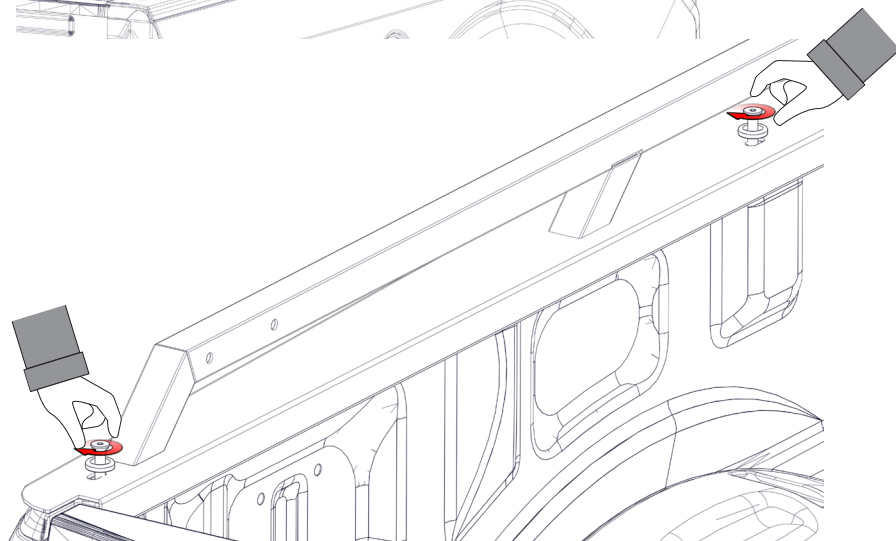
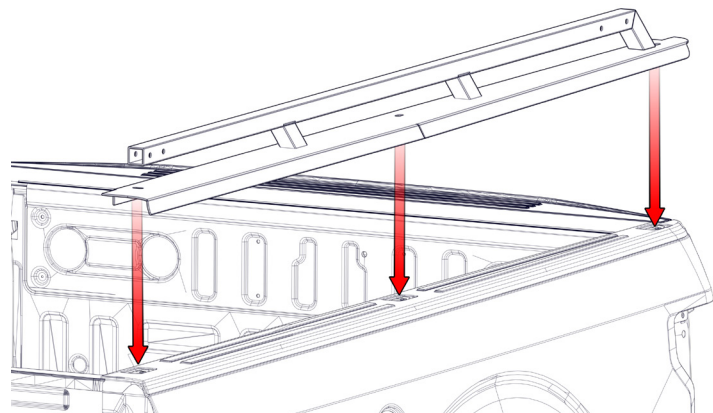

TORQUE

**=90 IN-LBF
=7.5 FT-LBF**

**IF INSTALLING WITH A CABGUARD,
TORQUE DOWN WHEN THE CABGUARD
INSTALL IS COMPLETE.**

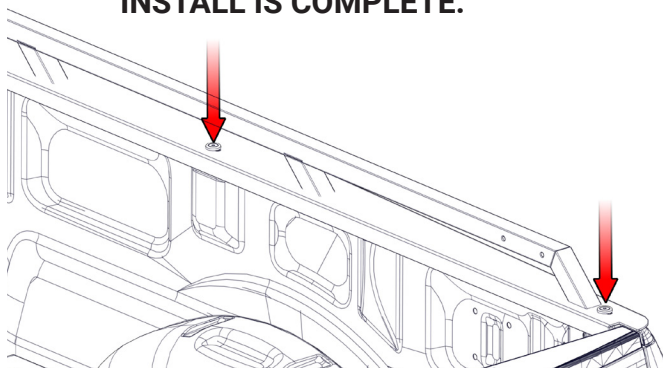
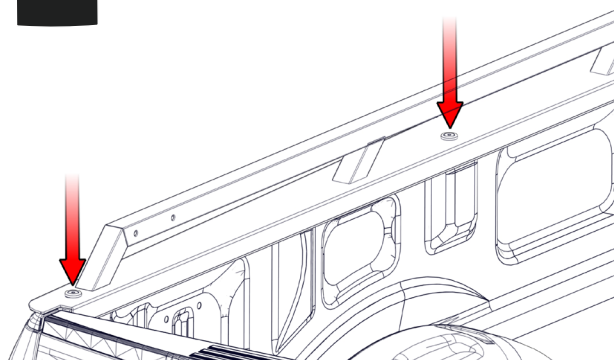

5.

EXTRA SHORT BOX AND SHORT BOX

3/8 X 1 3/4 Stainless Steel Counter Sink Bolt

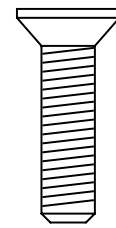
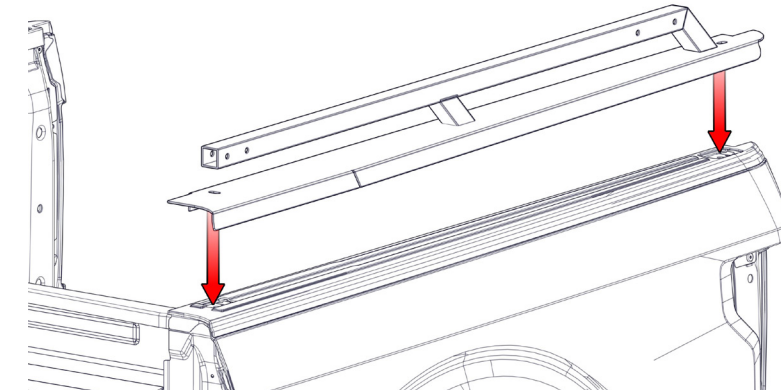

X 2

3/8" Stainless Steel Finishing Washer

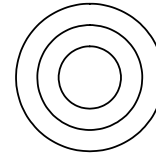

X 2

Anti-Sieze Lubricant

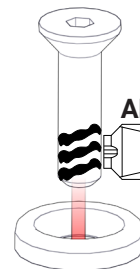
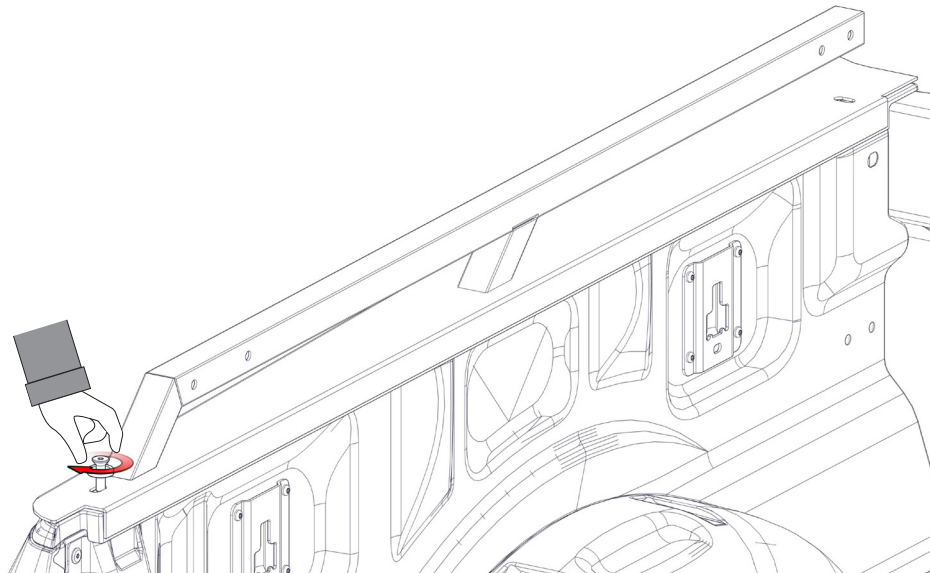
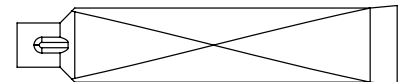

APPLY ANTI-SIEZE

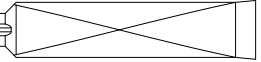

**=90 IN-LBF
=7.5 FT-LBF**

**IF INSTALLING WITH A CABGUARD,
TORQUE DOWN WHEN THE
CABGUARD INSTALL IS COMPLETE.**

