

INSTALLATION INSTRUCTIONS: 2016+ TITAN RAIL CAP AND CAB GUARD

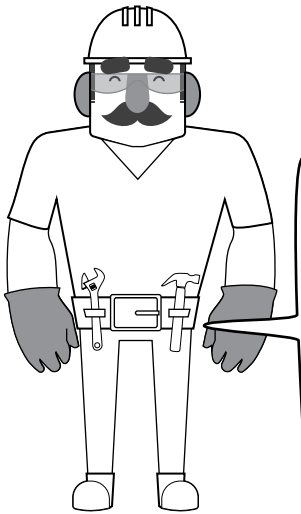

TOOLS NEEDED:

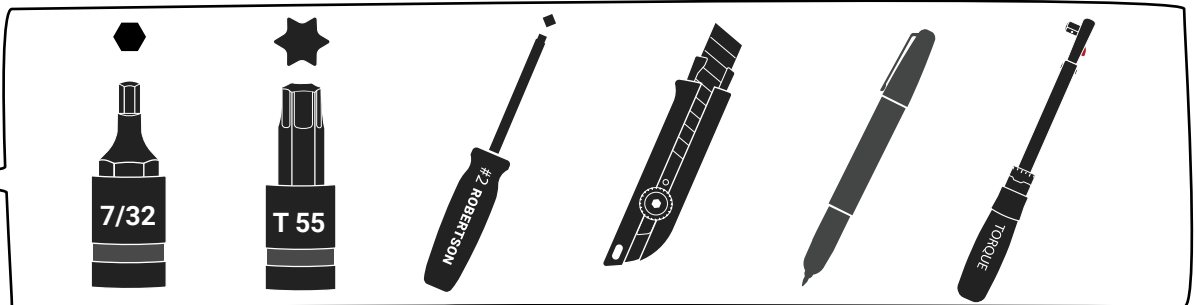

CAUTION:

This equipment is designed to be professionally installed by an approved up-fitter. Always wear ear and eye protection and exercise caution when installing Westcan products.

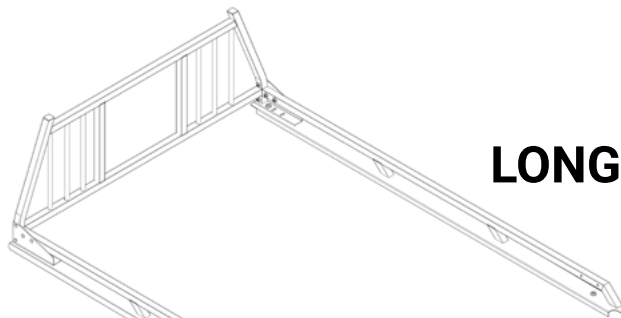

LONG BOX

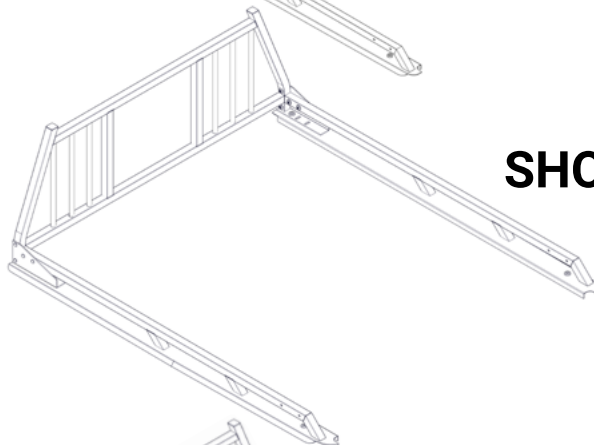

SHORT BOX

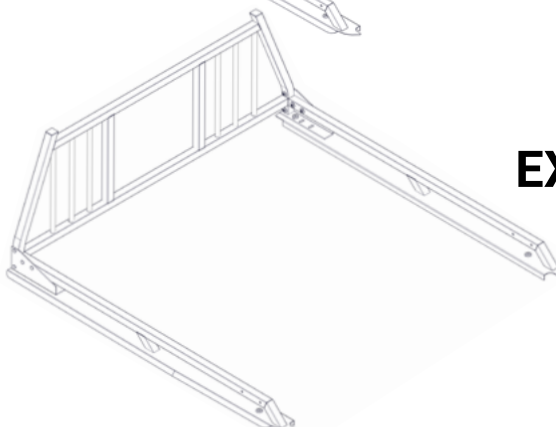

EXTRA SHORT BOX

PREPARATION:

1. Ensure all parts are present and accounted for before installation. **Begin the installation of your cabguard before your rail caps.** Plan the location of your installation ahead of time and make sure your installation location does not impede any other components you are installing or damage the safety and functionality of your vehicle.
2. Exercise extreme diligence when drilling holes into a motor vehicle. Increasing complexity and model year changes can alter the location of fuel, hydraulic and electrical lines. Please visually inspect all locations prior to drilling.
3. Re-Torque the 3/8" x 1-3/4" Stainless Steel Countersink Bolt every 3 month.

BOX CAP PREPARATION:

Use the provided cardboard template as a guide for cutting the box cap. The tabs on the guide should line up with the factory cut lines on the plastic box cap to center the guide. Exercise caution when cutting caps to avoid injury.

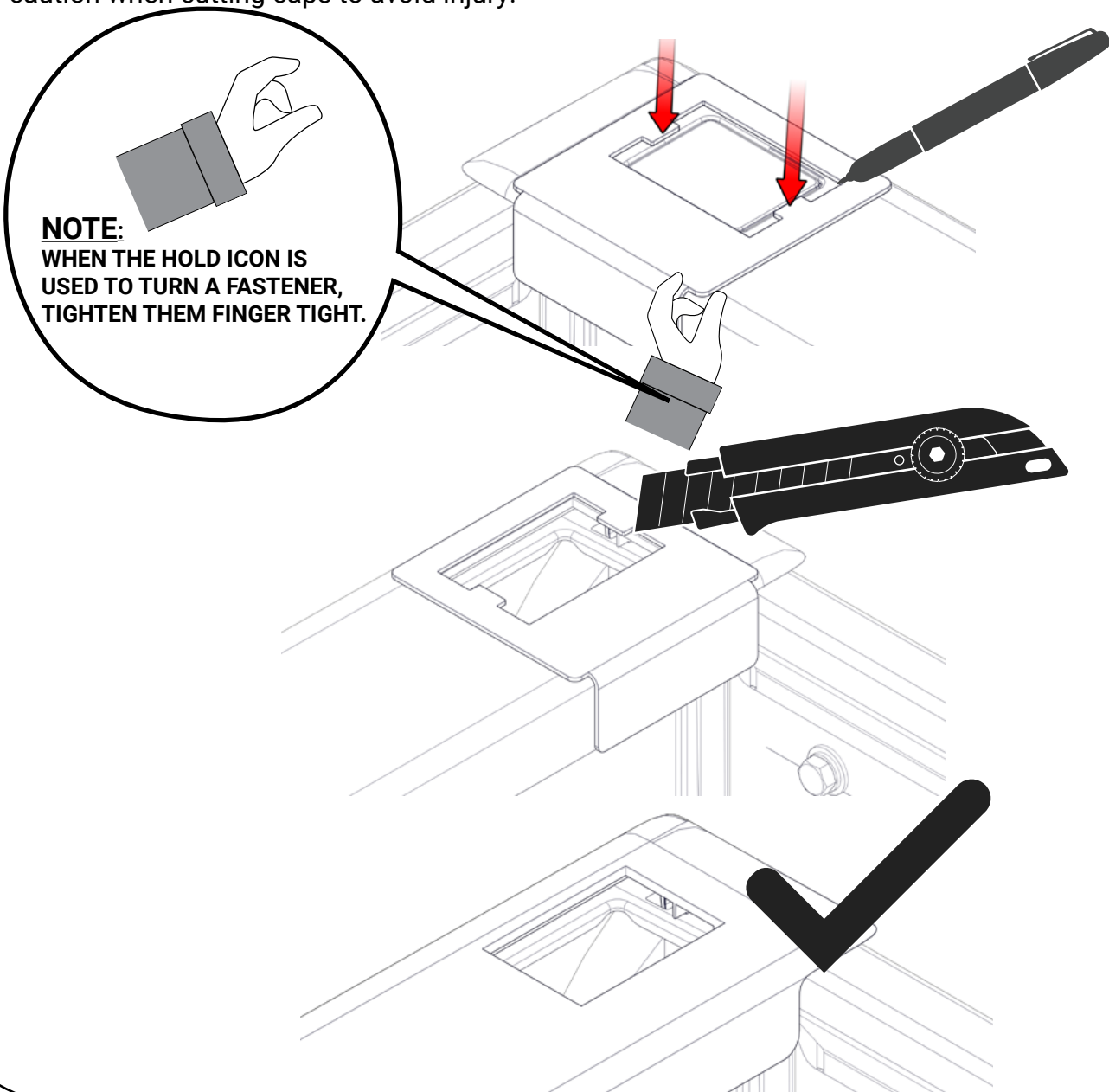

1

EXTRA SHORT BOX , SHORT BOX, LONG BOX
CUT PLASTIC CAP TO EXPOSE THE REAR STAKE POCKETS.

2

EXTRA SHORT BOX, SHORT BOX AND LONG BOX

3/8 X 1 3/4 Stainless Steel Counter Sink Bolt

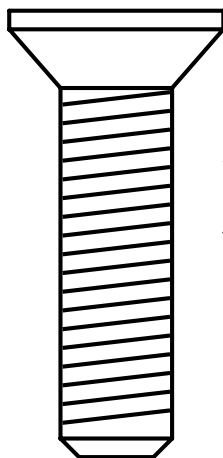

X 2

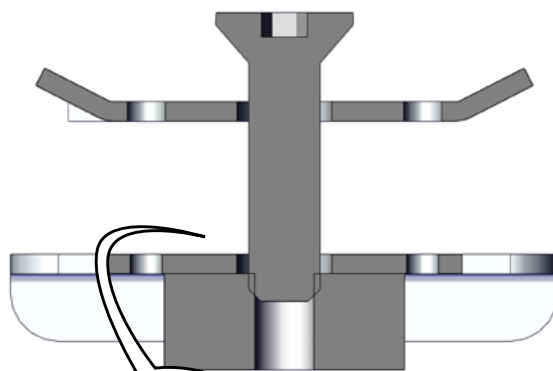
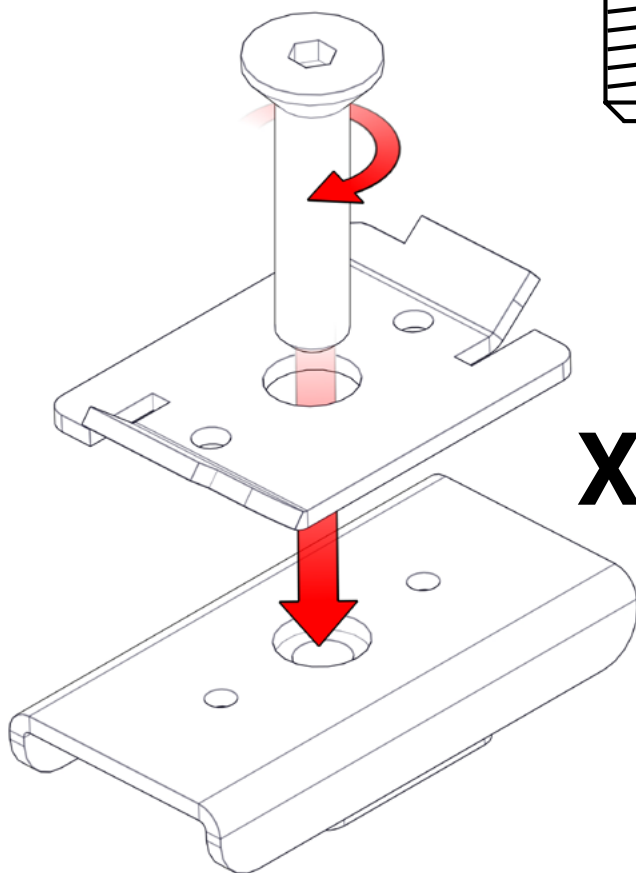

**THIS GAP IS
REQUIRED FOR
INSTALLATION**

3.

#10 - 1" Plated Zinc Robertson Powerhead Drill Tip Screw

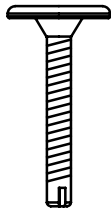

X 4

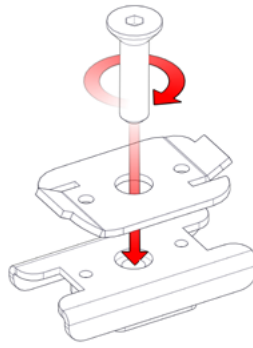

X 2

3.1

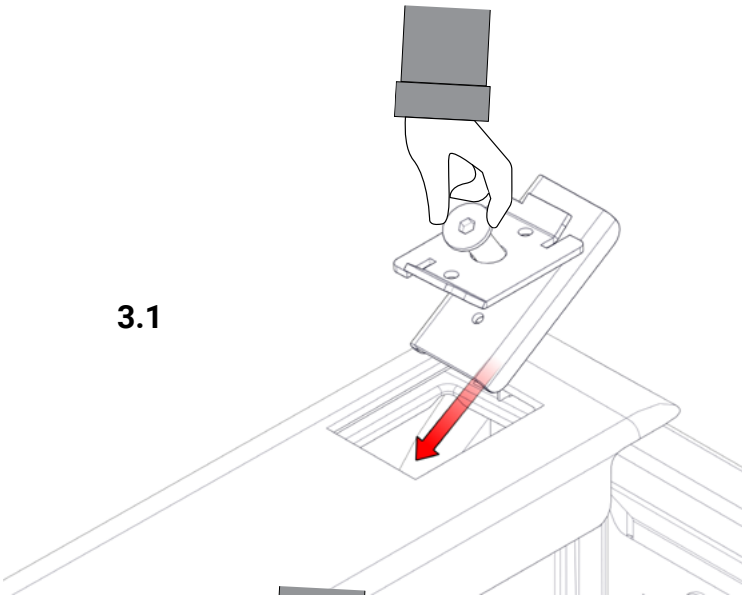

3.2

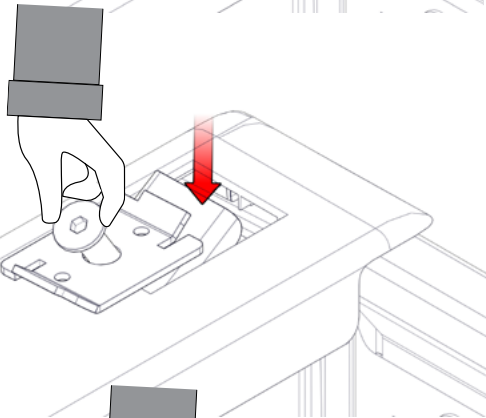

3.3

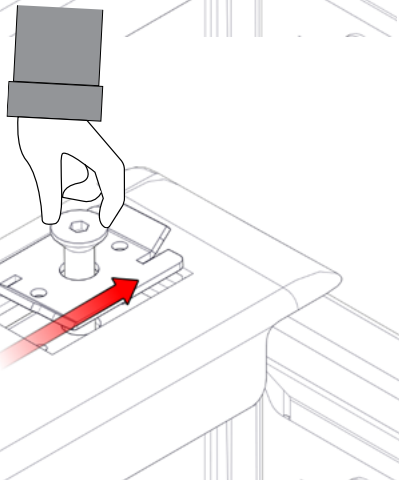

3.4

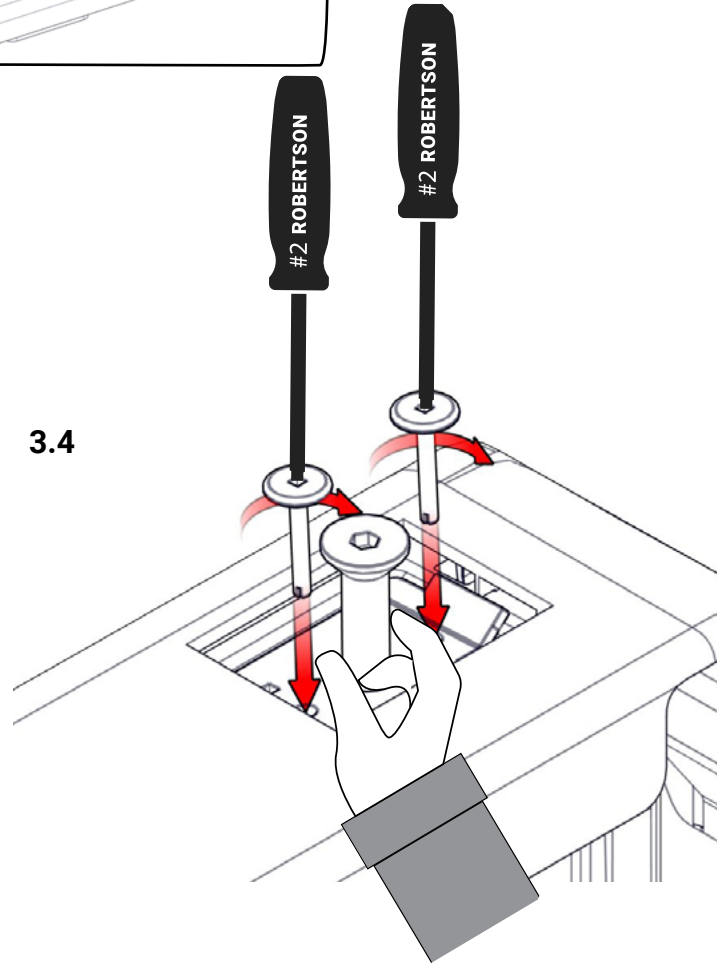

3.5

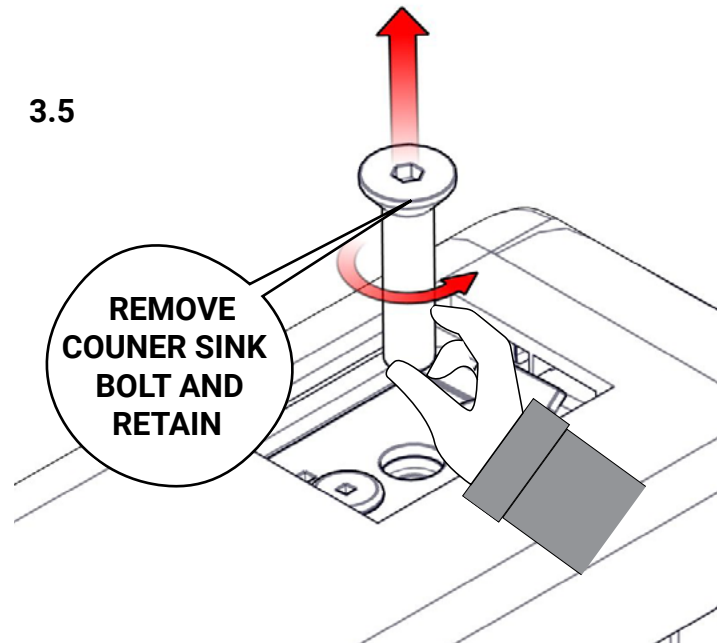

4.

ALL BOX LENGTHS

3/8 X 1 3/4 Stainless Steel Counter Sink Bolt

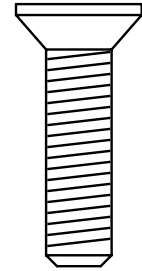

X 2

3/8" Stainless Steel Finishing Washer

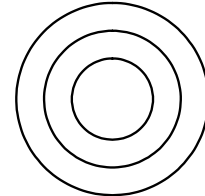

X 2

Anti-Sieze Lubricant

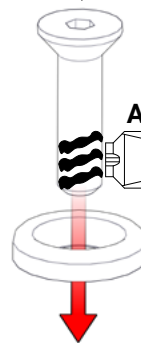
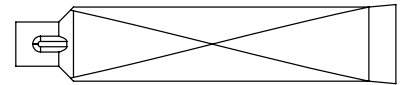

APPLY ANTI-SIEZE

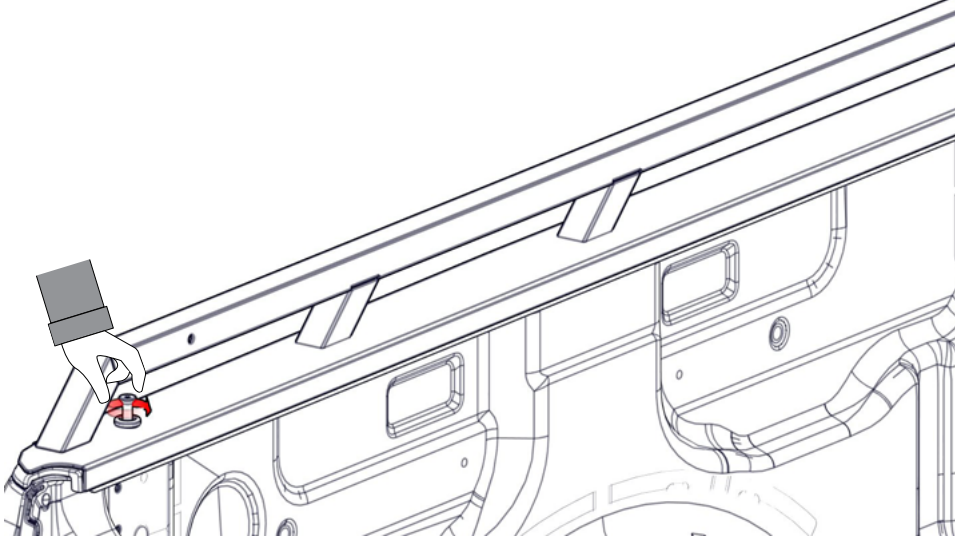
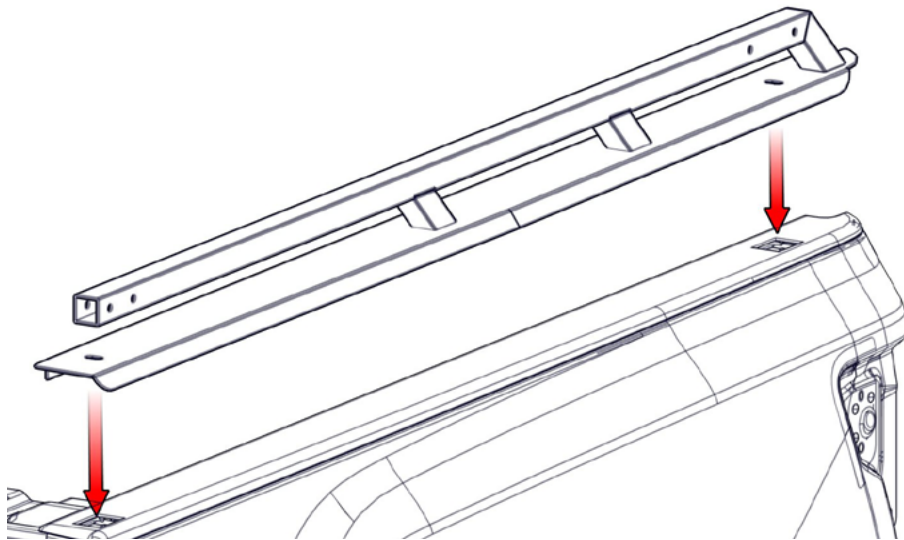

**=90 IN-LBF
=7.5 FT-LBF**

**IF INSTALLING WITH A CABGUARD,
TORQUE DOWN WHEN THE CABGUARD
INSTALL IS COMPLETE.**

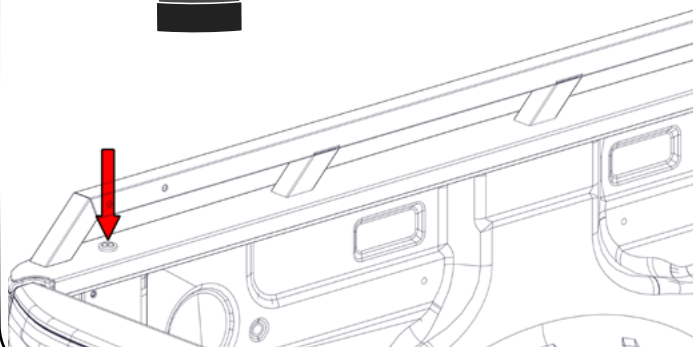

PRINT AT A 1:1 SCALE AND CUT OUT. FOLD ALONG DOTTED LINE.

TABS LINE UP WITH THE EDGE OF THE STAKE POCKET EMBOSS FOR TEMPLATE POSITIONING. CUT THE STAKE POCKET HOLE SQUARE.

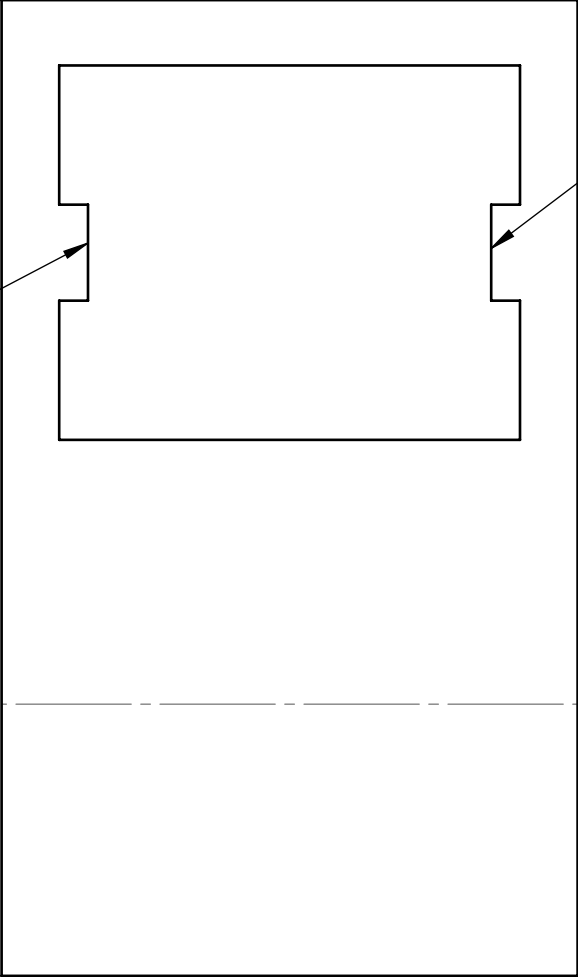

TABS LINE UP WITH THE EDGE OF THE STAKE POCKET EMBOSS FOR TEMPLATE POSITIONING. CUT THE STAKE POCKET HOLE SQUARE.

PROPRIETARY AND CONFIDENTIAL

THE INFORMATION CONTAINED IN THIS DRAWING IS THE SOLE PROPERTY OF WESTCAN MANUFACTURING LTD. ANY REPRODUCTION IN PART OR AS A WHOLE WITHOUT THE WRITTEN PERMISSION OF WESTCAN MANUFACTURING LTD IS PROHIBITED.

WESTCAN MANUFACTURING LTD.

DESCRIPTION: Titan stake pocket cutout template

UNLESS OTHERWISE SPECIFIED, DIMENSIONS ARE IN INCHES				Rev:		MATERIAL:		Sheet1 OF 1
TOLERANCE				DRAWN BY: Dtocher				
ANG.	FRAC.	.XX	.XXX	PART NR:				
± 0.5"	1/32"	±0.01"	±0.005"	DATE: 18/10/18				