

## INSTALLATION INSTRUCTIONS: 2017+ SUPER DUTY RAIL CAP

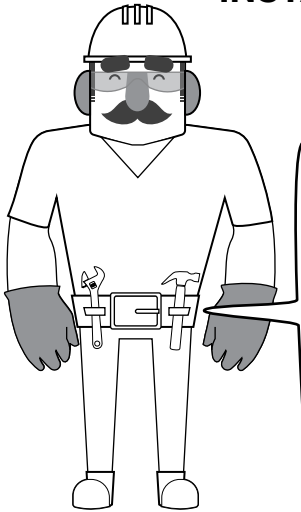

### TOOLS NEEDED:

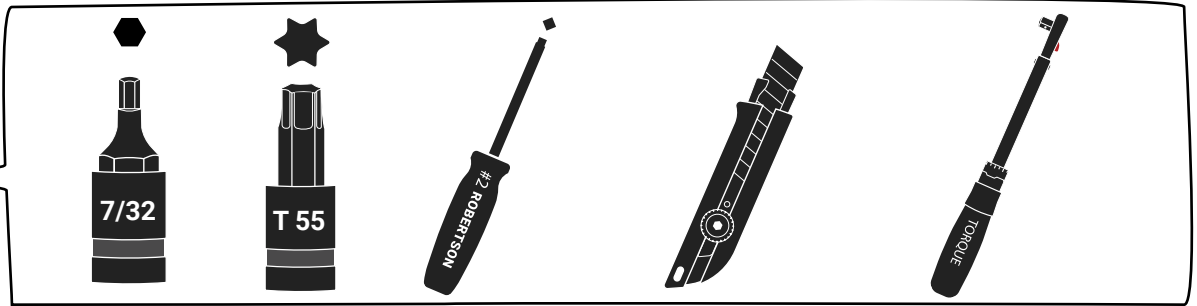

### CAUTION:

This equipment is designed to be professionally installed by an approved up-fitter. Always wear ear and eye protection and exercise caution when installing Westcan products.

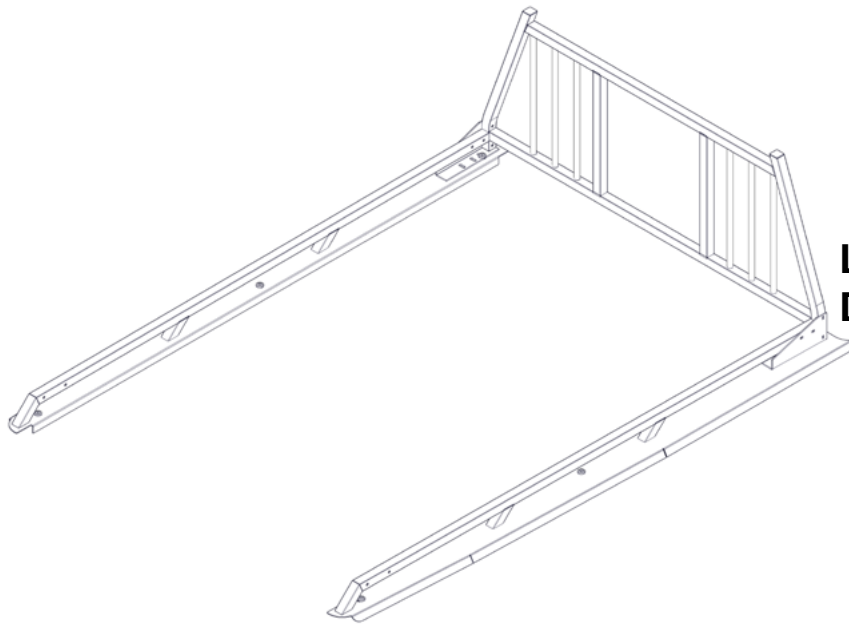

**LONG BOX AND  
DUALY**

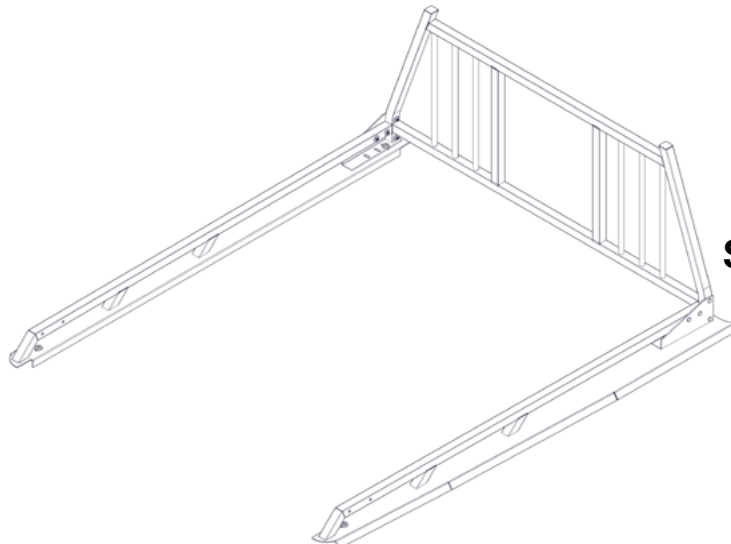

**SHORT BOX**

## PREPARATION:

1. Ensure all parts are present and accounted for before installation. **Begin the installation of your cabguard before your rail caps.** Plan the location of your installation ahead of time and make sure your installation location does not impede any other components you are installing or damage the safety and functionality of your vehicle.
2. Exercise extreme diligence when drilling holes into a motor vehicle. Increasing complexity and model year changes can alter the location of fuel, hydraulic and electrical lines. Please visually inspect all locations prior to drilling.
3. Re-Torque the 3/8" x 1-3/4" Stainless Steel Countersink Bolt every 3 month.

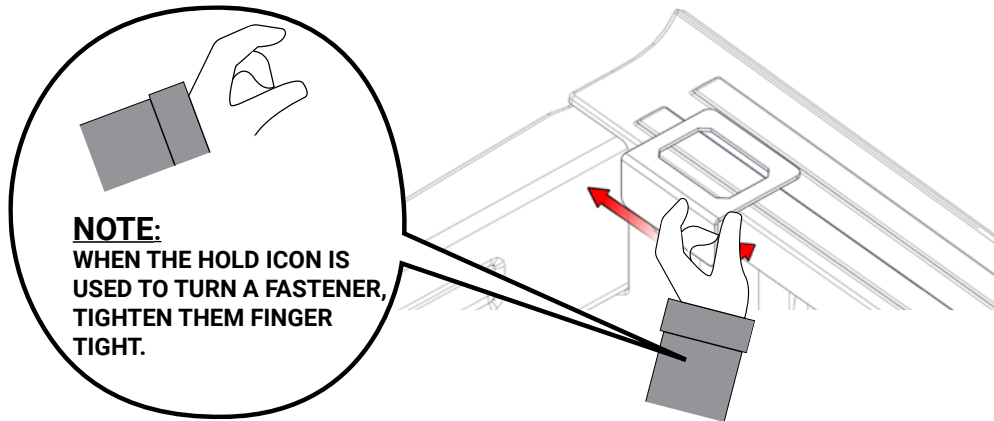

1.

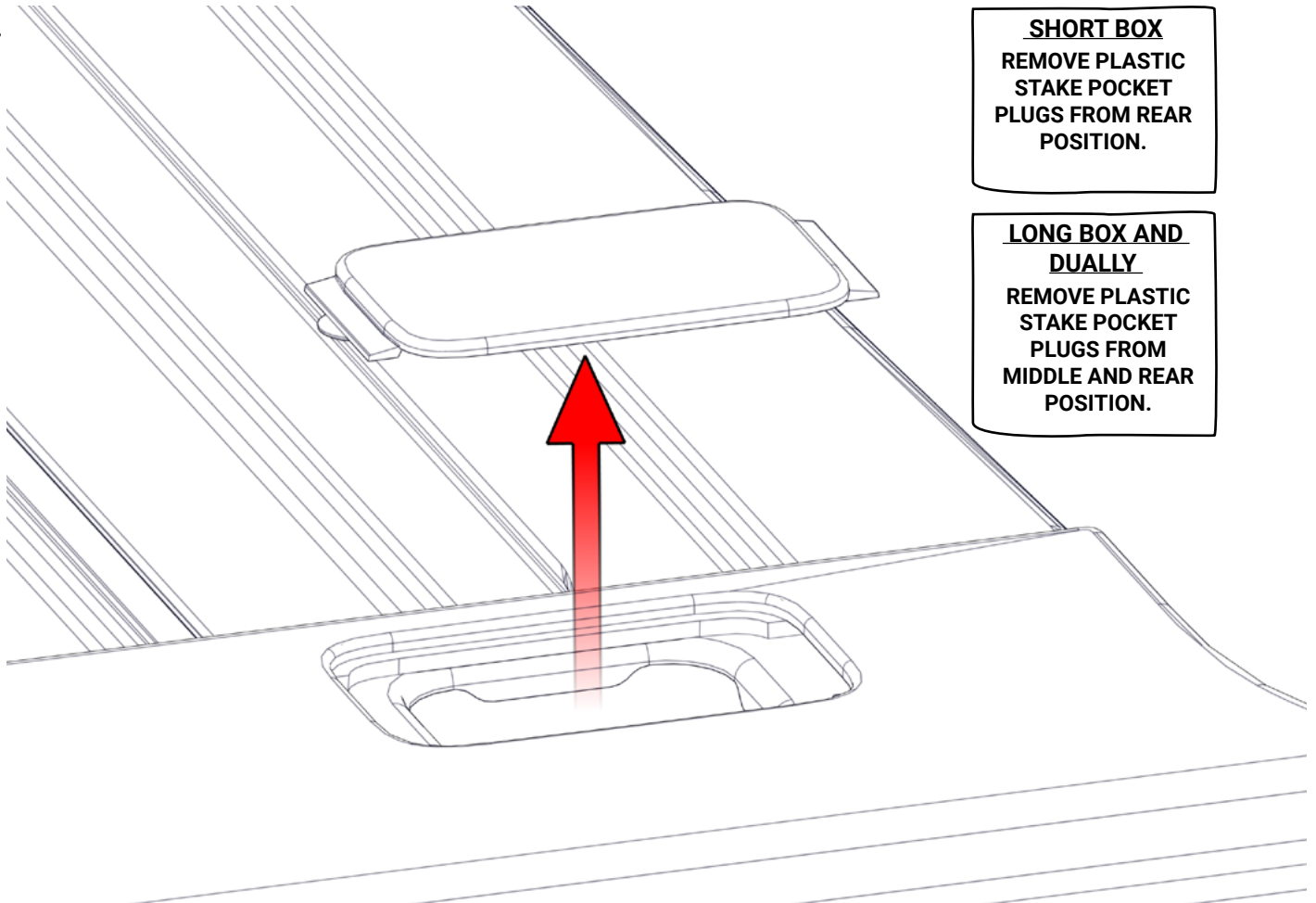

## SHORT BOX

3/8 X 1 3/4 Stainless Steel Counter Sink Bolt

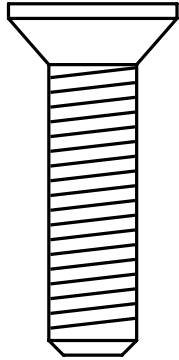

**X 4**

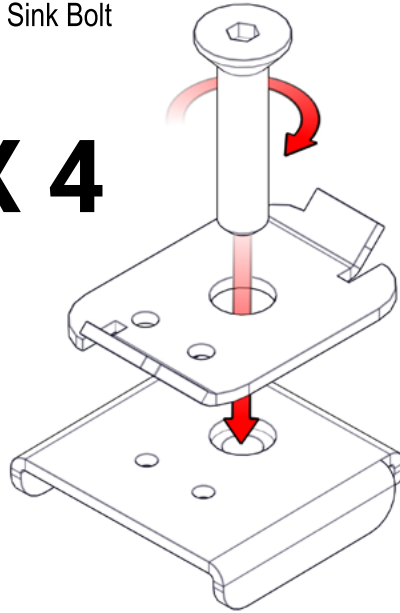

**X 2**

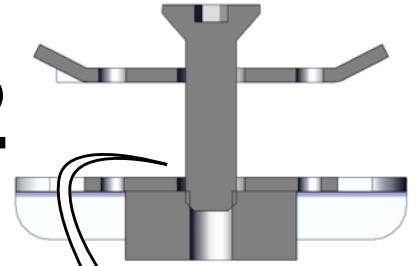

THIS GAP IS  
REQUIRED FOR  
INSTALLATION

## LONG BOX AND DUALY

CENTER STAKE POCKET



**X 2**

3/8 X 1 3/4 Stainless Steel Counter Sink Bolt

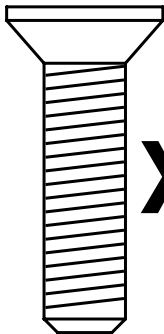

**X 4**

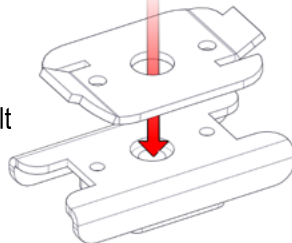

**X 2**

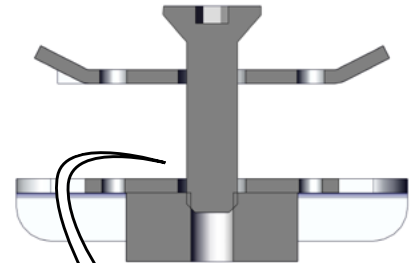

THIS GAP IS  
REQUIRED FOR  
INSTALLATION

REAR STAKE POCKET

3.

**REQUIRED FOR LONG BOX AND DUALY**

#10 - 1" Plated Zinc Robertson Powerhead Drill Tip Screw

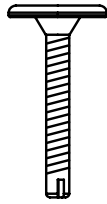

**X 4**

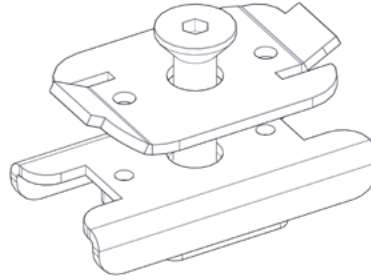

**X 2**

**CENTER STAKE POCKETS (LONG BOX AND DUALY)**

3.1

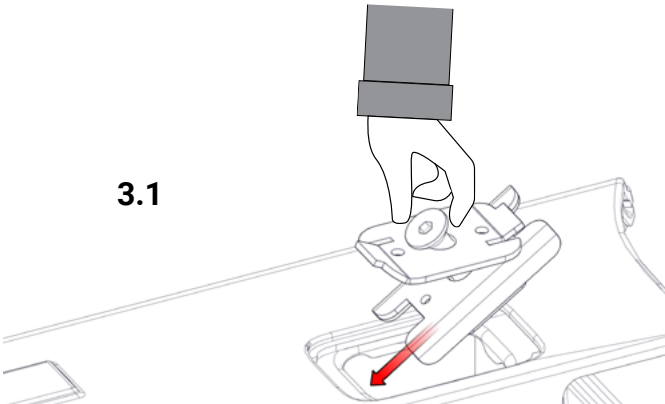

3.2

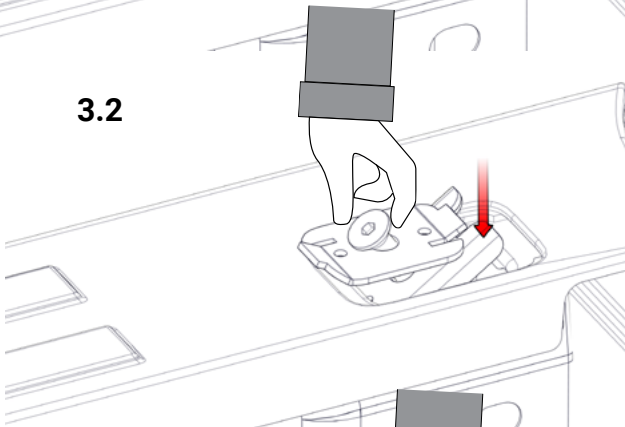

3.3

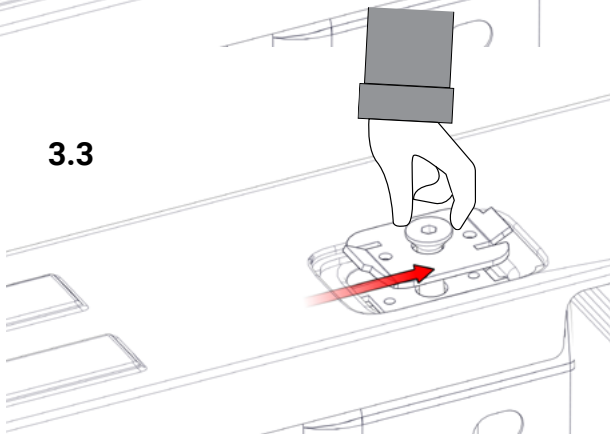

3.4

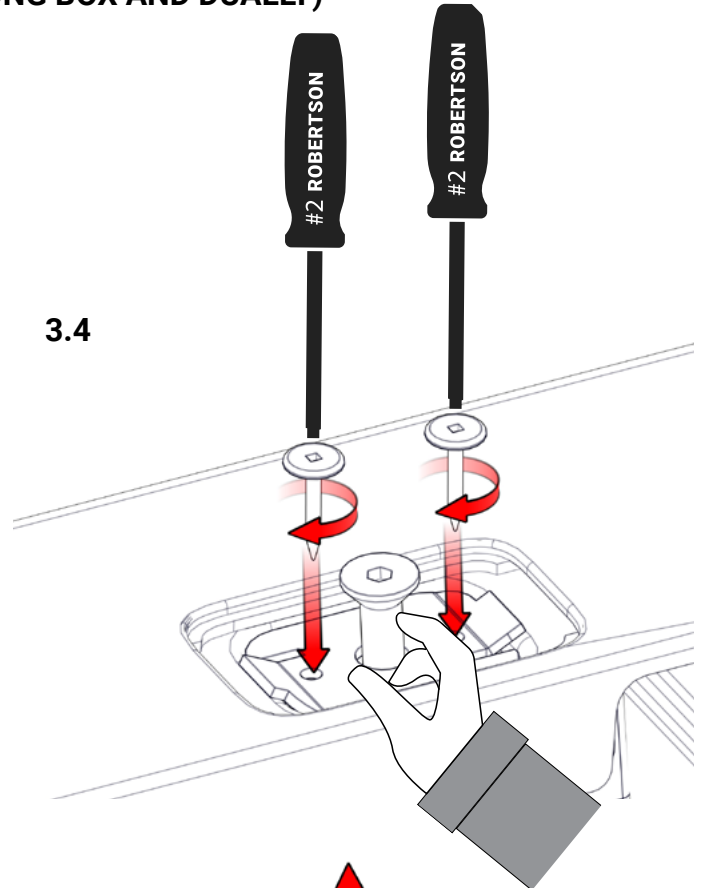

3.5

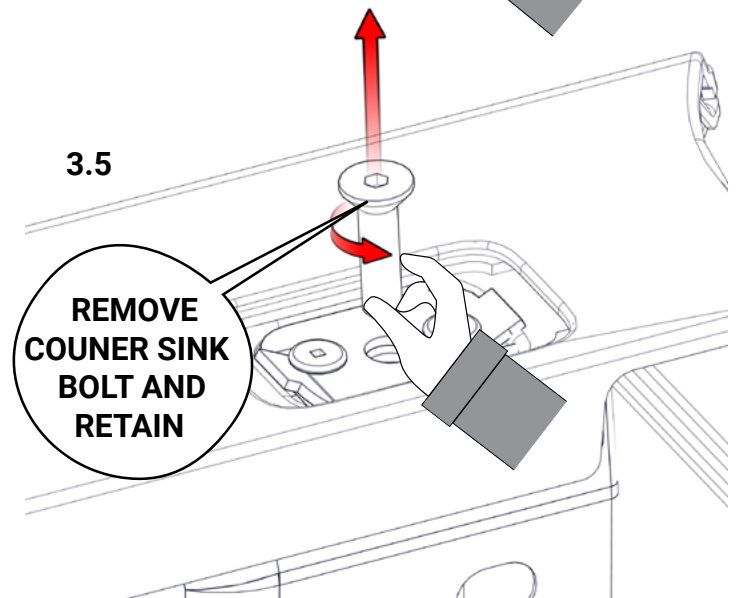

4.

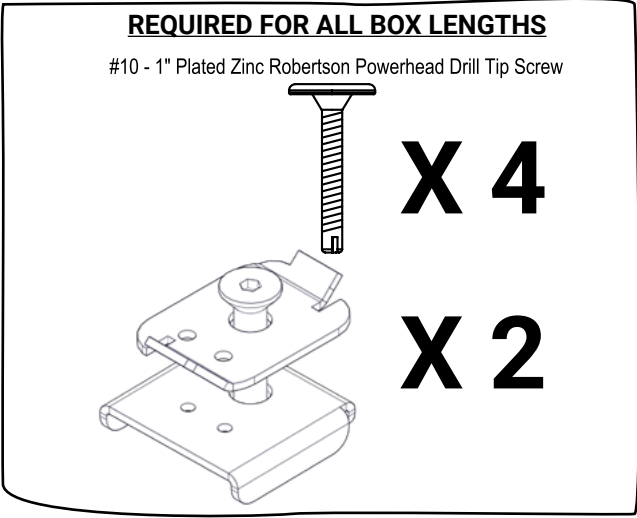

**REAR STAKE POCKETS (ALL BOX LENGTHS)**

4.1

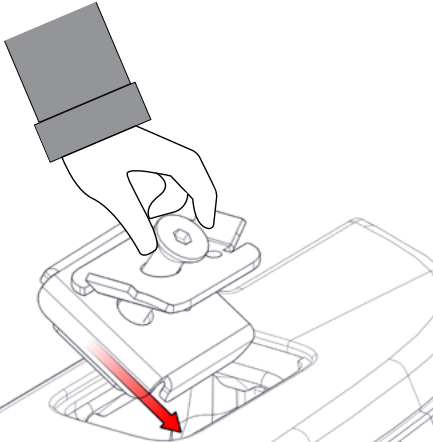

4.2

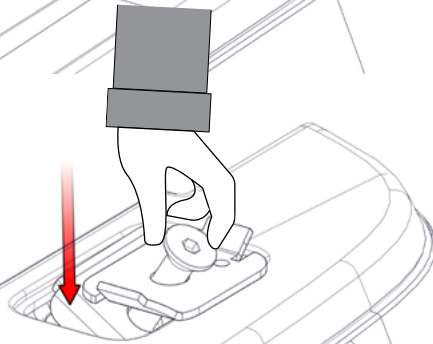

4.3

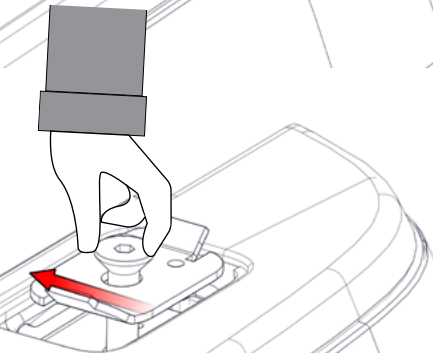

4.4

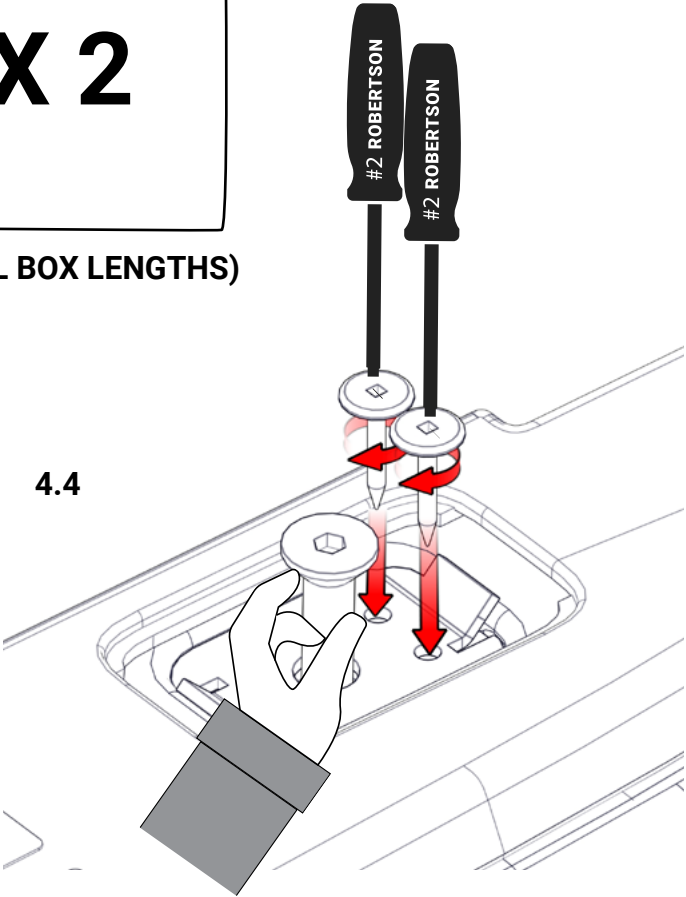

4.5

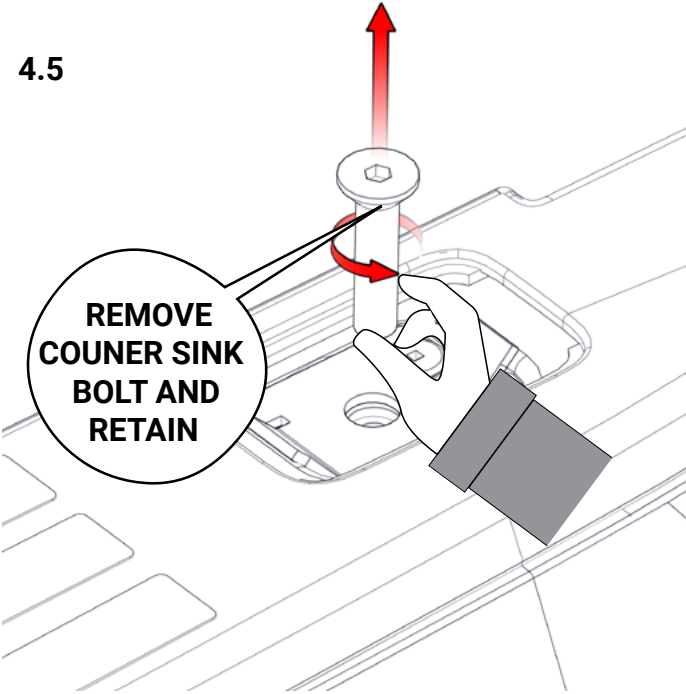

4.

**LONG BOX AND DUALY**

3/8 X 1 3/4 Stainless Steel Counter Sink Bolt

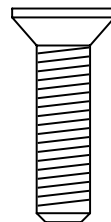

**X 4**

3/8" Stainless Steel Finishing Washer

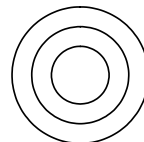

**X 4**

Anti-Sieze Lubricant

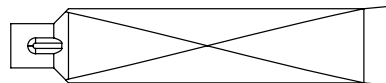

**APPLY ANTI-SIEZE**

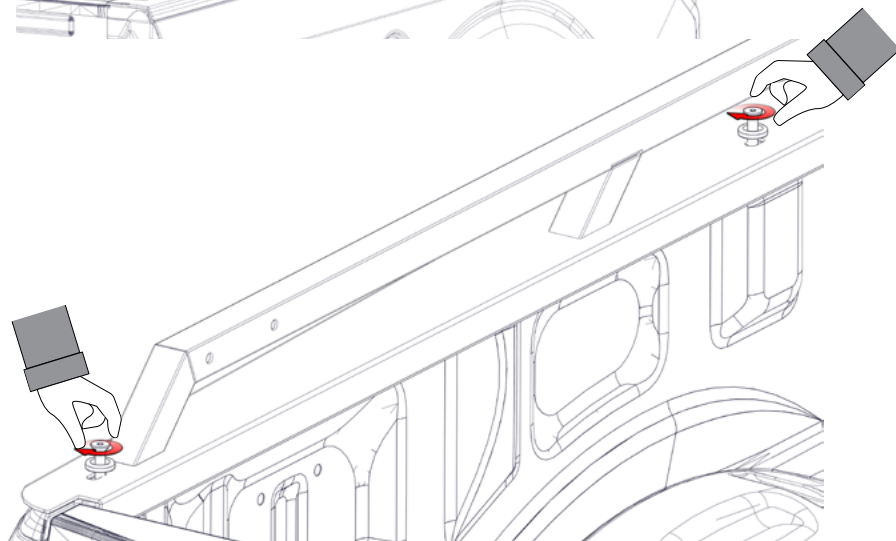
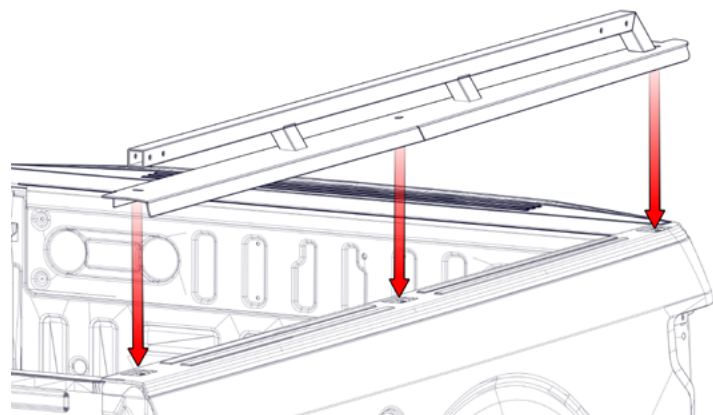
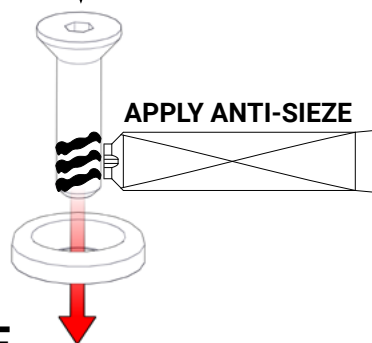

**TORQUE**

**=90 IN-LBF  
=7.5 FT-LBF**

**IF INSTALLING WITH A CABGUARD,  
TORQUE DOWN WHEN THE CABGUARD  
INSTALL IS COMPLETE.**

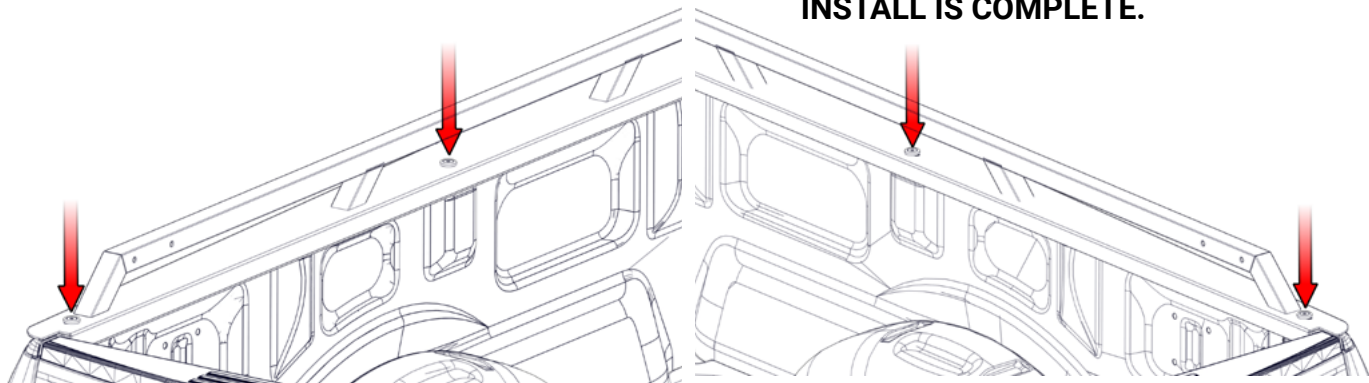



5.

**EXTRA SHORT BOX AND SHORT BOX**

3/8 X 1 3/4 Stainless Steel Counter Sink Bolt

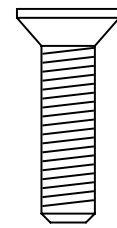
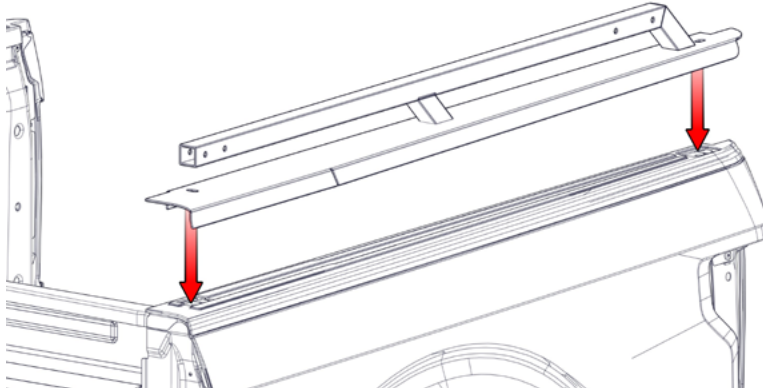

**X 2**

3/8" Stainless Steel Finishing Washer

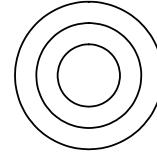

**X 2**

Anti-Sieze Lubricant

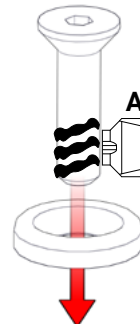
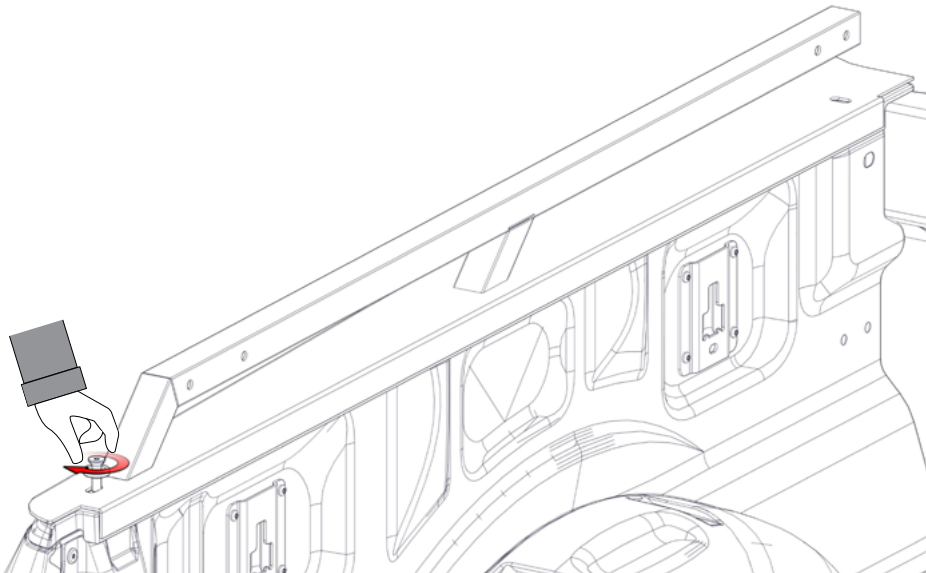
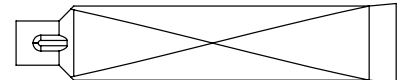

**APPLY ANTI-SIEZE**

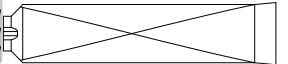

**=90 IN-LBF  
=7.5 FT-LBF**

**IF INSTALLING WITH A CABGUARD,  
TORQUE DOWN WHEN THE CABGUARD  
INSTALL IS COMPLETE.**

