

# INSTALLATION INSTRUCTIONS: 2019+ SILVERADO/SIERRA RAIL CAP AND CAB GUARD

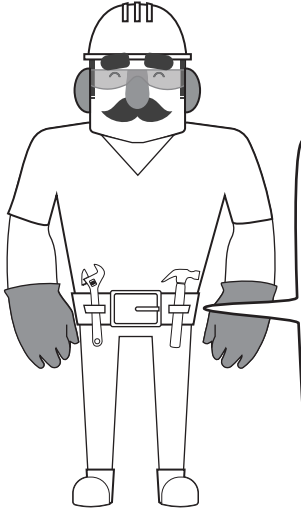

## TOOLS NEEDED:

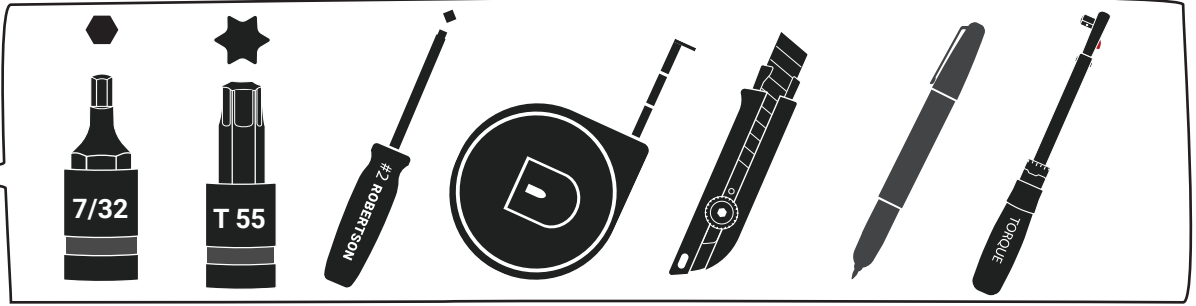

## CAUTION:

This equipment is designed to be professionally installed by an approved up-fitter. Always wear ear and eye protection and exercise caution when installing Westcan products.

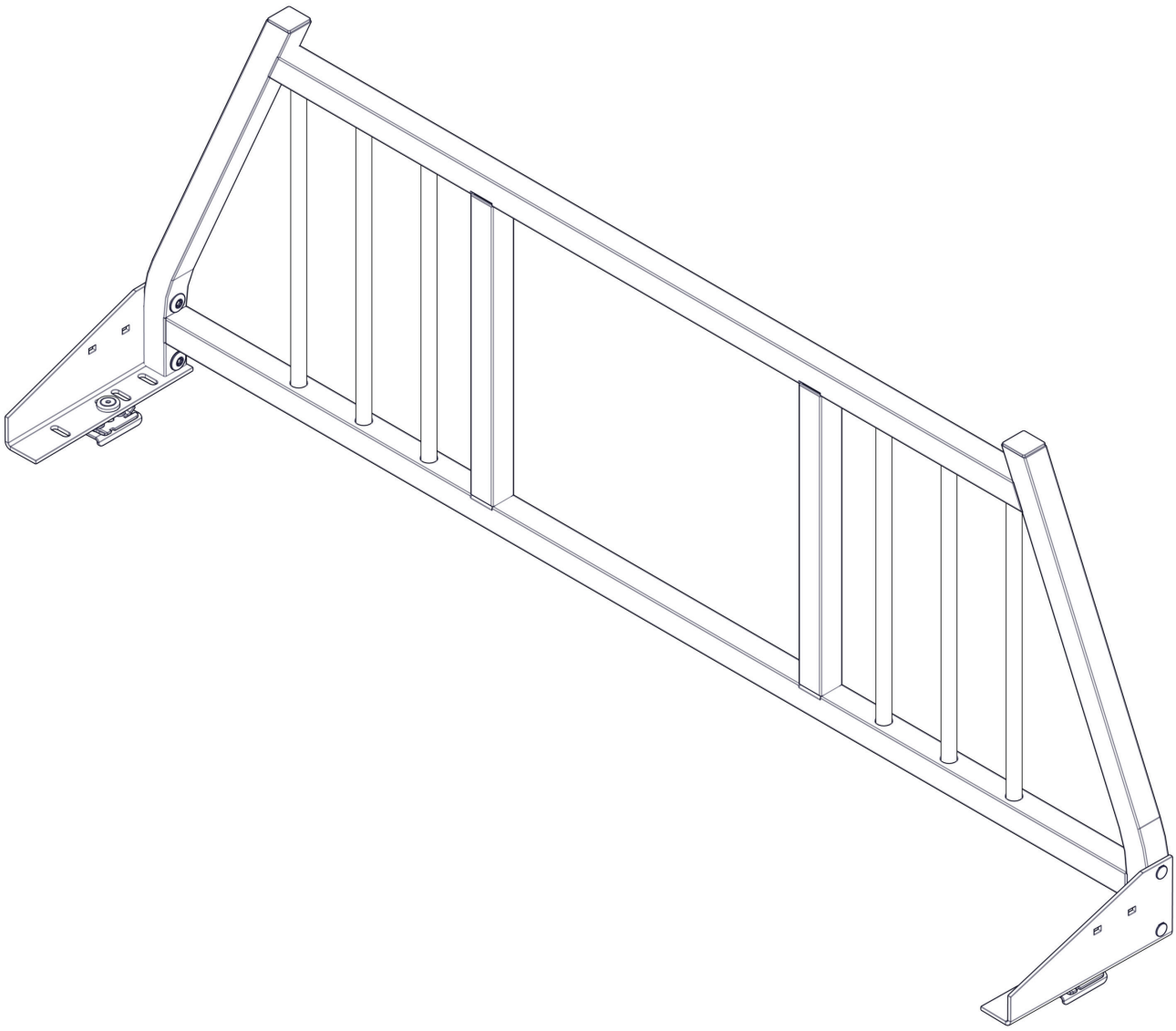

## PREPARATION:

1. Ensure all parts are present and accounted for before installation. **Begin the installation of your cabguard before your rail caps.** Plan the location of your installation ahead of time and make sure your installation location does not impede any other components you are installing or damage the safety and functionality of your vehicle.
2. Exercise extreme diligence when drilling holes into a motor vehicle. Increasing complexity and model year changes can alter the location of fuel, hydraulic and electrical lines. Please visually inspect all locations prior to drilling.
3. Re-Torque the 3/8" x 1-3/4" Stainless Steel Countersink Bolt every 3 month.

## BOX CAP PREPARATION:

Some truck box lengths require the plastic truck box caps to be cut to expose the stake pocket cutout. Use the provided cardboard template as a guide for cutting the box cap. Exercise caution when cutting to avoid injury.

### NOTE:

WHEN THE HOLD ICON IS USED TO TURN A FASTENER, TIGHTEN THEM FINGER TIGHT.

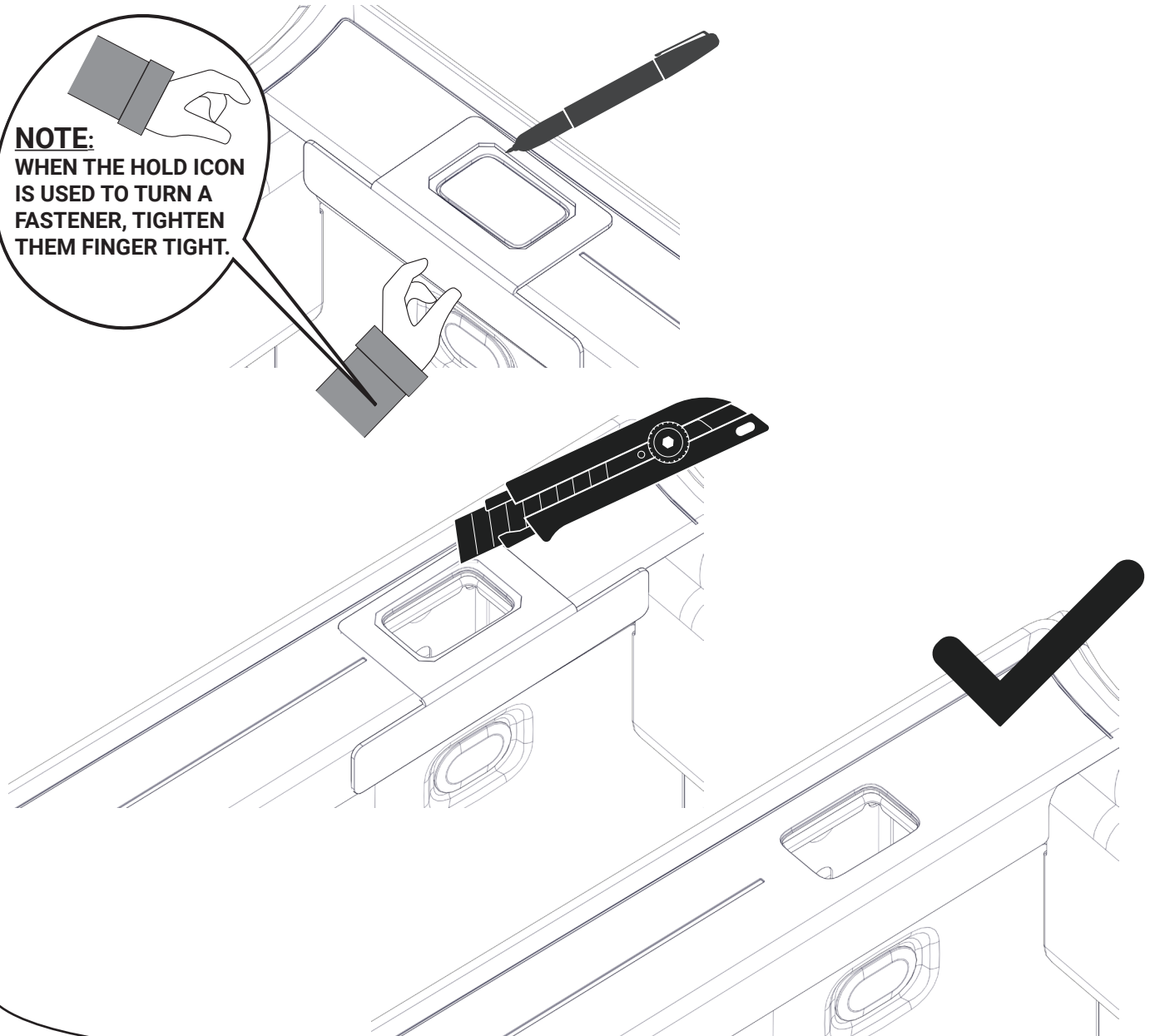

1.

## EXTRA SHORT, SHORT AND LONG BOX

CUT PLASTIC CAPS TO EXPOSE FRONT STAKE POCKET

2.

## FRONT STAKE POCKET CLIP ASSEMBLY

3/8 X 1 3/4 Stainless Steel Counter Sink Bolt

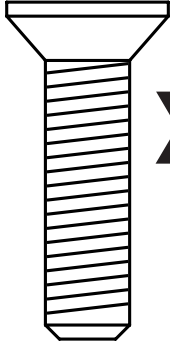

**X 2**

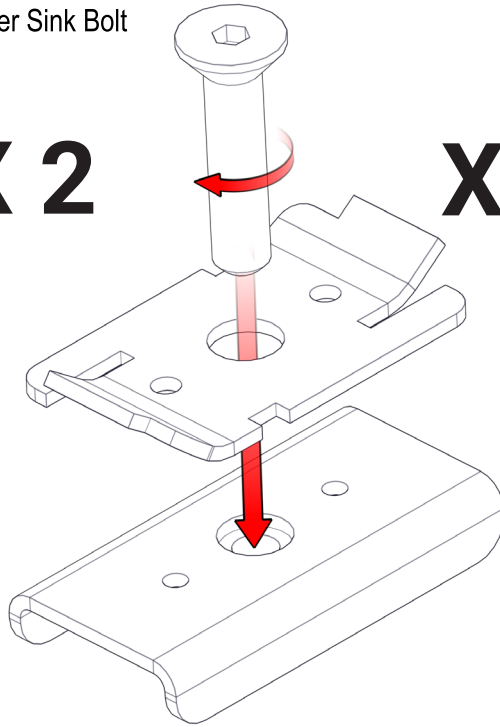

**X 2**

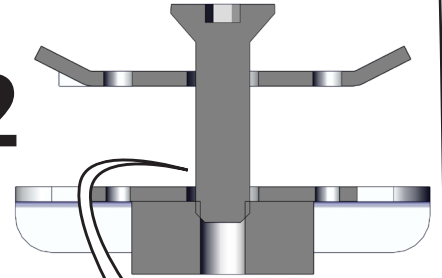

**THIS GAP IS  
REQUIRED FOR  
INSTALLATION**

3.

### REQUIRED FOR FRONT STAKE POCKETS

#10 - 1" Plated Zinc Robertson Powerhead Drill Tip Screw

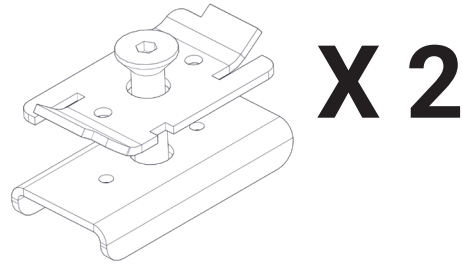
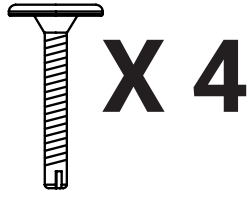

3.1

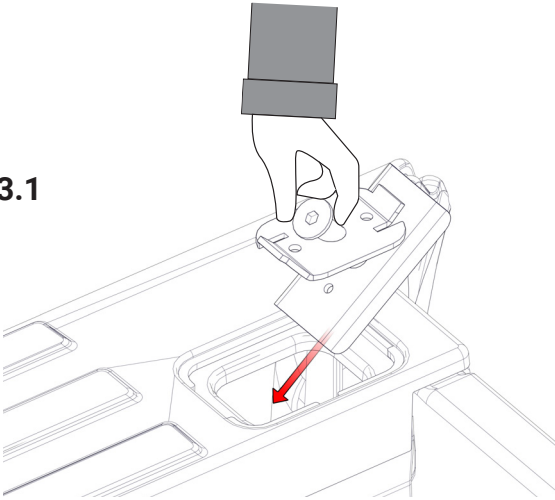

3.2

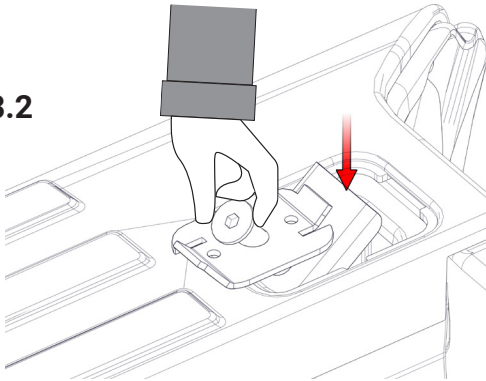

3.3

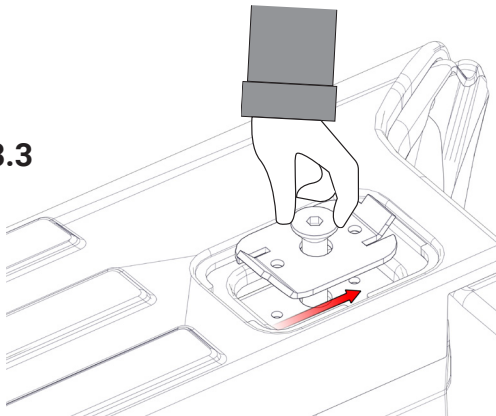

3.4

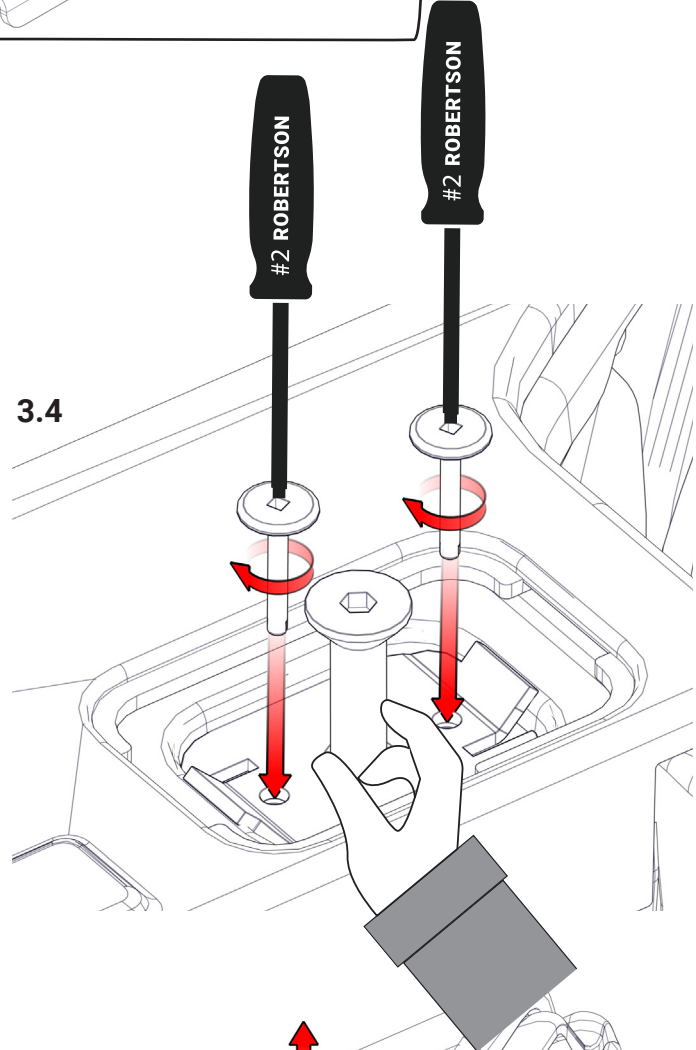

3.5

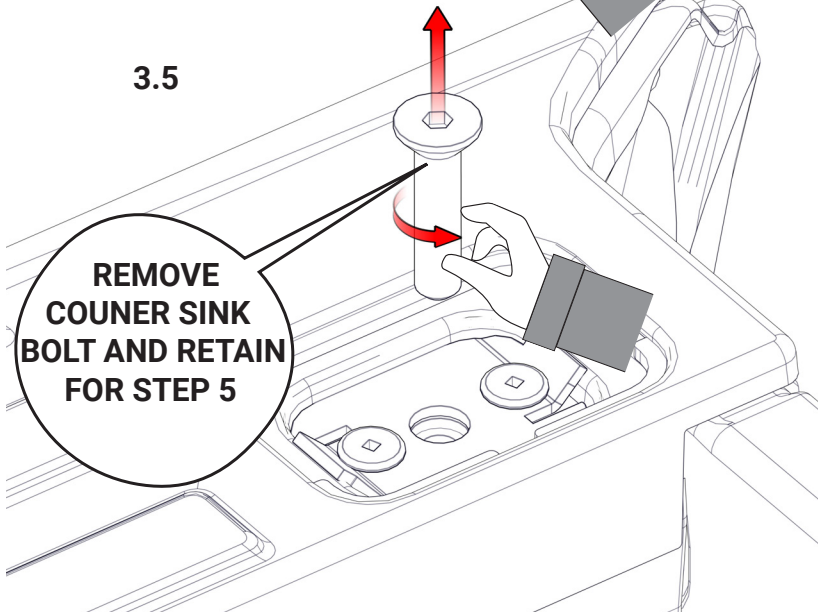

**IF REQUIRED, INSTALL YOUR RAILCAPS PRIOR TO PROCEEDING WITH STEP 4 OR GO TO STEP 13 FOR INSTALLATIONS WITHOUT RAILCAPS.**

**4.**

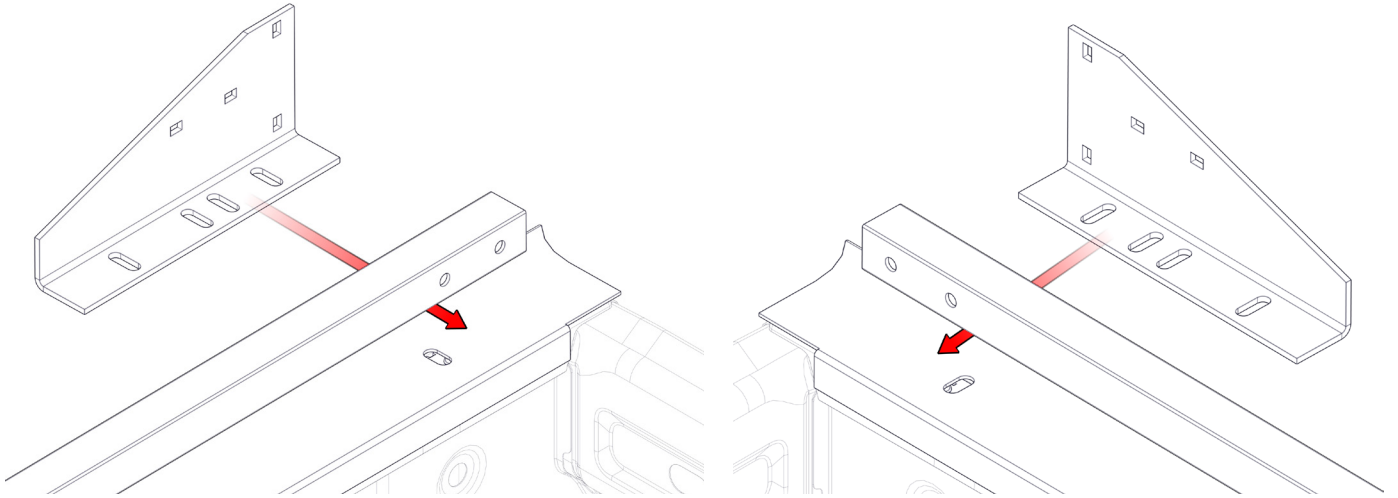

**5.**

3/8 X 1 3/4 Stainless Steel Counter Sink Bolt

3/8" Stainless Steel Finishing Washer

**X 2**  **X 2**

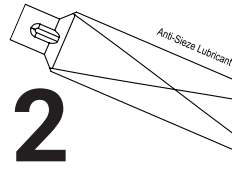

**APPLY ANTI-SIEZE**

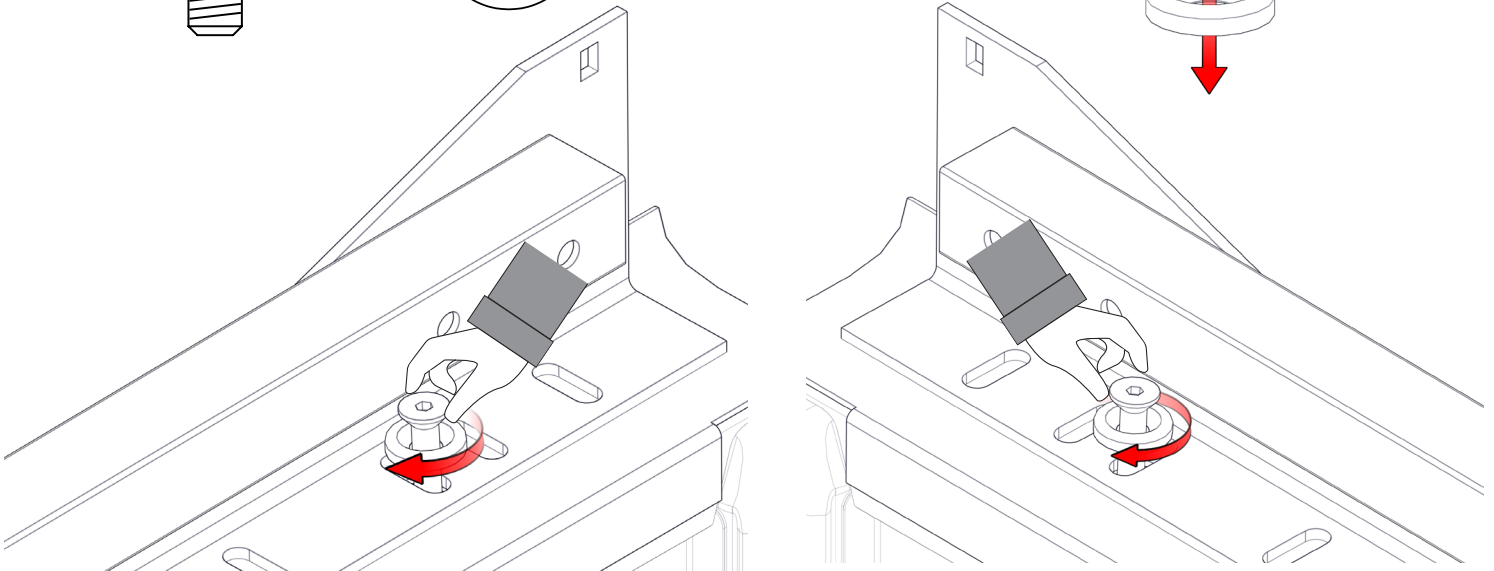
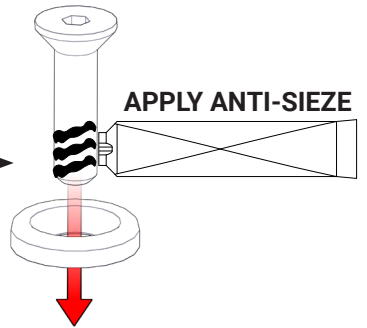

**6.**

**HARDWARE FOR STEP 6-7 IS INCLUDED WITH YOUR RAILCAPS.**

5/16 X 1-1/2 Stainless Steel Carriage Bolt

**X 4**

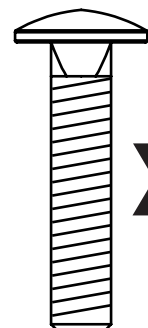

7.

5/16" X 5/8" Zinc Plated Camtainer Nut

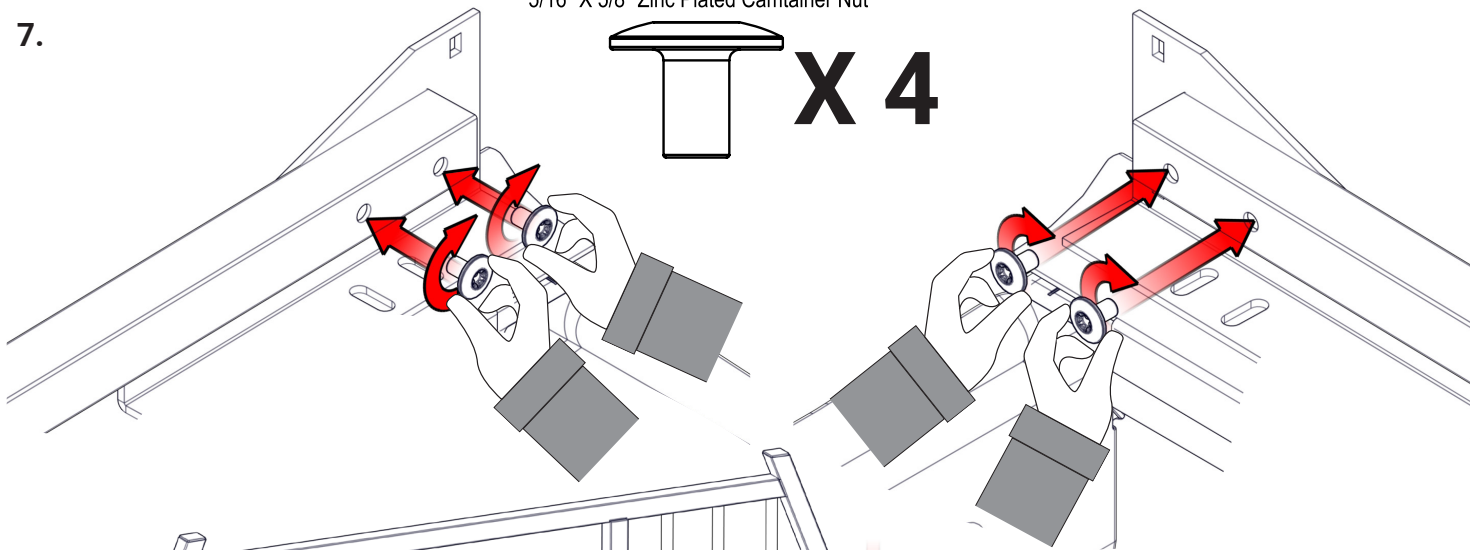

8.

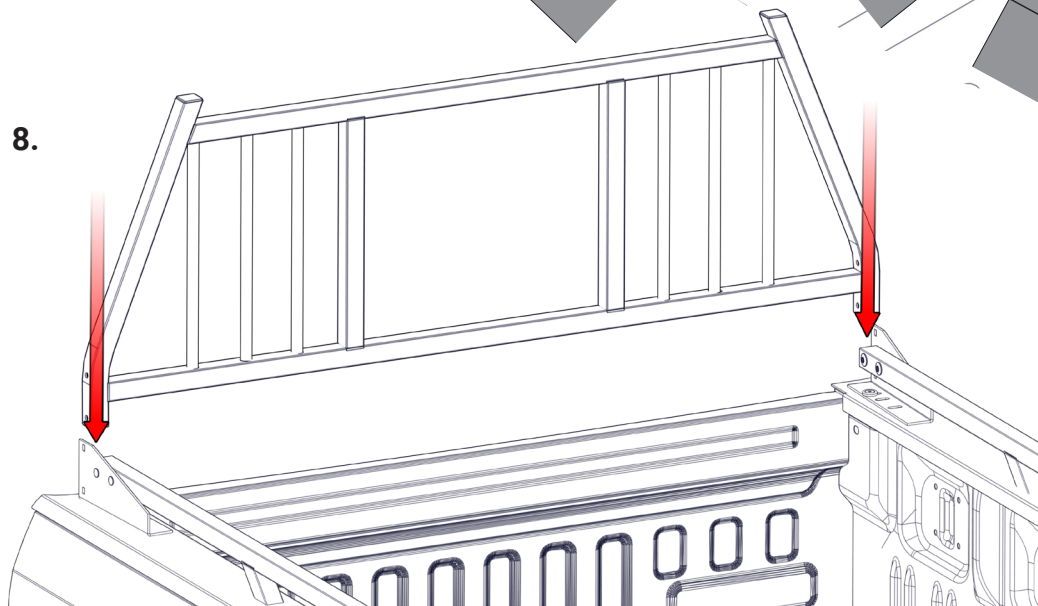

9.

5/16" X 5/8" Zinc Plated Camtainer Nut

5/16 X 1-1/2 Stainless Steel Carriage Bolt

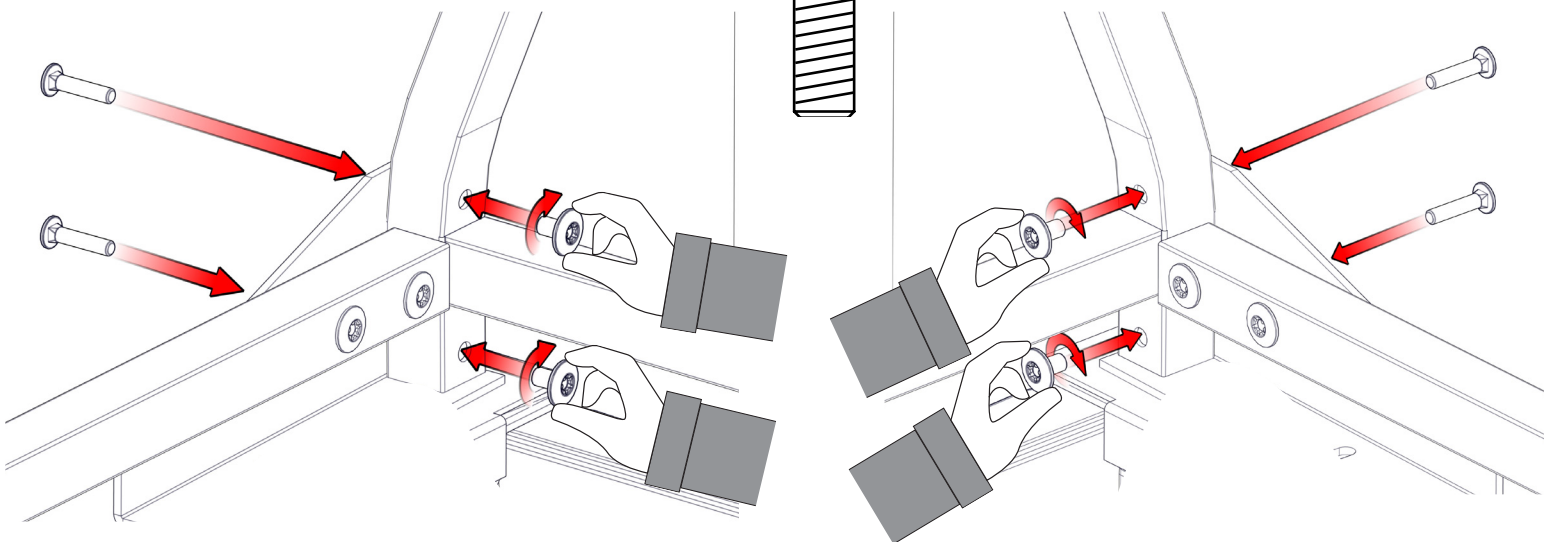
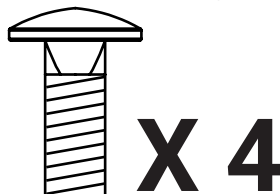

10. TORQUE =236 IN-LBF  
=19.5 FT-LBF

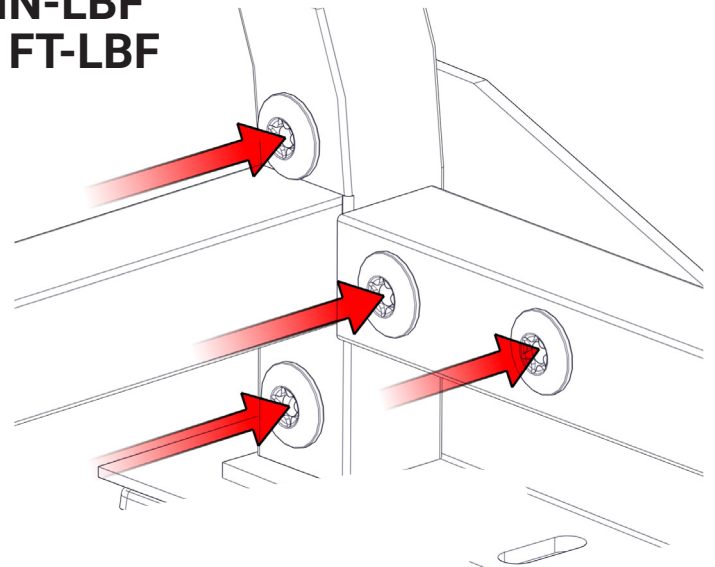
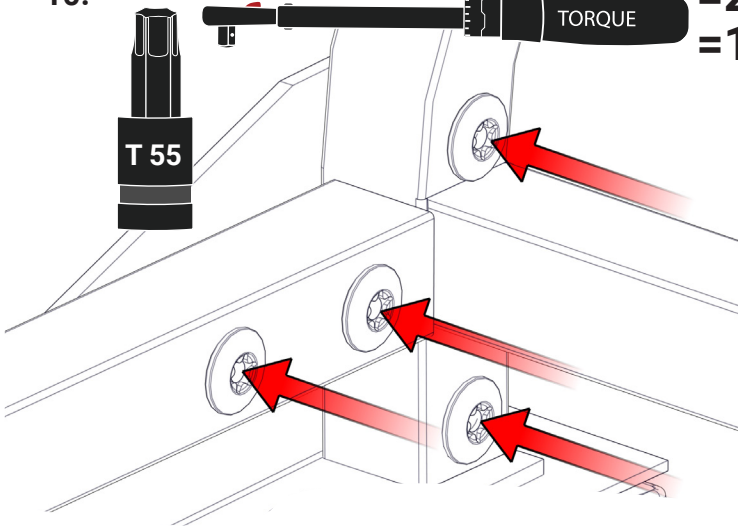

# 11. CENTER CAB GUARD ON TRUCK BOX.

12. TORQUE =90 IN-LBF  
=7.5 FT-LBF

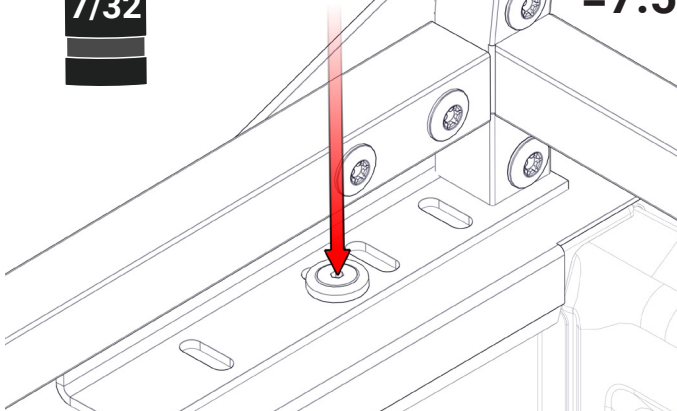

INSTALLATION OF CABGUARD WITH RAIL CAPS COMPLETE. SEE STEP 19 FOR LED CABGUARD WIRING PINOUT (IF EQUIPPED).

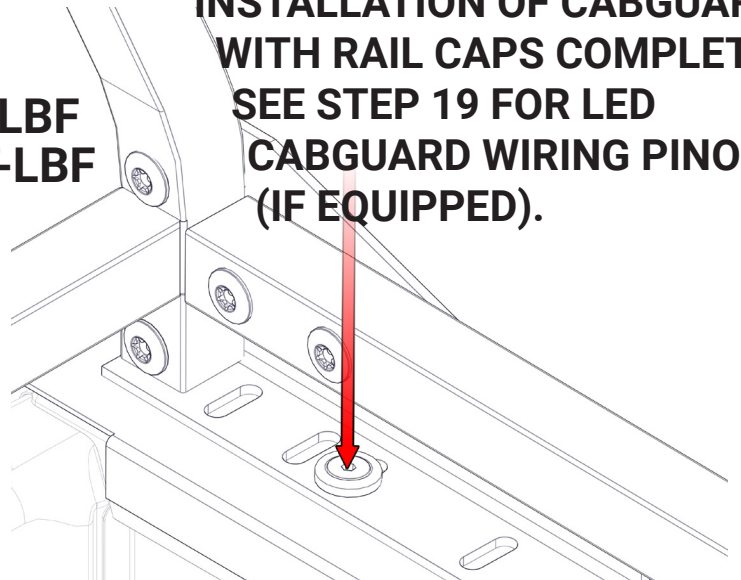

13.

3/8 X 13/4 Stainless Steel Counter Sink Bolt

3/8" Stainless Steel Finishing Washer

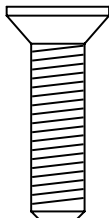

X 2

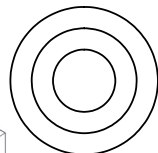

X 2

INSTALLATION WITHOUT RAILCAPS.

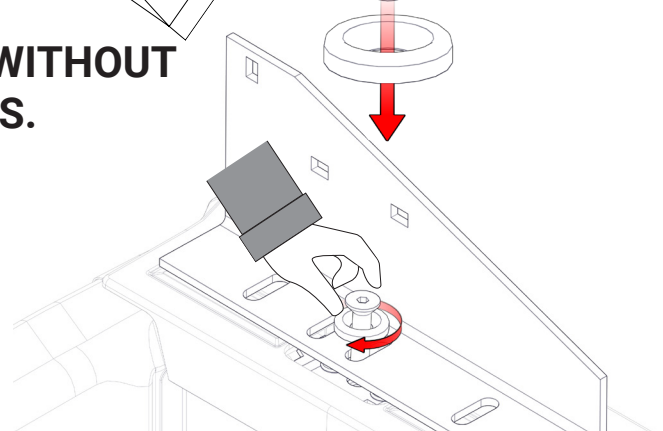
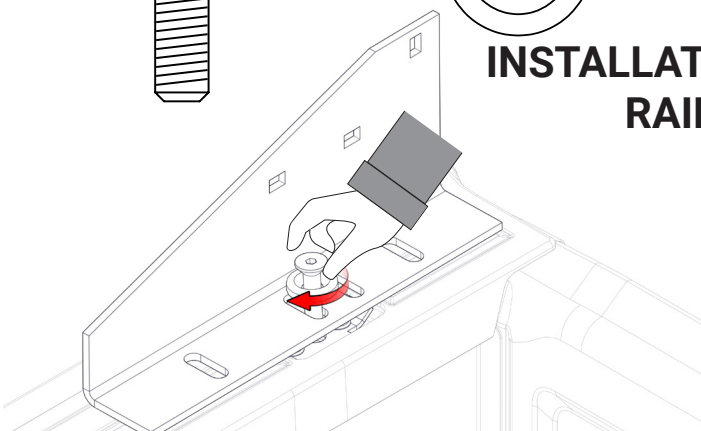
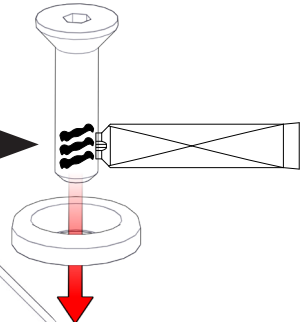
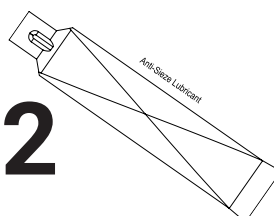

14.

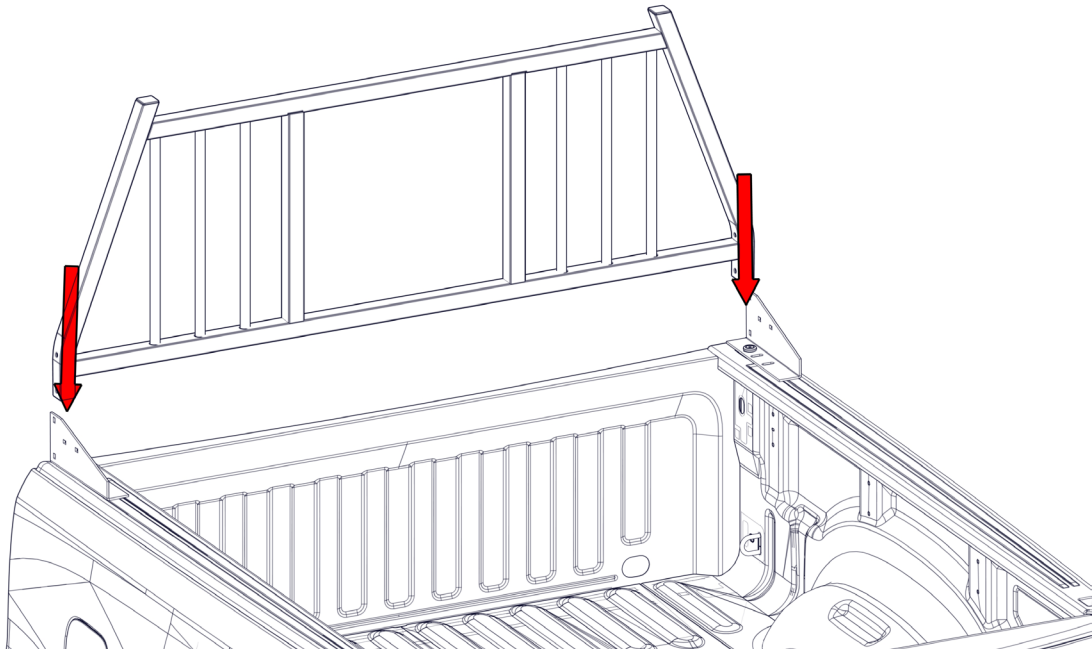

15.

5/16" X 5/8" Zinc Plated Camtainer Nut

5/16 X 1-1/2 Stainless Steel Carriage Bolt

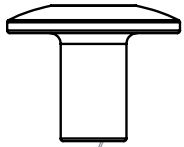

**X 4**

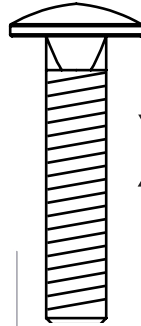

**X 4**

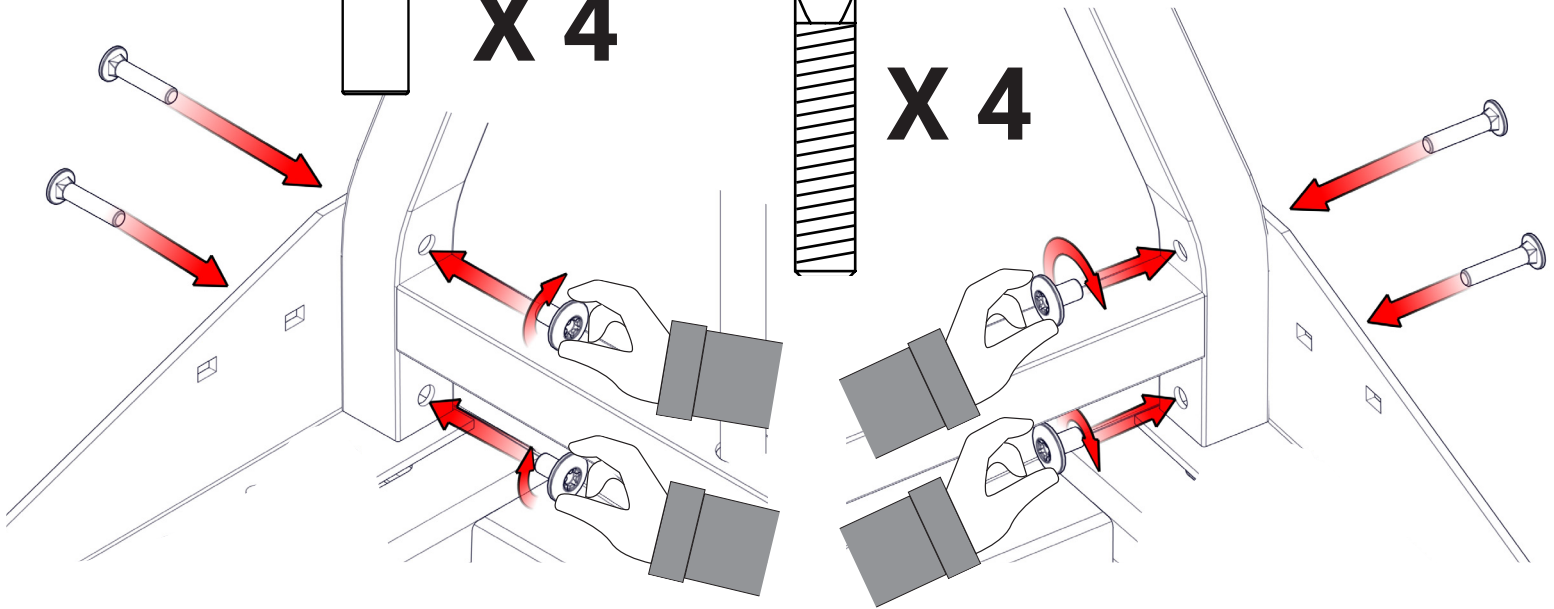

16.

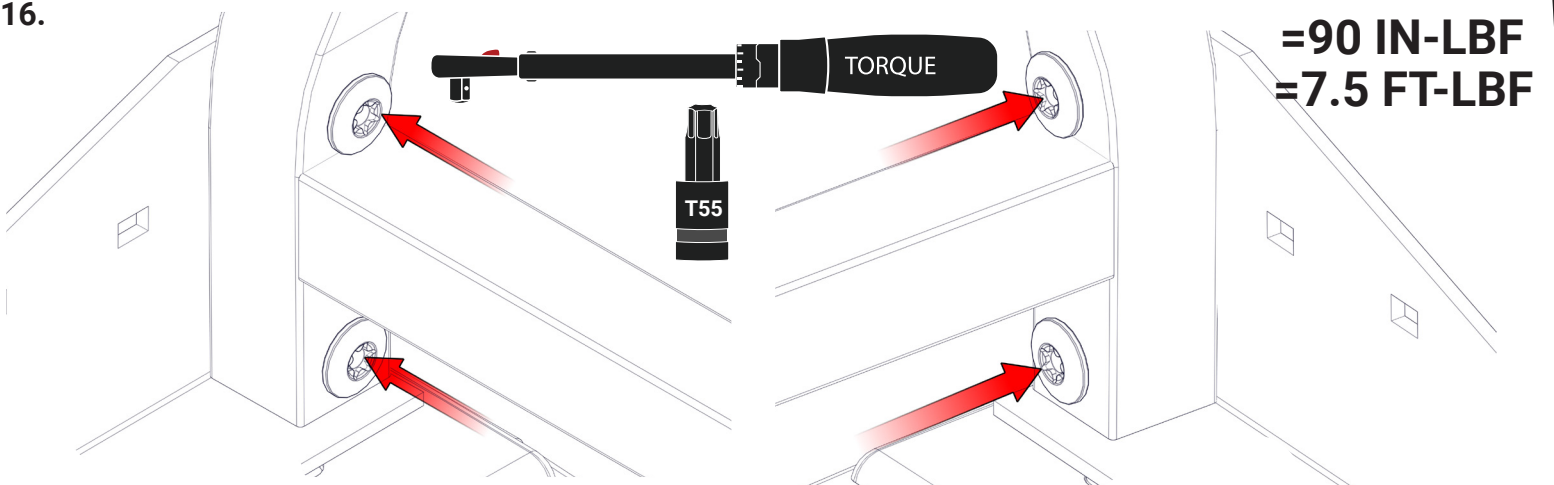



**17. CENTER CAB GUARD ON TRUCK BOX AND INSTALL A SECONDARY HOLD DOWN KIT.**

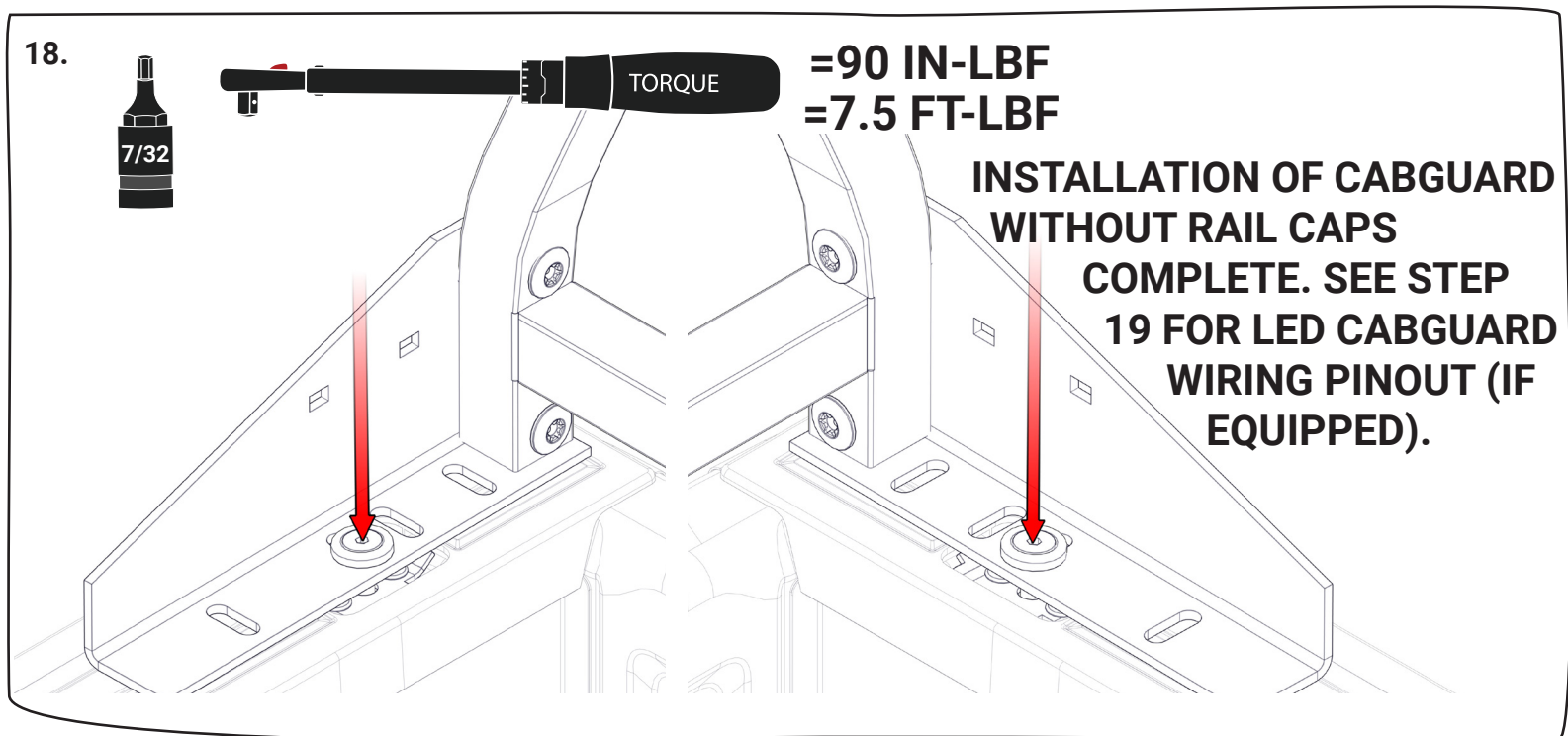

**19. IF YOUR INSTALLING A LED CABGUARD PLEASE REFER TO THE WIREING PINOUT BELOW.**

- **Red = Left Turn Signal**
- **Yellow = Right Turn Signal**
- **Black = Tail / Marker Lights**
- **Blue = Back Up Lights**
- **White = Chassis Ground**

PRINT OUT AT A 1:1 SACLE AND CUT OUT. FOLD ALONG DOTTED LINE.

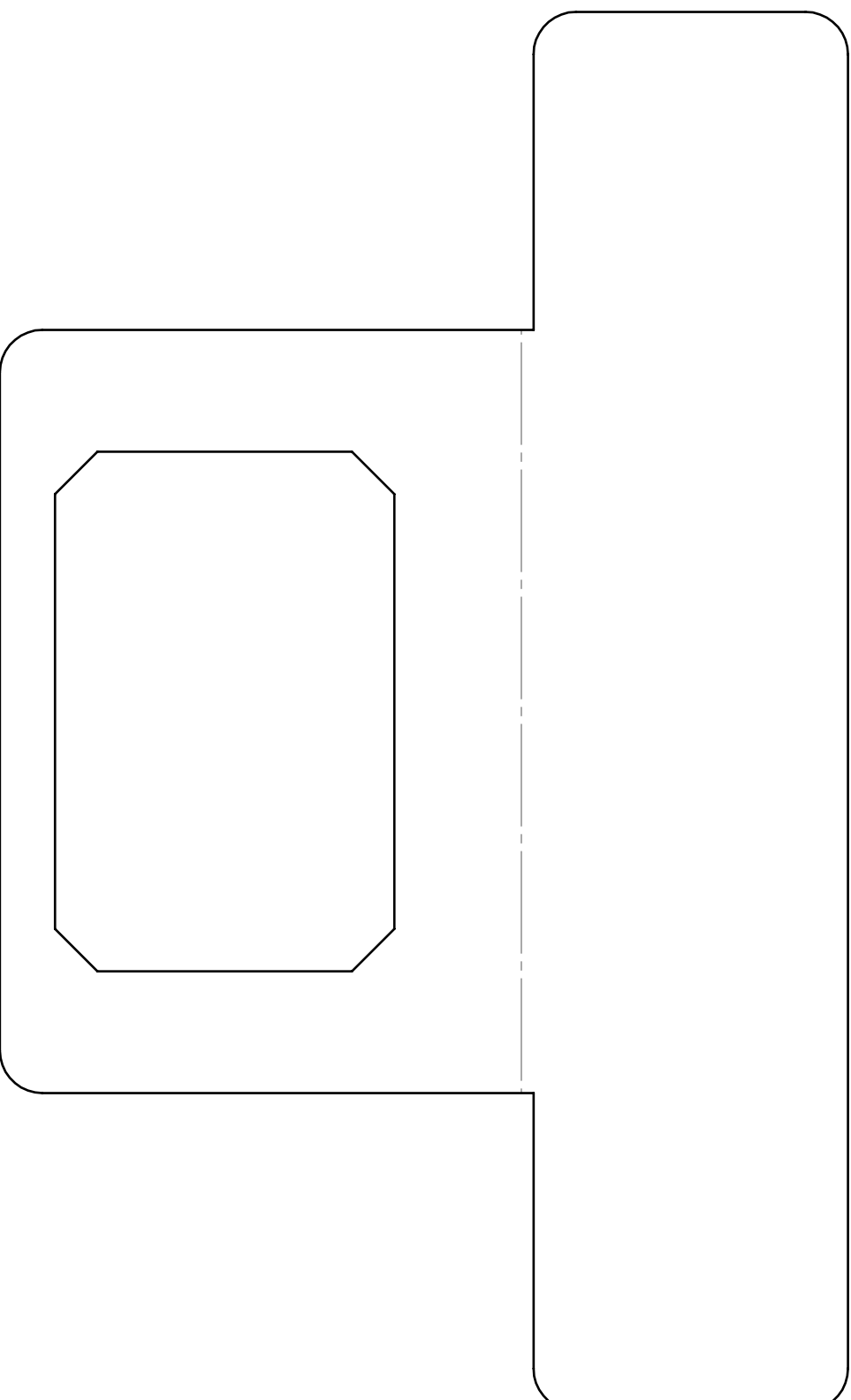

**WESTCAN** MANUFACTURING LTD.  
DESCRIPTION: Chevrolet front stake pocket cutout template

UNLESS OTHERWISE SPECIFIED, DIMENSIONS ARE IN INCHES		Rev:		
TOLERANCE		DRAWN BY: Dtrocher	MATERIAL:	Sheet 1 OF 1
ANG. FRAC.	.XX .XXX	DATE: 14/05/18	PART NR: 19+ Chevrolet front stakepocket cutout tem	
+ 0.5°	1/32" +0.015" +0.005"			

PROPRIETARY AND CONFIDENTIAL  
THE INFORMATION CONTAINED IN THIS  
DRAWING IS THE SOLE PROPERTY OF  
WESTCAN MANUFACTURING LTD. ANY  
REPRODUCTION IN PART OR AS A WHOLE  
WITHOUT THE WRITTEN PERMISSION OF  
WESTCAN MANUFACTURING LTD IS  
PROHIBITED.