

INSTALLATION INSTRUCTIONS: 2020+ HD SILVERADO/SIERRA OVER CANOPY RACK BRACKET GUIDE

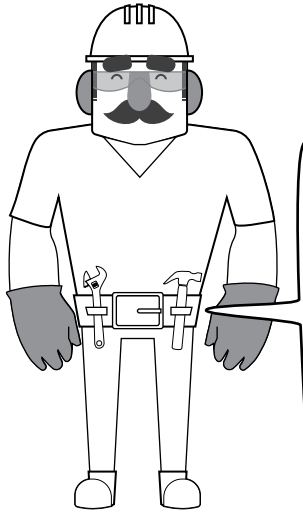

TOOLS NEEDED:

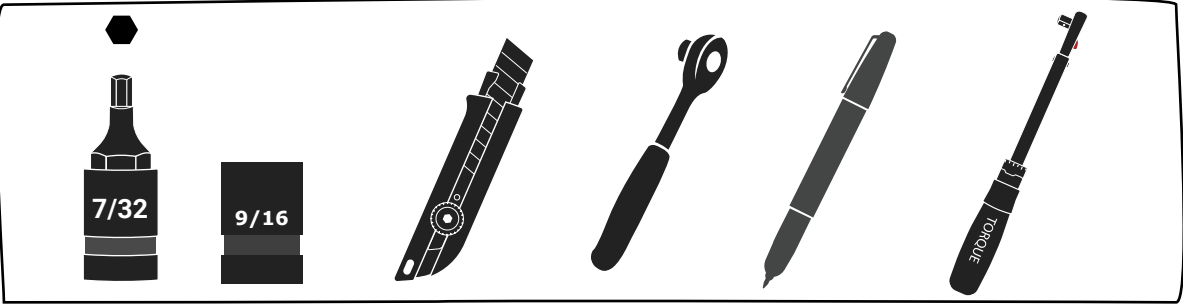

CAUTION:

This equipment is designed to be professionally installed by an approved up-fitter. Always wear ear and eye protection and exercise caution when installing Westcan products.

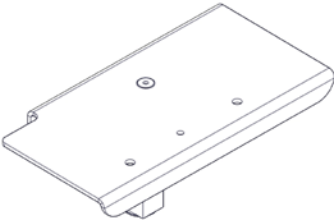
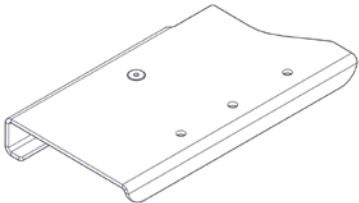
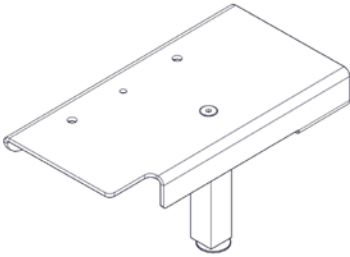
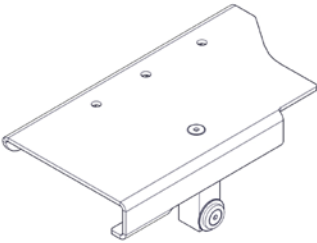

PREPARATION:

1. Ensure all parts are present and accounted for before installation. **Install the over canopy rack base plates on you vehicle before starting the assembly of your over canopy rack.** Plan the location of your installation ahead of time and make sure your installation location does not impede any other components you are installing or damage the safety and functionality of your vehicle.
2. Exercise extreme diligence when drilling holes into a motor vehicle. Increasing complexity and model year changes can alter the location of fuel, hydraulic and electrical lines. Please visually inspect all locations prior to drilling.
3. Re-Torque the 3/8" x 1-3/4" Stainless Steel Countersink Bolt every 3 months.
4. Images used illustrate a typical installation. The parts in your specific installation may appear different but the installation procedure remains the same.
5. If equipped, remove the truck canopy prior to installation. You may be required to relief cut the canopy skirt around the installation brackets for proper canopy fit. If desired, install canopy seal tape on the bottom of the cap to help keep rain or water out of the truck box (not supplied). Remember to also install extra canopy seal along the front of the canopy because it will sit off of the box of the truck Once the cap is between the canopy and the truck box.

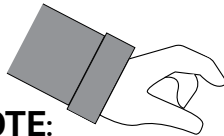

NOTE:

WHEN THE HOLD ICON IS USED TO TURN A FASTENER, ONLY TIGHTEN THEM FINGER TIGHT. THE FASTENERS WILL BE FULLY TIGHTENED IN LATER STEPS

1. REMOVE THE FRONT STAKE POCKET COVERS TO EXPOSE THE STAKE POCKETS.

2. FRONT STAKE POCKET INSERTS

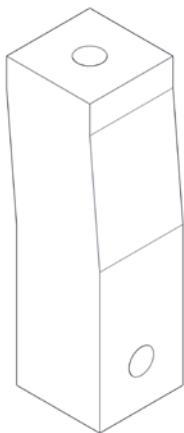

X 2

OCR BASE PLATES

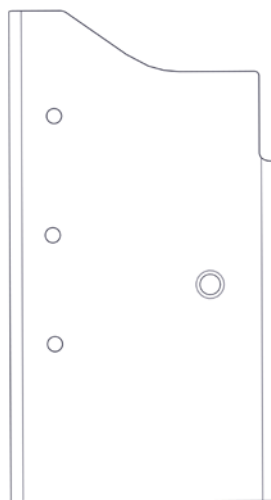

DRIVERS SIDE

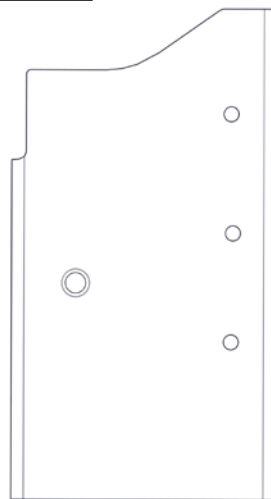

PASSENGER SIDE

REAR STAKE POCKET INSERTS



X 2

OCR BASE PLATES

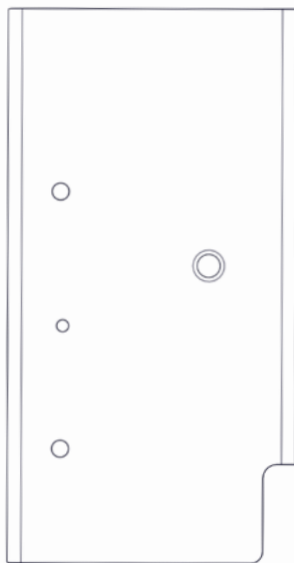

DRIVERS SIDE

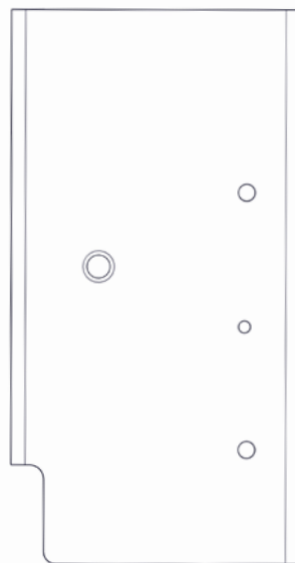

PASSENGER SIDE

3.

REQUIRED FOR FRONT STAKE POCKETS

3/8 X 1 1/2 Stainless Steel Counter Sink Bolt

3/8" Stainless Steel Fender Washer

3/8" Stainless Steel Finishing Washer

Front Stake Pocket Inserts

3.1

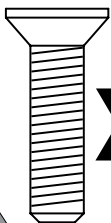

X 4

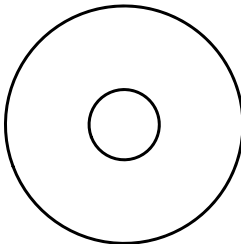

X 2

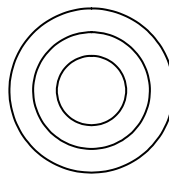

X 2



X 2

3.4

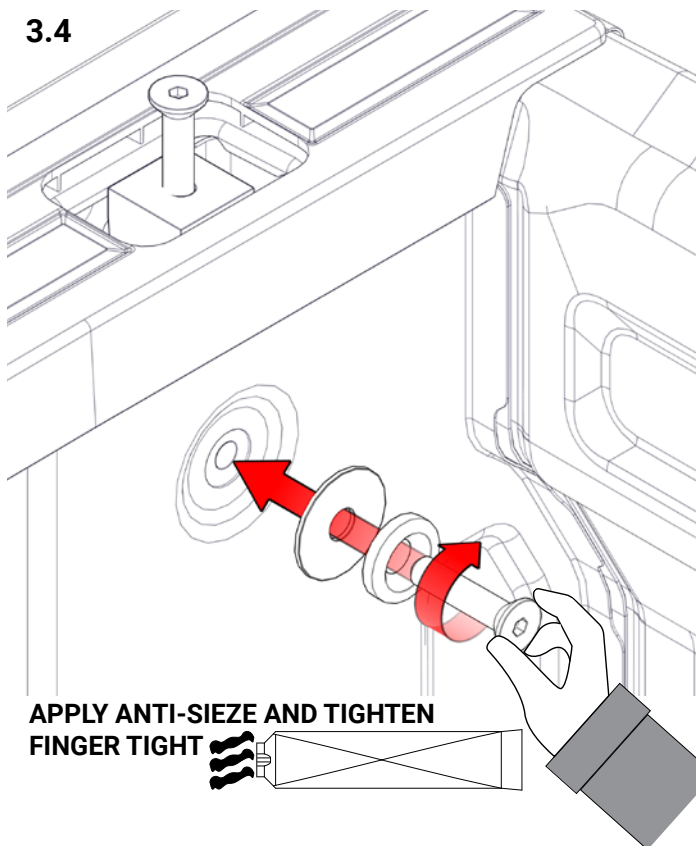

3.5

**REMOVE
COUNTER SINK
BOLT AND RETAIN.
REPEAT FOR
PASSENGER
SIDE**

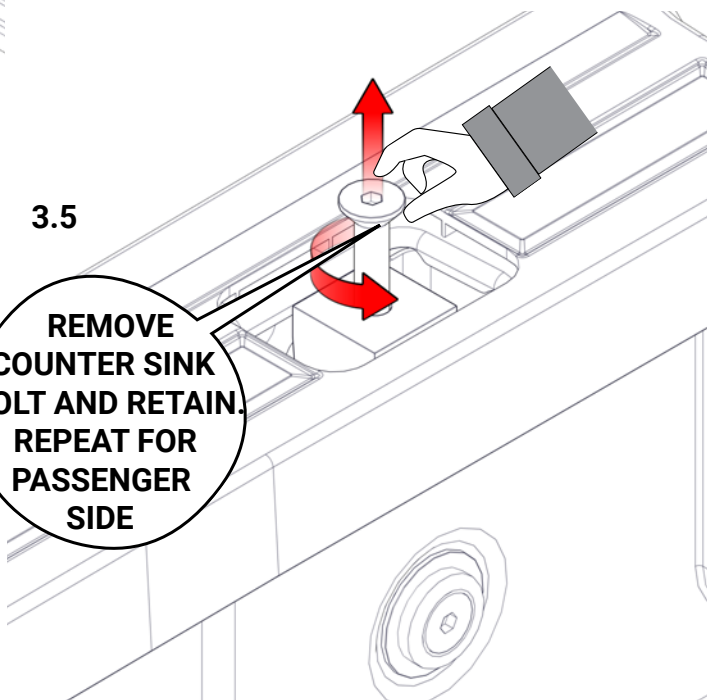

3.3

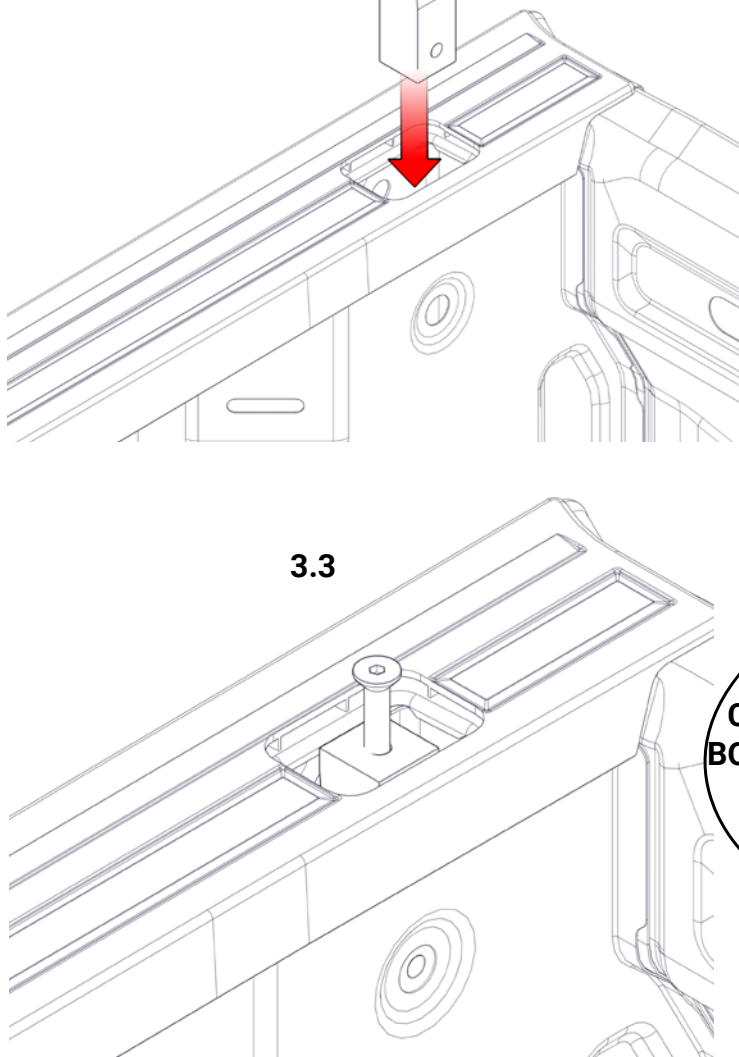

REQUIRED FOR REAR STAKE POCKETS

4.

3/8" x 1 1/4" Stainless Steel Hex Bolt

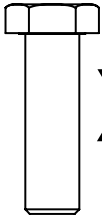

X 2

3/8" Stainless Steel Lock Washer

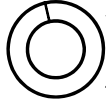

X 2

3/8" Stainless Steel Flat Washer

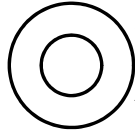

X 2

Rear Stake Pocket Inserts



X 2

**4.1
REMOVE TAILLIGHT
HOUSING FOLLOWING
VEHICLE MANUFACTURERS
GUIDELINES.**

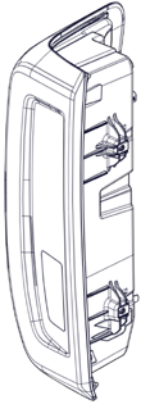

4.3

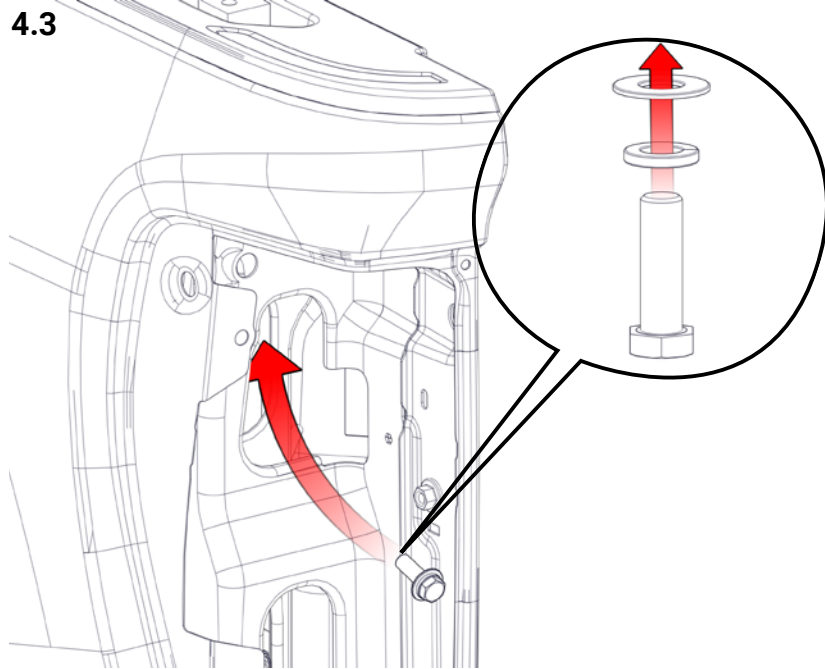

4.2

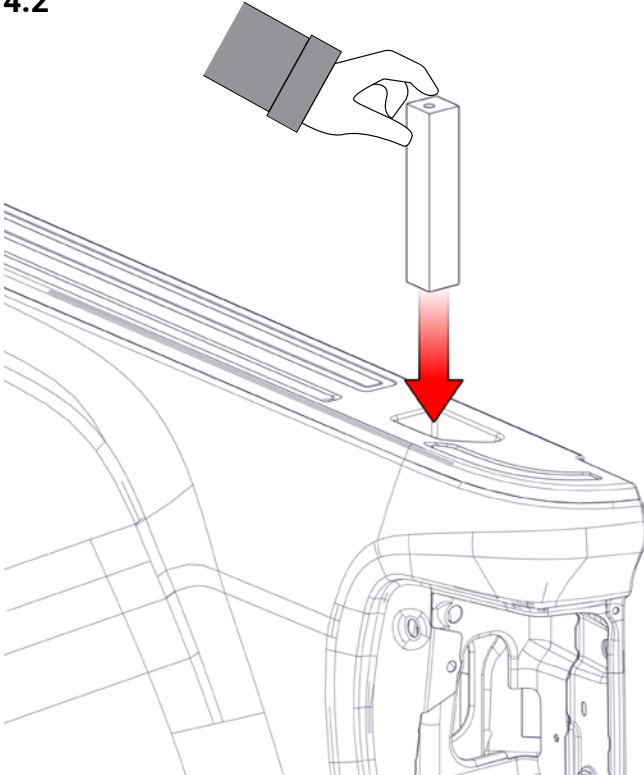

4.4

**APPLY ANTI-SIEZE AND TIGHTEN
FINGER TIGHT. REPEAT FOR
PASSENGER SIDE**

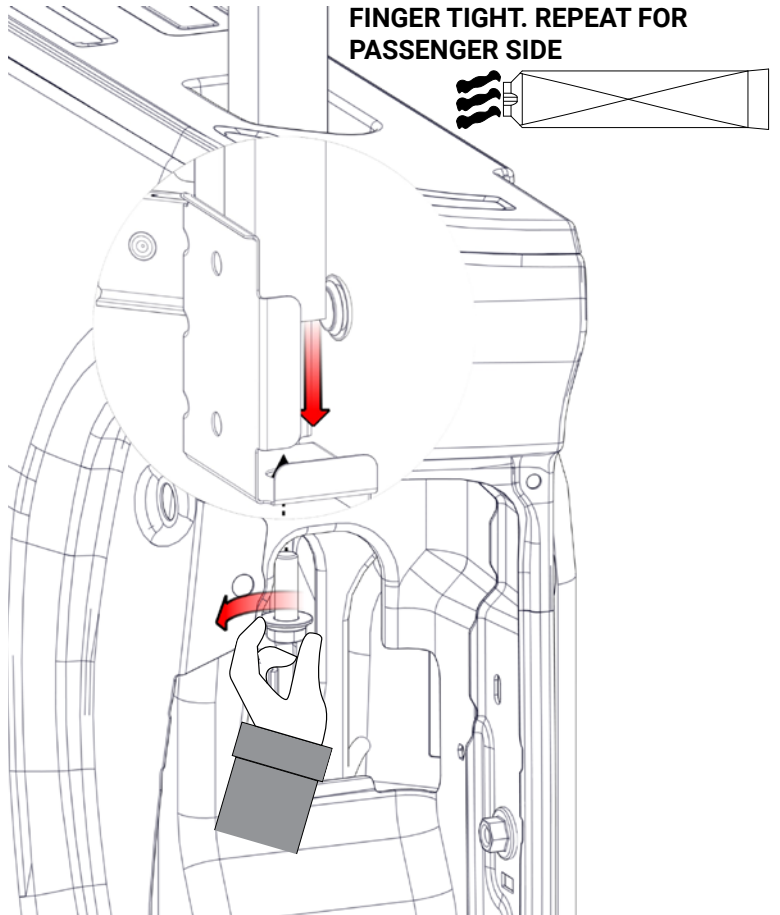

5.

FRONT OCR BASE PLATE INSTALLATION

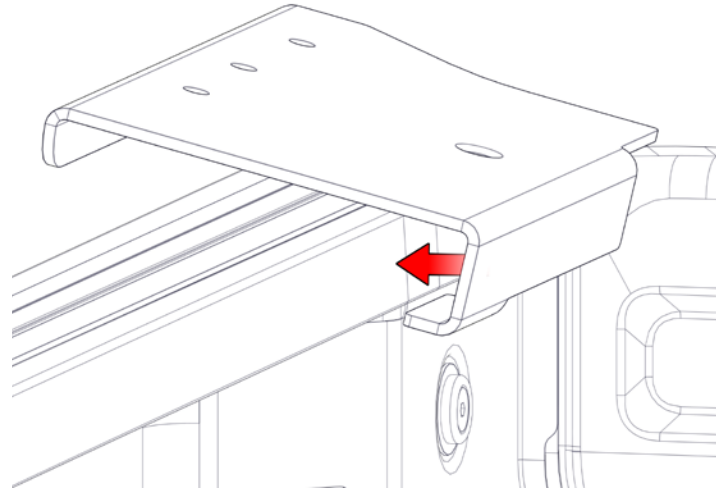
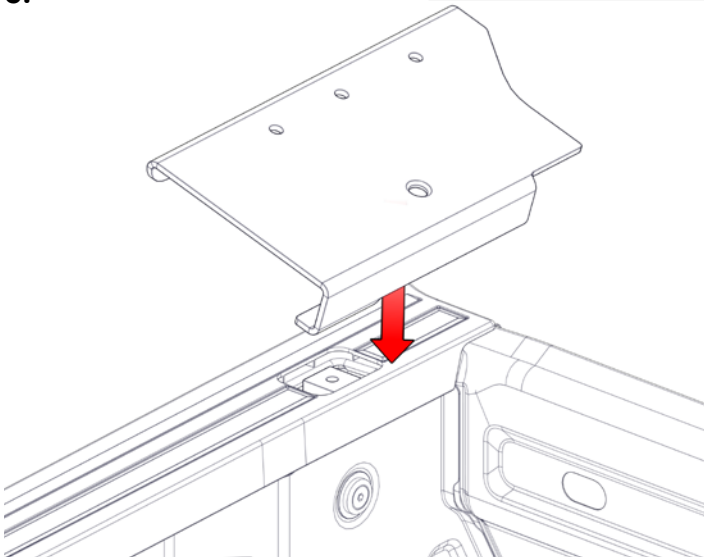

6.

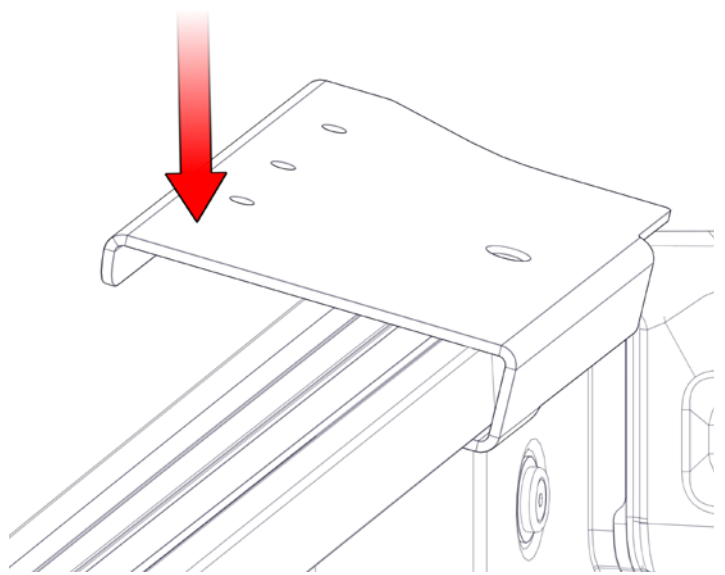
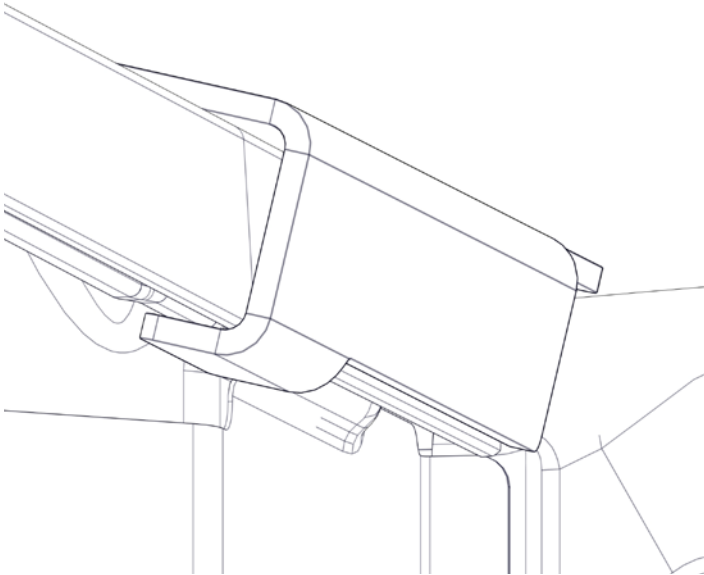

7.

3/8 X 1 1/2 Stainless Steel Counter Sink Bolt

APPLY ANTI-SIEZE

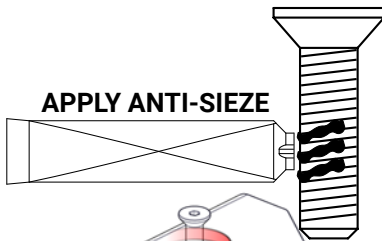

=25 FT-LBF

REPEAT STEPS 5-7
FOR PASSENGER SIDE
OCR BASEPLATE

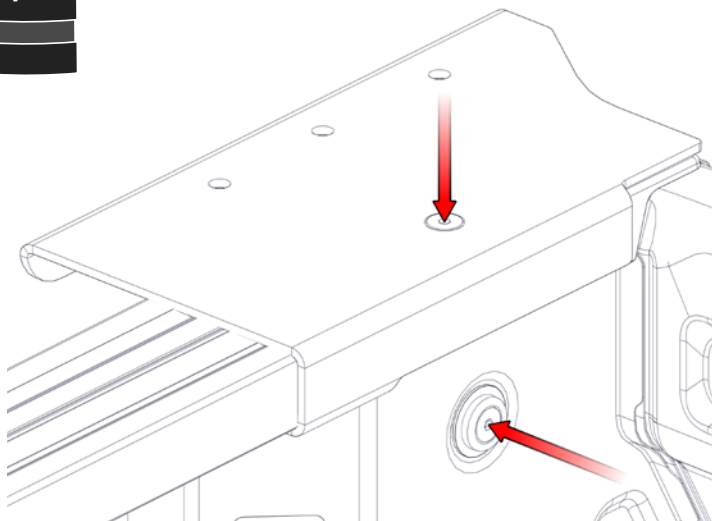
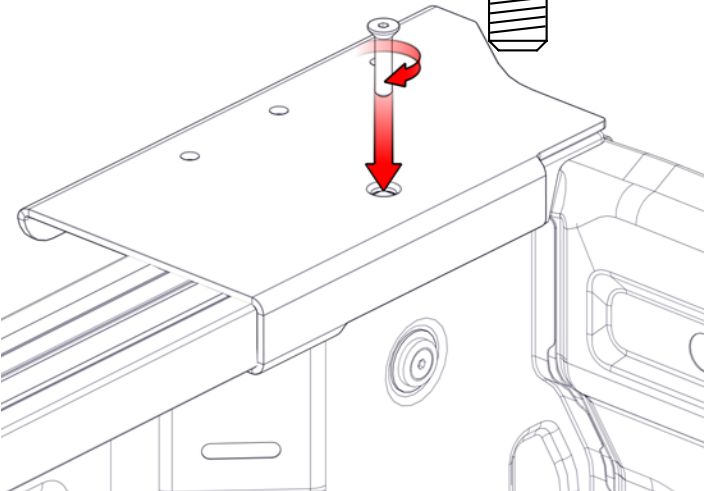

8.

REAR OCR BASE PLATE INSTALLATION

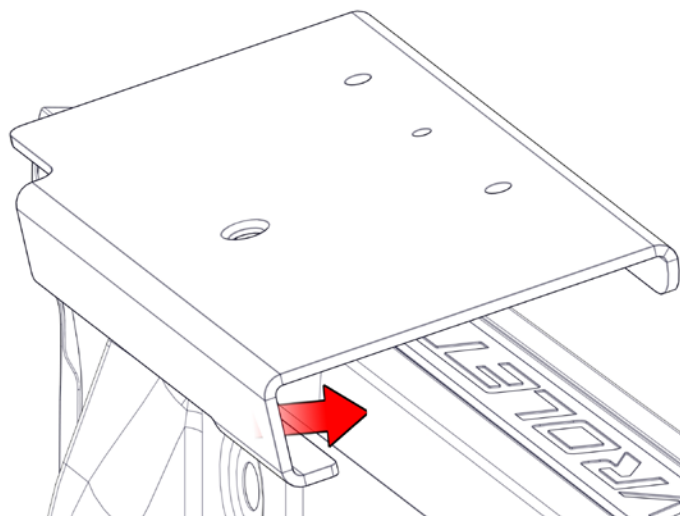
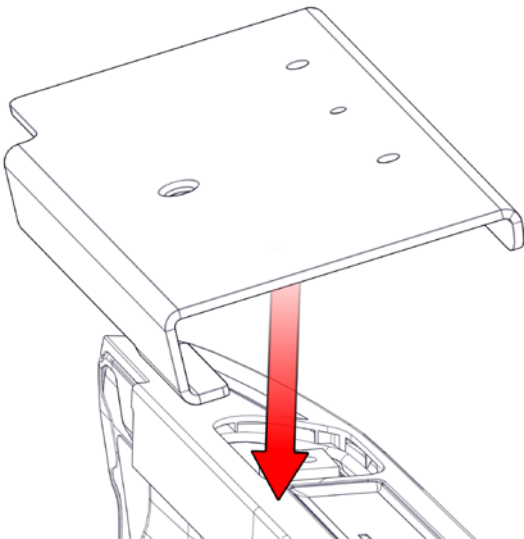

9.

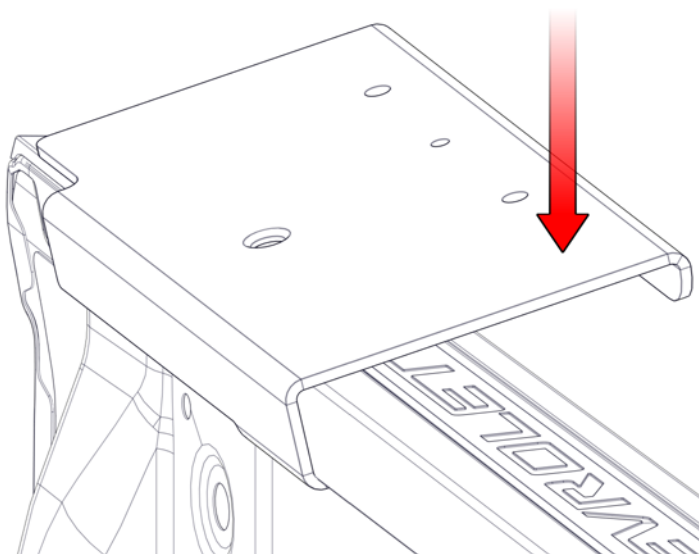
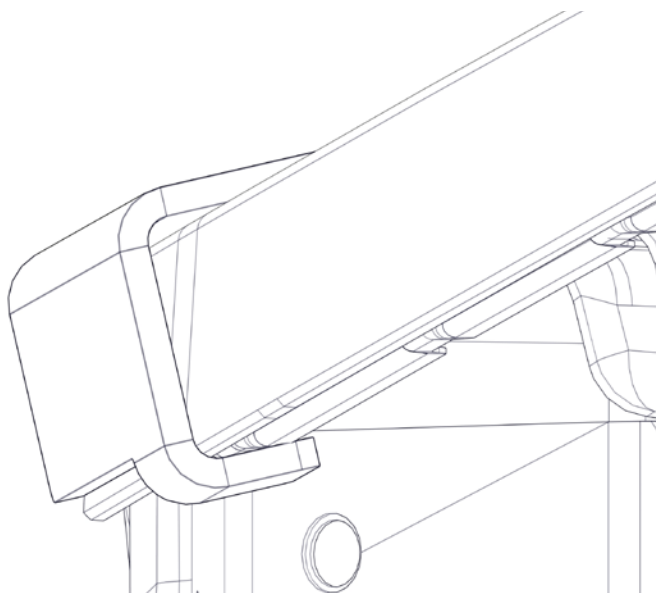

10.

3/8 X 1 1/2 Stainless Steel Counter Sink Bolt

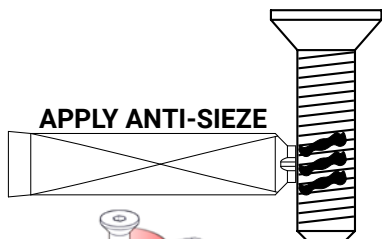

APPLY ANTI-SIEZE

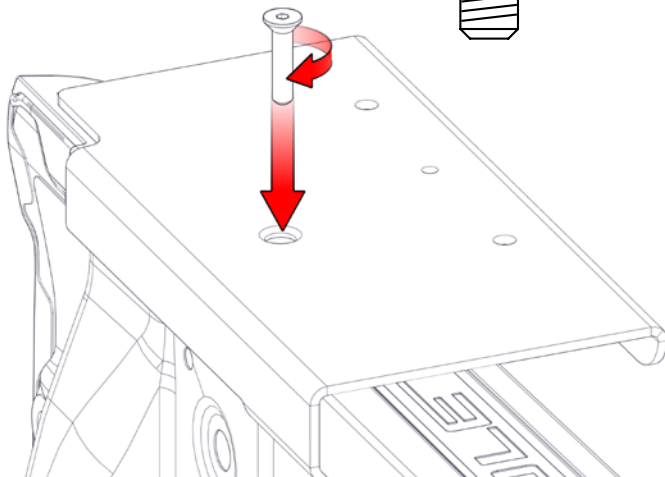

TORQUE

=25 FT-LBF

REPEAT STEPS 8-10
FOR PASSENGER SIDE
OCR BASEPLATE

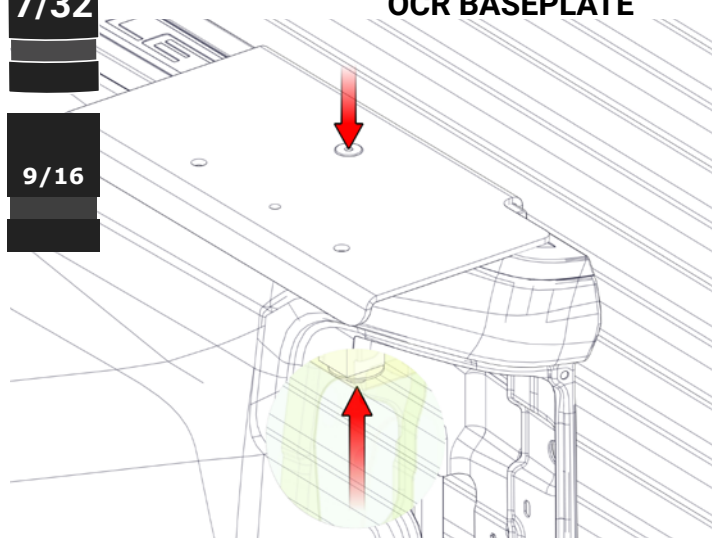

- 11. RE-INSTALL REAR DRIVERS AND PASSENGERS
SIDE TAILLIGHT HOUSING FOLLOWING VEHICLE
MANUFACTURERS GUIDELINES.**

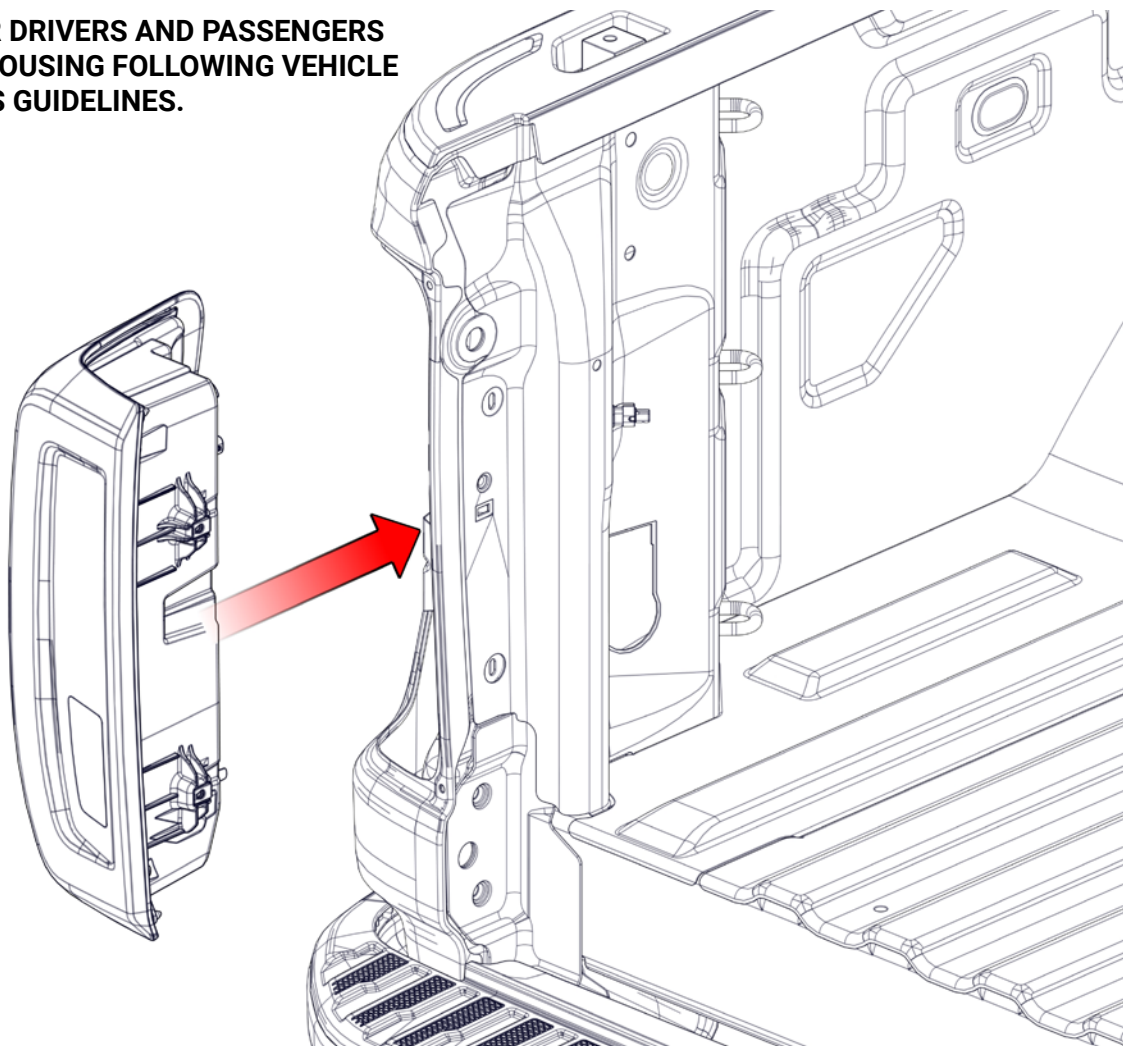

**IF YOUR INSTALLATION IS OVER A TRUCK BOX CANOPY, INSTALL THE CANOPY
FIRST THEN INSTALL THE RACK. YOU MAY BE REQUIRED TO RELIEF CUT THE
CANOPY SKIRT AROUND THE INSTALLATION BRACKETS.**

2020+ HD SILVERADO/SIERRA OCR SPACING GUIDE

LONG BOX FORWARD BAR SPACING

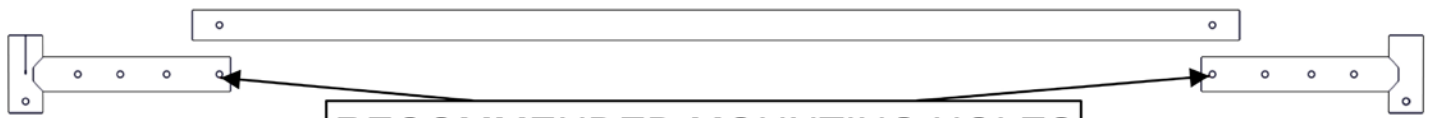

RECOMMENDED MOUNTING HOLES

SHORT BOX FORWARD BAR SPACING



RECOMMENDED MOUNTING HOLES

6-1/2" ABOVE CAB HEIGHT LEG MOUNTING HOLES

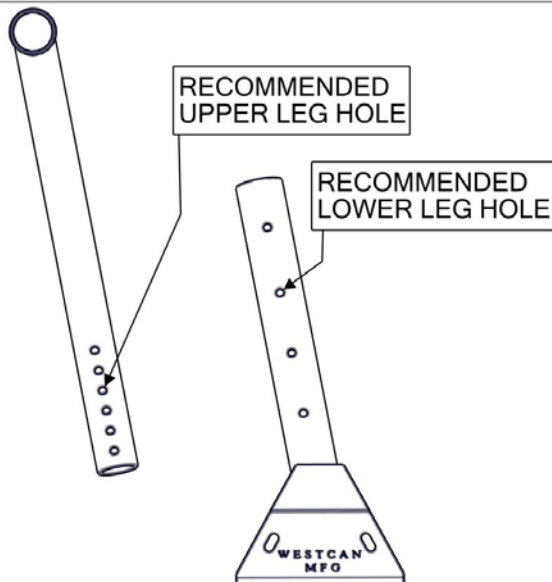

2-5/8" ABOVE CAB HEIGHT LEG MOUNTING HOLES

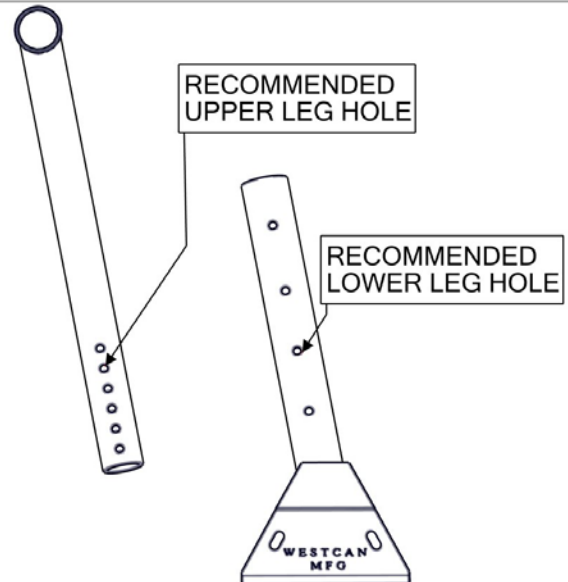

FRONT CROSS BAR RECOMMENDED HOLE FOR 2-5/8" ABOVE CAB HEIGHT



FRONT CROSS BAR RECOMMENDED HOLE FOR 6-1/2" ABOVE CAB HEIGHT



REAR CROSS BAR RECOMMENDED HOLE FOR 2-5/8" ABOVE CAB HEIGHT



REAR CROSS BAR RECOMMENDED HOLE FOR 6-1/2" ABOVE CAB HEIGHT